

# HISTORIC RESOURCES INVENTORY

Ser. No. _____	
HABS _____	HAER _____
Loc _____ SHL No. _____ NR Status _____	
UTM: A _____	C _____
B _____	D _____

## IDENTIFICATION

1. Common name: \_\_\_\_\_
2. Historic name: Frank S. Myers Residence
3. Street or rural address: 15 Los Laureles  
City Salinas Zip 93901 County Monterey
4. Parcel number: 002-513-04
5. Present Owner: Deon Kantro Address: Same as above  
City Salinas Zip 93901 Ownership is: Public \_\_\_\_\_ Private X
6. Present Use: Residence Original use: Residence

## DESCRIPTION

- 7a. Architectural style: Spanish Eclectic
- 7b. Briefly describe the present *physical appearance* of the site or structure and describe any major alterations from its original condition:

A two story wood framed residence with one story wing projections irregular in plan. The exterior wall caldding is a smooth cement stucco. The varying roof forms of this building, stepped and radiating, almost suggest a small Spanish village. All are covered with mission tile, including the gable roof of the miniature house atop the elaborate eave wall chimney on the one-story southern wing of the facade. The entry in the two story main block is through a deeply recessed segmental arch surmounted by the corbelling and bracketing of a partial overhang. The large hexagonal feature to the north behind the gabled two bay garage houses an interior staircase. Fenestration is curiously uniform given the complex plan of the house with multi-pane outward opening metal industrial casement windows of varying sizes. Some windows have enriched three panel wood shutters. Ornamental wrought iron lights flank the main entry. A large formal garden lies to the south enclosed in an inappropriately desinged pieced concrete block wall.

8. Construction date:  
Estimated 1935 Factual \_\_\_\_\_
9. Architect \_\_\_\_\_
10. Builder \_\_\_\_\_
11. Approx. property size (in feet)  
Frontage 150' Depth 130'  
or approx. acreage \_\_\_\_\_
12. Date(s) of enclosed photograph(s)  
1985; 1989



13. Condition: Excellent ☒ Good \_\_\_\_\_ Fair \_\_\_\_\_ Deteriorated \_\_\_\_\_ No longer in existence \_\_\_\_\_

4. Alterations: \_\_\_\_\_

15. Surroundings: (Check more than one if necessary) Open land \_\_\_\_\_ Scattered buildings \_\_\_\_\_ Densely built-up \_\_\_\_\_  
Residential ☒ Industrial \_\_\_\_\_ Commercial \_\_\_\_\_ Other: \_\_\_\_\_

16. Threats to site: None known ☒ Private development \_\_\_\_\_ Zoning \_\_\_\_\_ Vandalism \_\_\_\_\_  
Public Works project \_\_\_\_\_ Other: \_\_\_\_\_

17. Is the structure: On its original site? ☒ Moved? \_\_\_\_\_ Unknown? \_\_\_\_\_

18. Related features: \_\_\_\_\_

#### SIGNIFICANCE

19. Briefly state historical and/or architectural importance (include dates, events, and persons associated with the site.)

The largest and most elaborate of the Spanish Revival residences in Salinas. In spite of an inappropriate modern pierced concrete brick wall around the formal garden, this building retains much of its integrity as constructed sometime between 1933 and 1937. Maple Park was the first Salinas residential subdivision to employ **Garden City** planning concepts in its layout with meandering streets, underground utilities, wide setbacks and extensive landscaping. It soon became a city show place and model for later residential development in the rapidly expanding district. Frank S. Myers was a Salinas manufacturer. The building clearly qualifies as a Salinas historic resource and contributing feature of the Maple Park historic district under Criterion 3,e,f,j,m and probably g.

20. Main theme of the historic resource: (If more than one is checked, number in order of importance.)

Architecture ☒ Arts & Leisure \_\_\_\_\_  
Economic/Industrial \_\_\_\_\_ Exploration/Settlement \_\_\_\_\_  
Government \_\_\_\_\_ Military \_\_\_\_\_  
Religion \_\_\_\_\_ Social/Education \_\_\_\_\_

21. Sources (List books, documents, surveys, personal interviews and their dates).

Polk's Directory for Salinas, 1937  
Salinas subdivision maps

22. Date form prepared MAY 25 1986  
By (name) Rene L. Seavey  
Organization \_\_\_\_\_  
Address: MONTEREY COUNTY  
City HISTORICAL SOCIETY  
Phone: P. O. Box 3576  
Salinas, Ca 92012

15 Los Laureles

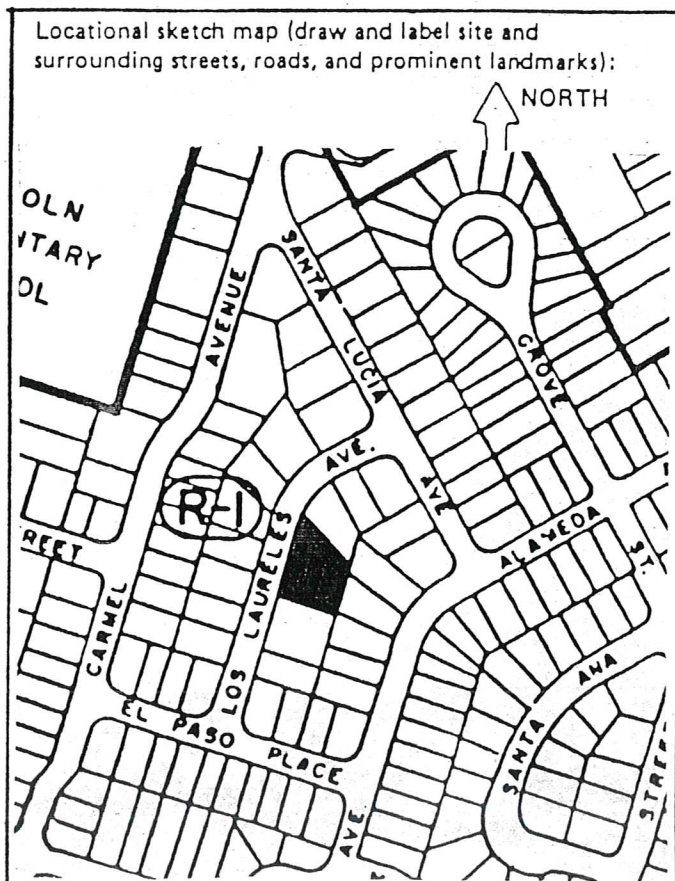

## **Character-defining Features**

15 Los Laureles Avenue

Character-defining features include irregular plan; one-and-two-story height; smooth cement stucco exterior wall-cladding; stepped and radiating low-pitched gable roofs capped with Mission tile and tile vents in the gable-ends; large stucco-clad exterior eave wall chimney facing Las Laureles with a highly decorative pierced spark arrester in the form of a gabled house, with a tiled roof; Recessed central entry facing Las Laureles flanked by original (?) period cast-iron lighting fixtures; surmounted by a large, stuccoed corbelled band; Fenestration composed of multi-paned, outward opening industrial steel casement windows; decorative wood shutters on second floor.