

ISTOBAL

FLEX5



Are you ready for a change?
It's just a matter of **flexibility**.

Your needs are our command. The effectiveness and reliability typical of the M'NEX range is now paralleled by the revolutionary FLEX5 rollover. The FLEX5 was developed and patented by ISTOBAL's R&D department for maximum versatility and no limits.

The FLEX5 can meet our customers' present and future needs because if needs change in your car wash facility, your car wash machine can change with them.



The First **Transformable** Rollover



3 BRUSH

Building upon our industry leading M'NEX range, we introduce the FLEX5. The 3 brush configuration is the standard by which others are measured, ensuring a clean car every time.



5 BRUSH

The FLEX5 platform allows an operator who needs additional speed to add 2 brushes to the 3 brush configuration. The additional brushes offer up to a 30% reduction in wash and dry times compared to a 3 brush machine alone.



HYBRID

By adding High Pressure to the machine, you can command a higher wash price and ensure complete satisfaction from your customers. Wash packages are customizable to allow some washes to have the HP option while others have only friction. Available with 3 or 5 brushes.



TOUCH FREE

Designed from our M'NEX 24 model, the FLEX5 Touch Free can be configured without brushes and provides a fully touch free wash. Using our contouring, rotating top and side oscillating high pressure will provide the industry's best level of touch free cleaning.



COMBO

The most versatile machine in the industry, the FLEX5 Combo. In this configuration, the FLEX5 can be 3 or 5 brushes with the same high pressure components used on the FLEX5 Touch Free. This will allow customers to choose the wash they want; friction, touch free, or a combination of both.



Standard Features

- 2 Year Parts Warranty
- Remote Screen Access
- Link-It Patented Washing Material
- Amp Sensing Brush Control
- Variable Speed - Any Pass
- Virtual Positioning
- 7" Programming Touch Screen
- Energy Efficient - All Electric

Optional Features

- Lighted Infinite Mousse
- Extended Height
- HP Wheel and Rocker vtBlaster
- Positioning by Voice
- Lighted Guide Rails
- On board Marketing Lights
- Multiple Dryer Styles
- Multiple High Pressure Options
- Brushed-In Wax Option

WASH DIMENSIONS

	3 BRUSH	5 BRUSH	3 BRUSH	5 BRUSH	TOUCH FREE*	
WASH HEIGHT	7'-6"		9'-6"		7'-6"	9'-6"
WASH WIDTH	8'-10"		8'-10"		8'-10"	8'-10"
RECOMMENDED BAY WIDTH	14'		14'		14'	14'
RECOMMENDED CEILING HEIGHT	11'-6"		13'-6"		11'-6"	13'-6"
HEIGHT OF MACHINE	10'-2"		12'-2"		10'-2"	12'-2"

*Machine height will increase if adding a Premier Dryer

ISTOBAL, USA

1100 Page Street
Bristol, Virginia 24201

T +1 800 336 8795

info.usa@istobal.com • www.istobal.com/usa



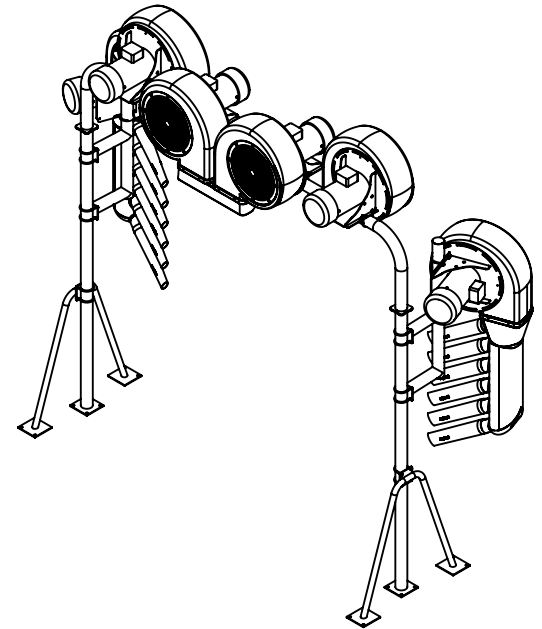
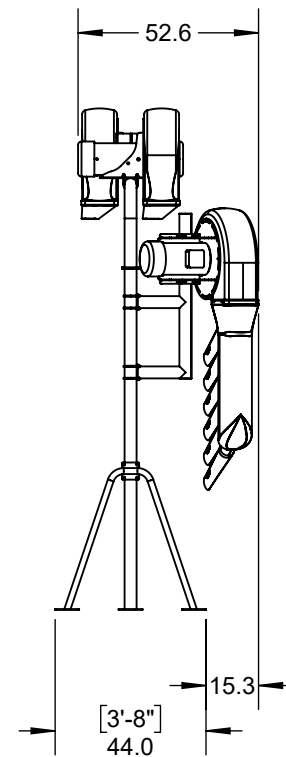
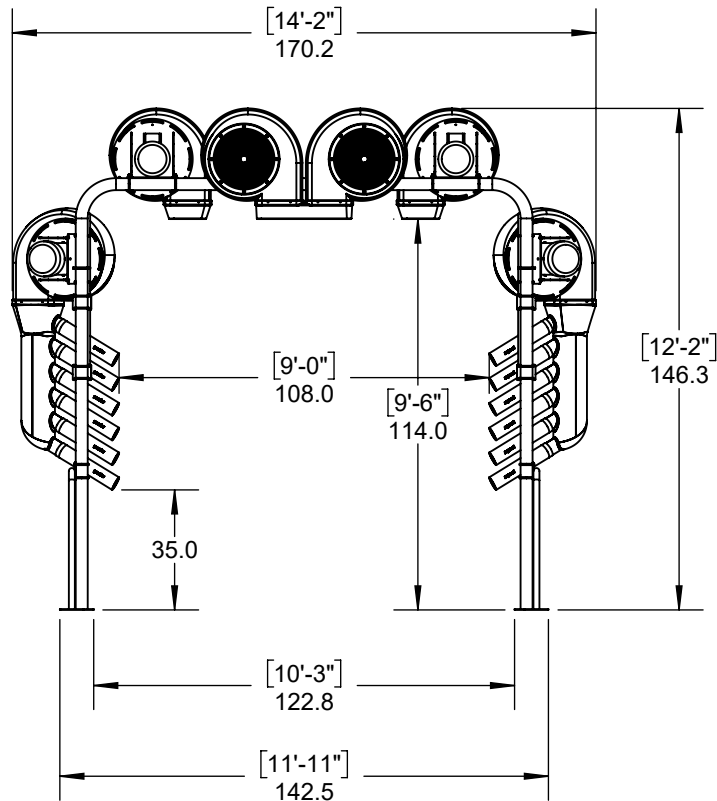
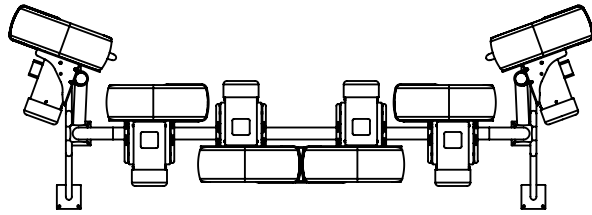

REVISIONS		
REV	DATE	DESCRIPTION
.	.	.
.	.	.
.	.	.
.	.	.



TOLERANCES:
UNLESS OTHERWISE
SPECIFIED:
FRACTIONAL = $\pm 1/32$
.X = ± 0.030
.XX = ± 0.015
.XXX = ± 0.005
ANGLES = $\pm 1^\circ$
DIMENSIONS ARE IN
INCHES

TITLE STD ARCH WITH 6 PRO, E-TRUNKS, DUAL NOZZLE		REV -
FINISH	DATE 10/19/2022	
MATERIAL	DRAWN TSL	
SCALE 1:56	P/N STD 6 PRO E-TWBKT DNZL (114in std parts)	SHEET 1 OF 1

Dryer Specifications:

DECIBEL READINGS / LEVELS: ALL READINGS MAY VARY WITH BAY TYPES, SURROUNDINGS AND VARIABLE TYPES OF CONSTRUCTIONS.

DISTANCE FROM BAY:	30HP EXIT DOOR CLOSED	30HP EXIT DOOR OPEN	60 HP (4-15HP, 2- TRUNKS)
10FT.	76	89	95
20FT.	72	87	89
30FT.	70	82	84
40FT.	66	78	79
50FT.	66	78	78
60FT.	64	75	76

*DECIBEL LEVELS MAY DROP 4 TO 5 DBA'S OR MORE WITH FULL COVER SURROUNDS OR SILENCER CONES. READINGS MAY VARY.

*THESE READINGS WERE CONCLUDED WITH PREMIER PLASTIC HOUSINGS. ALUMINUM HOUSINGS ARE ON THE AVERAGE OF 6 TO 8 DECIBELS LOUDER.



Over 100 years of experience

Since 1901 the Chicago Pneumatic name has represented high-performance tools and equipment designed for an extensive range of applications. Today, Chicago Pneumatic has a global reach, with local customer centers around the world. Chicago Pneumatic products are tailored to the needs of the industrial, vehicle service, and construction markets. Every day we develop and manufacture new products that are meant to meet your demands not only today, but tomorrow as well.

To learn more about our extensive range of tools, hydraulic attachments, industrial and portable compressors, accessories and workshop equipment, please visit www.cp.com.



CP compressors are supported by a network of trained service technicians who can provide complete warranty support, spare parts and technical consultation. For more information on our products, please contact your CP territory sales manager or a local authorized CP distributor.

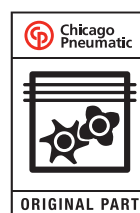

Original parts. Your quality assurance.

The “original part” identification confirms that these components passed our strict test criteria. All parts are designed to match the compressor. They have been thoroughly tested to obtain the highest level of protection, extending the compressors’ lifetime and keeping the cost of ownership to an absolute minimum. No compromises are made on reliability. The use of “original part” certified quality components helps ensure reliable operation and will not impact the validity of your warranty, unlike other parts. Look for the quality assurance seal.

DISTRIBUTED BY



The Compressed Air and Gas Institute, CAGI, is an organization dedicated to improving the compressed air industry through established standards. As a proud member of CAGI, CP Compressors publishes all technical data in accordance with CAGI/PNEUROP PN2CPTC2 guidelines and voluntarily allows products to be selected for participation in CAGI's Performance Verification Program. With CP Compressors, our customers know they are receiving the excellent performance that we publish.



CP Compressors
1800 Overview Drive
Rock Hill, SC 29730
1-877-861-CPAC (2722)

CP Compressors Canada
2900 Argentina Rd. Unit 13
Mississauga, Ontario L5N 7X9
1-800-513-3782



RCP Series

People. Passion. Performance.

www.cp.com

© 2012 Chicago Pneumatic. All Rights Reserved. Content is subject to change without notice. June 2012

Two Stage Electric Simplex											
Model	Part Number	HP	Tank gal.	Electrics Voltage/Phase	cfm @ displ.	cfm @ 100 psi	Recom. Dryer	Weight (lbs.)	L (in.)	W (in.)	H (in.)
RCP-561VNS	8090250617	5	60V	208-230/1	18.6	15.3	CPXHT-25	300	29	20	68
RCP-581VNS	8090250620	5	80V	208-230/1	18.6	15.3	CPXHT-25	382	39	24	73
RCP-381VS	8090250674	5	80V	208-230/1	22.4	18.5	CPXHT-25	457	39	24	77
RCP-381HS	8090250682	5	80H	208-230/1	22.4	18.5	CPXHT-25	491	71	24	49
RCP-338VS	8090250690	5	80V	208-230/3	22.4	18.5	CPXHT-25	457	39	24	77
RCP-338VS4	8090252795	5	80V	460/3	22.4	18.5	CPXHT-25	457	39	24	77
RCP-338HS	8090250716	5	80H	208-230/3	22.4	18.5	CPXHT-25	471	71	24	49
RCP-338HS4	8090252803	5	80H	460/3	22.4	18.5	CPXHT-25	471	71	24	49
RCP-581V	8090250619	5	80V	208-230/1	22.4	18.5	CPXHT-25	467	39	24	77
RCP-581H	8090250618	5	80H	208-230/1	22.4	18.5	CPXHT-25	501	71	24	49
RCP-583V	8090250623	5	80V	208-230/3	22.4	18.5	CPXHT-25	453	39	24	77
RCP-583V4	8090250639	5	80V	460/3	22.4	18.5	CPXHT-25	453	39	24	77
RCP-583H	8090250621	5	80H	208-230/3	22.4	18.5	CPXHT-25	481	71	24	49
RCP-583H4	8090250638	5	80H	460/3	22.4	18.5	CPXHT-25	481	71	24	49
RCP-7581VS	8090250724	7.5	80V	208-230/1	32.5	23	CPXHT-25	479	39	24	77
RCP-7581HS	8090250732	7.5	80H	208-230/1	32.5	23	CPXHT-25	538	71	24	49
RCP-7583VS	8090250740	7.5	80V	208-230/3	32.5	23	CPXHT-25	467	39	24	77
RCP-7583VS4	8090250906	7.5	80V	460/3	32.5	23	CPXHT-25	467	39	24	77
RCP-7583HS	8090250757	7.5	80H	208-230/3	32.5	23	CPXHT-25	481	71	24	49
RCP-7583HS4	8090250914	7.5	80H	460/3	32.5	23	CPXHT-25	481	71	24	49
RCP-7581V	8090250626	7.5	80V	208-230/1	32.5	23	CPXHT-25	489	39	24	77
RCP-7581H	8090250625	7.5	80H	208-230/1	32.5	23	CPXHT-25	548	71	24	49
RCP-7583V	8090250629	7.5	80V	208-230/3	32.5	23	CPXHT-25	477	39	24	77
RCP-7583V4	8090250641	7.5	80V	460/3	32.5	23	CPXHT-25	477	39	24	77
RCP-7583H	8090250627	7.5	80H	208-230/3	32.5	23	CPXHT-25	491	71	24	49
RCP-7583H4	8090250640	7.5	80H	460/3	32.5	23	CPXHT-25	491	71	24	49
RCP-10123VS	8090250765	10	120V	208-230/3	44.5	35	CPXHT-50	794	41	30	86
RCP-10123VS4	8090252829	10	120V	460/3	44.5	35	CPXHT-50	794	41	30	86
RCP-10123HS	8090250773	10	120H	208-230/3	44.5	35	CPXHT-50	705	77	26	59
RCP-10123HS4	8090252811	10	120H	460/3	44.5	35	CPXHT-50	705	77	26	59
RCP-10123V	8090250604	10	120V	208-230/3	44.5	35	CPXHT-50	854	41	30	86
RCP-10123V4	8090250634	10	120V	460/3	44.5	35	CPXHT-50	854	41	30	86
RCP-10123H	8090250602	10	120H	208-230/3	44.5	35	CPXHT-50	765	77	26	59
RCP-10123H4	8090250633	10	120H	460/3	44.5	35	CPXHT-50	765	77	26	59



RCP-10123H

Standard Features:

- Start/stop pressure switch control
- ASME tank and safety valves
- Fully enclosed belt guard
- Magnetic starter
- Manual tank drain
- Discharge valve

Premium models include all standard features plus:

- Low oil level switch
- Auto tank drain
- Triple-pass pump mounted aftercooler (5 and 7.5 HP)
- Belt guard aftercooler (10 HP)

Time Proven Design

RCP Series Compressors - Exceptional Strength

With durability, performance, solid cast iron cylinder, crankshaft and valve plates the RCP provides the strength that is required for everyday use. Aluminum head and coolers with deep fins allow for unmatched heat dissipation. Balanced pistons and crankshaft mean smoother and quieter operation. Oversized main bearings and automotive style replaceable insert bearings for a durable compressor pump. All units are 100% tested at full pressure.

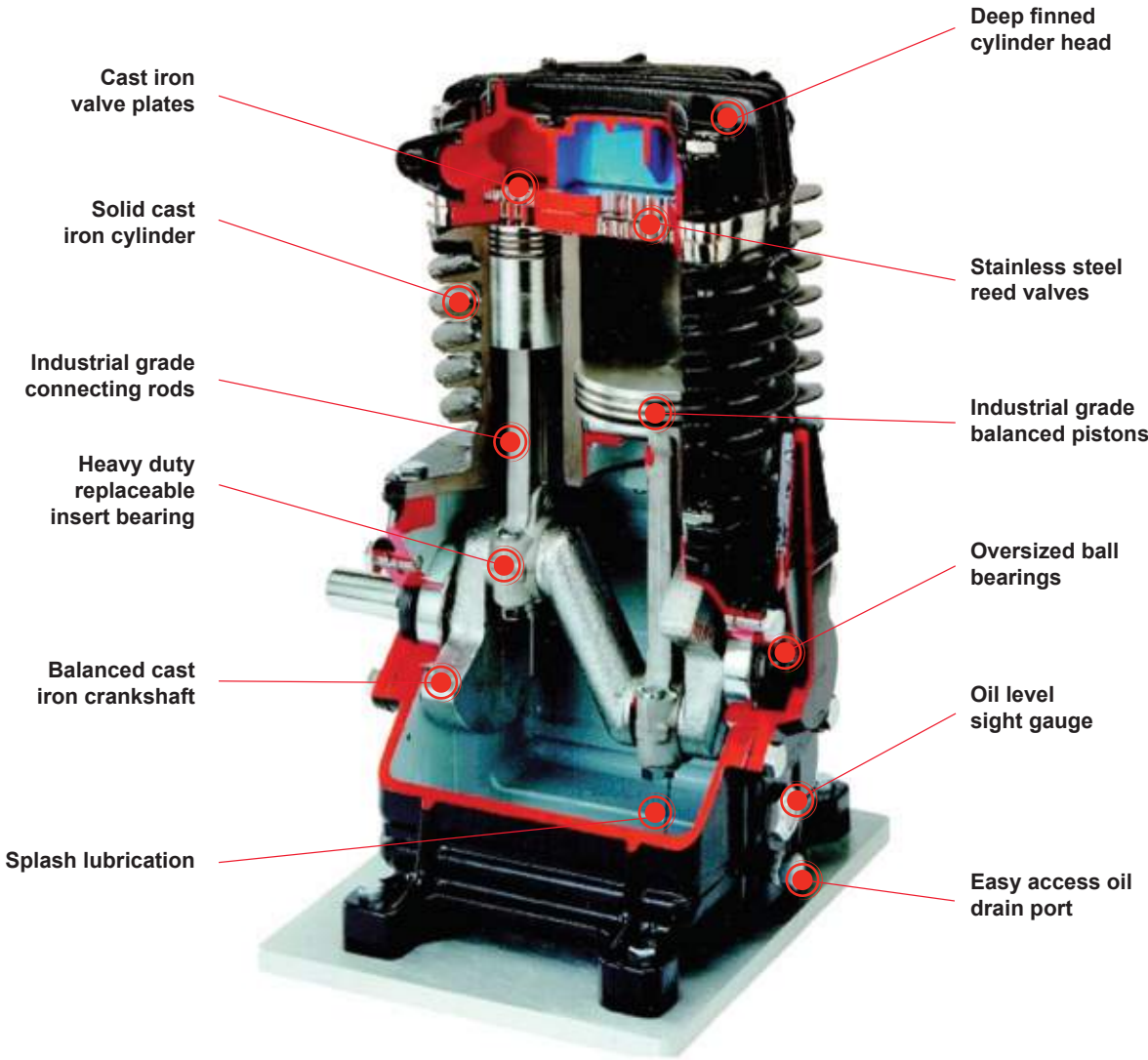

The CP Compressor Guarantee

Chicago Pneumatic (CP) is dedicated to providing high quality, reliable equipment that has stood the test of time as one of the most rugged compressors in the market. Our compressors are 100% factory tested, and we stand behind our products with one of the most competitive warranties in the industry!

- | | |
|---------------------------------------|-----------------|
| • All rotary screw | 5 YEARS* |
| • Two-stage reciprocating | 2 Years |
| • Single-stage reciprocating | 1 Year |
| <i>*Authorized start-up required.</i> | |

CP compressors are supported by a network of trained service technicians who can provide complete warranty support, spare parts and technical consultation. For more information on our products, please contact your CP territory sales manager or a local authorized CP distributor.

High Temp Refrigerated Dryers												
Model	50°F PDP cfm @ 100 psig	Use with	Electrics	Ref. HP	Heat Exchanger	Max. psig	Refrig.	Weight (lbs.)	L (in.)	W (in.)	H (in.)	Conn. (NPT)
CPXHT-25	25	5 HP	115/1/60	1/4	SS/Copper	232	R-134a	85	20	14	18	1/2"
CPXHT-50	50	10 HP	115/1/60	1/4	SS/Copper	232	R-404A	128	23	18	31	1"
CPXHT-75	75	15 HP	115/1/60	1/2	SS/Copper	232	R-404A	183	23	18	31	3/4"
CPXHT-100	100	20 HP	115/1/60	3/4	SS/Copper	232	R-404A	194	23	18	41	3/4"
CPXHT-125	125	25 HP	115/1/60	3/4	SS/Copper	232	R-404A	200	23	18	41	3/4"

Maximum Ambient 95°F
Minimum Ambient 34°F

Dew Point Temp 50°F +/- 2°F
Maximum Temp 180°F

Standard Features:

- 180° F max inlet temp
 - 3 micron filter/separator
 - Inlet strainer
 - Precooler/reheater
- Six foot power cord
 - Automatic drain valve
 - Ambient air condenser filter
 - One year warranty on entire package

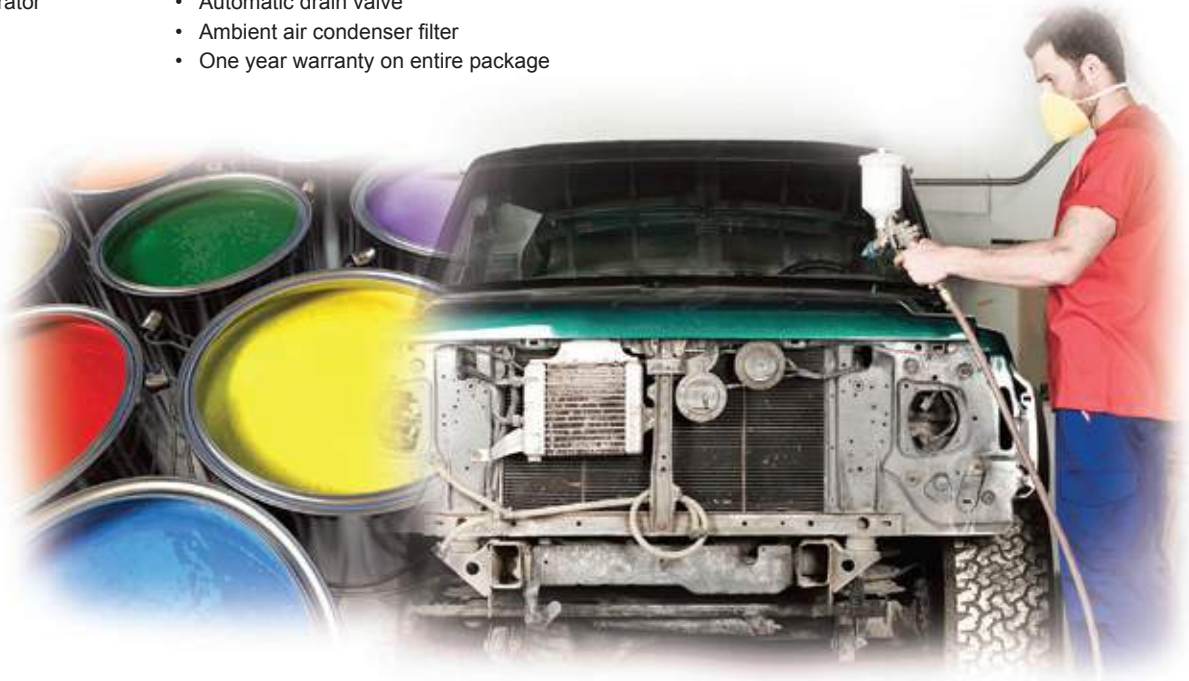

Magnetic Motor Starters			
Model	Part Number	HP	Voltage/Phase
Starter	1312100659	5 HP	230V / 1~
Starter	1312100662	7.5 HP	230V / 1~
Starter	1312100656	7.5 HP	230V / 3~
Starter	1312100657	7.5 HP	460V / 3~
Starter	1312100658	7.5 HP	230V / 3~
Starter	1312100661	10 HP	230V / 3~
Starter	1312100654	10 HP	460V / 3~
Starter	1312100655	10 HP	575V / 3~
Starter	1312100660	15 HP	575V / 3~

Starters come fully wired with contractors for immediate installation

Skid weights may vary. Additional charge for lift gate truck is required.

Single Stage Electric Simplex											
Model	Part Number	HP	Tank gal.	Electrics Voltage/Phase	cfm displ.	cfm @ 100 psi	Mag. Starter	Weight (lbs.)	L (in.)	W (in.)	H (in.)
RCP-220P	8090250614	2	20P	115/230/1	11.9	7.1	n/a	155	35	20	32
RCP-226VP	8090250615	2	26VP	115/230/1	11.9	7.1	n/a	165	26	26	51
RCP-3561V	8090250616	3.5	60V	208-230/1	16.8	12.4	n/a	261	30	22	68

Standard Features:

- Start/stop pressure switch control
- ASME safety valves on tank and pump
- Fully enclosed belt guard
- Tank drain and discharge valve



RCP-226VP

Two Stage Electric Duplex											
Model	Part Number	HP	Motor Config.	Electrics Voltage/Phase	cfm displ.	cfm @ 100 psi	Tank gal.	Weight (lbs.)	L (in.)	W (in.)	H (in.)
RCP-10121D	8090250600	10	2 x 5 HP	208-230/1	44.9	37.0	120H	778	77	27	56
RCP-10123D	8090250601	10	2 x 5 HP	208-230/3	44.9	37.0	120H	778	77	27	56
RCP-10123D4	8090250632	10	2 x 5 HP	460/3	44.9	37.0	120H	778	77	27	56
RCP-15121D	8090250610	15	2 x 7.5 HP	208-230/1	65.0	50.5	120H	886	77	27	56
RCP-15123D	8090250611	15	2 x 7.5 HP	208-230/3	65.0	50.5	120H	886	77	27	56
RCP-15123D4	8090250635	15	2 x 7.5 HP	460/3	65.0	50.5	120H	886	77	27	56
RCP-15201D	8090250807	15	2 x 7.5 HP	208-230/1	65.0	50.5	200H	1137	86	32	62
RCP-15203D	8090250815	15	2 x 7.5 HP	208-230/3	65.0	50.5	200H	1053	86	32	62
RCP-15203D4	8090250922	15	2 x 7.5 HP	460/3	65.0	50.5	200H	1053	86	32	62
RCP-20123D	8090250612	20	2 x 10 HP	208-230/3	89.0	74.5	120H	990	77	27	63
RCP-20123D4	8090250636	20	2 x 10 HP	460/3	89.0	74.5	120H	990	77	27	63
RCP-20203D	8090250613	20	2 x 10 HP	208-230/3	89.0	74.5	200H	1229	86	32	69
RCP-20203D4	8090250637	20	2 x 10 HP	460 / 3	89.0	74.5	200H	1229	86	32	69

Standard Features:

- Alternator
- Magnetic motor starter
- Start/stop dual pressure switch control
- 1" tank discharge valve
- Fully enclosed belt guard
- ASME safety valves on tank and pump
- Chicago Pneumatic duplex package showing the multiple pumps and motors which ensure back-up operation



RCP-20123D

Skid weights may vary. Additional charge for lift gate truck is required.

Two Stage Gasoline Drive											
Model	Part Number	HP	Engine	Electric and Recoil Start	cfm displ.	cfm @ 100 psi	Tank gal.	Weight (lbs.)	L (in.)	W (in.)	H (in.)
RCP-930G	8090250631	9	Robin	Standard	19.1	16.0	30H	328	45	19	38
RCP-1030G	8090250606	10	Intek	Standard	19.1	16.0	30H	328	45	19	38
RCP-1130G	8090250607	11	Honda	Standard	22.4	18.5	30H	358	45	19	45
RCP-1230GK	8090250823	14	Kohler	Standard	22.4	18.5	30H	369	45	19	45
RCP-1230G	8090250608	14	Kohler	Standard	32.5	25.3	30H	369	45	19	45
RCP-1330G	8090250609	13	Honda	Standard	32.5	25.3	30H	378	45	19	45

Standard Features:

- 12 Volt electric start and recoil start
- 12 Volt alternator (Honda and Kohler Models)
- Start key / panel
- Oil monitor
- Engine slowdown (pilot valve)
- Fully enclosed belt guard
- EZ pull tank drain
- ASME tank and safety valves
- 3/4" tank discharge valve

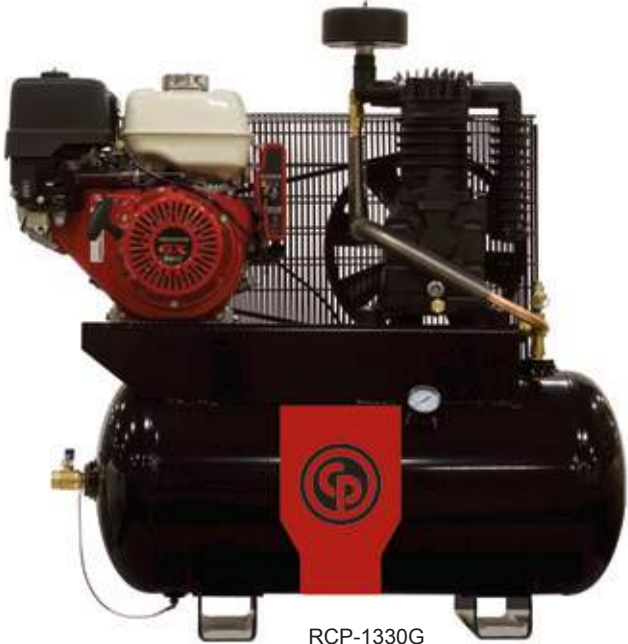

Single Stage Electric Contractor Series											
Model	Part Number	HP	Amps	Electrics Voltage/Phase	cfm displ.	cfm @ 100 psi	Tank gal.	Weight (lbs.)	L (in.)	W (in.)	H (in.)
RCP-1530	8090250831	1.5	14	115 / 1	8.5	5.4	2 x 4	130	46	23	26
RCP-2030	8090250849	2	19 / 9.5	115 / 230 / 1	8.7	6.5	2 x 4	130	46	23	26

Standard Features:

- Start/stop pressure switch control
- Fully enclosed belt guard
- Tank drains and safety valves on each tank



Skid weights may vary. Additional charge for lift gate truck is required.

Single Stage Gasoline Drive Contractor Series											
Model	Part Number	HP	Engine	Starter	cfm displ.	cfm @ 100 psi	Tank gal.	Weight (lbs.)	L (in.)	W (in.)	H (in.)
RCP-5530	8090250856	5.5	Honda	Recoil	18.4	12.4	2 x 4	221	46	23	26
RCP-6030	8090250864	6	Robin	Recoil	18.4	12.4	2 x 4	221	46	23	26

Two Stage Gasoline Drive Contractor Series											
Model	Part Number	HP	Engine	Starter	cfm displ.	cfm @ 100 psi	Tank gal.	Weight (lbs.)	L (in.)	W (in.)	H (in.)
RCP-908R	8090250872	9	Robin	Recoil	22.4	18.6	2 x 5	316	50	29	37
RCP-908H	8090250880	9	Honda	Recoil	22.4	18.6	2 x 5	316	50	29	37
RCP-128-I	8090250898	14	Kohler	Elec & Recoil	22.4	25.3	2 x 5	345	50	29	37

Standard Features:

- Engine slowdown (pilot valve)
- Engine oil protection
- Fully enclosed belt guard tank drains and discharge valve
- ASME safety valves on tank and pump



Model	RCP-581VQP	RCP-583VQP	RCP-7581VQP	RCP-7583VQP
HP	5	5	7.5	7.5
acfm @ 100 psig	18.5	18.5	25.3	25.3
acfm @ 175 psig	16.6	16.6	22.3	22.3
Max Pressure	175	175	175	175
Voltage/Phase	208-230 / 1	208-230 / 3	208-230 / 1	208-230 / 3
Sound Level (dBA)	66	66	69	69
Shipping Weight (lbs.)	527	513	549	537
L x W x H (in.)	38.2 x 24.3 x 80	38.2 x 24.3 x 80	38.2 x 24.3 x 80	38.2 x 24.3 x 80

Standard Features:

- Low sound enclosure
- Low oil level protection
- Automatic tank drain
- Magnetic starter
- Cast iron cylinder
- 80 gallon vertical ASME/CRN tank
- 100% factory tested at full pressure
- High temperature shut down



Skid weights may vary. Additional charge for lift gate truck is required.

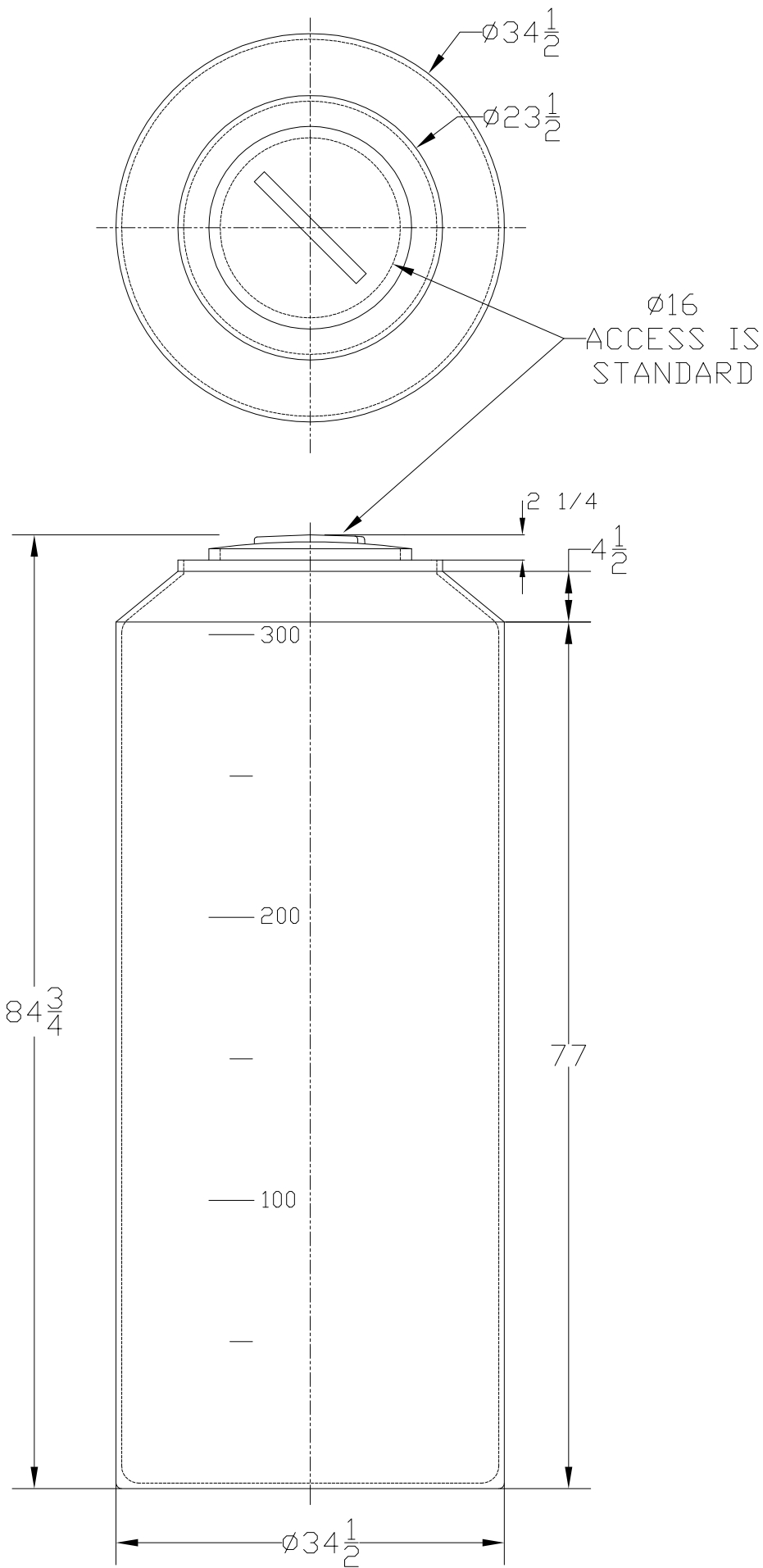

THIS DRAWING & DESIGN IS THE PROPERTY OF CHEM-TAINER INDUSTRIES INC. IT MAY NOT BE USED FOR ANY PURPOSE OTHER THAN BY THE OWNER. CHEM-TAINER DOES NOT AUTHORIZE THE REPRODUCTION OR CONVEYANCE OF ANY INFORMATION CONTAINED HEREIN.

ALL DIMENSIONS SHOWN ARE OUTSIDE PART DIMENSIONS IN INCHES, AND VARY BY THE STANDARD ROTATIONAL MOLDING TOLERANCE OF ±2%.

Rev. 0	Date 05/13/99	File Name IA3581-1
CHEM-TAINER Industries Inc. 361 Neptune Ave. W. Babylon, NY 11704 (631) 661-8300 Fax: (631) 661-8209		
Date 05/13/99		Mold Location CA
Drawn By: EJS		Cust. Rep.
TITLE 300 GALLON VERTICAL BULK STORAGE TANK		
Part # TC3581IA/IC	Dwg. # C-3581-15	



FROM
PURCLEAN™
SPOT-FREE RINSE SYSTEMS

PURCLEAN™ SPOT FREE RINSE SYSTEM

E³ Series 3,000GPD Spot Free Rinse System

Features:

- Water Stabilizer - Replaces Water Softener
- Lower Reject & Flush Water Use for More Efficiency
- Inlet & Pressure Pump
- Easy Installation - Installation Kit Included
- Clear Control Box Lid - Quick and Easy PLC Diagnostics
- Carbon Tank with Auto Back Flushing Head
- Multi-Stage Pressure Pump
- Low Incoming Water Pressure Shut Off
- Automatic Membrane Flush
- Production & Reject Meter
- On Board Dual TDS Meters
- Thin Film Membrane
- ETL Listed
- Repressurization and / or Reject Recapture Delivery Pump

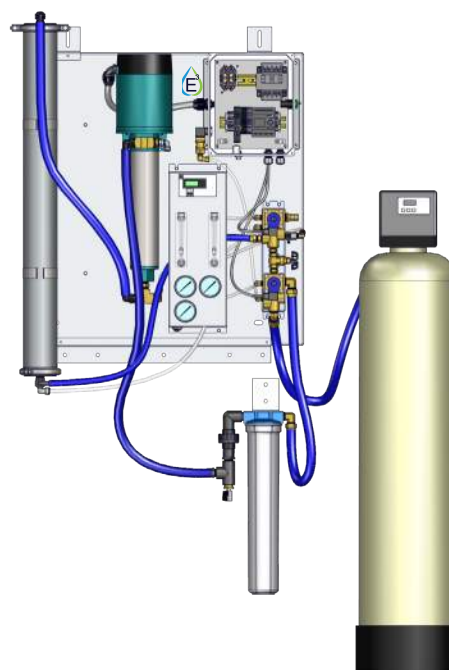

Specifications

Water Requirements	(1) 1" Water line w/FPT ball valves, 20GPM at 30PSI. Mount 4 feet up from floor to the right of the spot free rinse system and (1) drain.			
Electrical Requirements	1Ph	(1) 220V 20 Amp single phase circuit with a cord and a L6-20 locking receptacle or a flexible watertight conduit. Electrical box should be 5 feet away from the floor on the right side of the equipment.		
	3Ph	(1) 208/230V or 460/480V 20 Amp circuit with a flexible watertight conduit. Electrical box should be 5 feet from the floor on the right side of the equipment.		
RO Output	Production - 2.1 GPM			
Reject	0.9 GPM			
RO Motor	1HP 60 Hz 3450 RPM Open Drip Proof			
RO Motor Amps	1Ph 208/230 = 9 amps	3Ph 208/230 = 4.5 amps	3Ph 460/480 = 2.25 amps	Contact PurClean for other power options
Dimensions	36.5"W x 18"D x 54"H			
Gross Weight	355 lbs. (machine weight with carbon tank)			
Delivery Pump	Standard delivery pump 15 GPM max at 50 PSI max. Automatic freshwater bypass. Pressure and GPM varies depending on which car wash application. <i>(Contact PurClean for more information.)</i>			

PURCLEAN™ WATER RECOVERY SYSTEM

100-5M040 Series (30GPM)

Features:

- VFD Driven Continuous Duty Motor
- Self Priming Pump
- High Efficiency Cyclonic Separators
- 5 Micron Water Output
- 4 Gram Ozone
- Stainless Steel Frame
- Control Signal Activation
- Automatic Fresh Water Bypass
- HMI - User Friendly Text Screen for Instant Access to System Status
- Self Flushing Underflow Orifice
- Motorized Ball Valve Monitoring
- Breathers - Keeps Components Cool and Increases Life
- ETL Approved



Water Requirements

PVC	(2) 2" PVC Suction lines, one for use and one for spare, to come up from settling tanks to the right of the reclaim unit with 2" PVC full flapper check valves at end, 2" unions above water line. (1) 2" line out to the wash manifold. (1) 1" Line to return to the first chamber of the second reclaim tank for ozone. (1) 1" freshwater line (40PSI) to the right of the system four feet up from the bottom of the floor. (1) 1" Line to return to the catch basin or first incoming reclaim tank for the underflow of the succession filters.
Reclaim Maximum Output	30GPM
Reclaim Pump	3HP - Amp draw at (208/230 Volt = 7.6) / 3HP - Amp draw at (460/480 Volt = 3.8)
Pump Voltage	208-230 Volts or 460-480 Volts (depending on site specifications)
Dimensions	48" Wide X 79.25" Tall X 19" Deep
Net Weight	700 Lbs. (including crate)

Electrical Requirements

Reclaim Pump and VFD	(1) 208/230 Volt 20 Amp or 460/480 Volt 20 Amp Three phase circuits to be hard wired 5 feet up from the floor to the right of the system.
Control Voltage for (PLC) Logic Controller and Ozone	(1) 120 Volt 20 Amp Single phase
Conduit	(1) 1" Conduit from reclaim equipment control box to front of the last tank (for floats). (1) ½" Conduit from each carwash equipment control box to send a control voltage signal to the repressurization power box. Control wiring from carwash controller (110V is default, 110vac, 24vac and 24vdc available) to be wired into control box on frame.
Tank Configuration Recommendation	Double tank configuration (oil/water separator may be required - please check with your local municipality)



The Car Wash Starts Here.

C-Start®



C-Start is the latest addition to Unitec's advanced and innovative product line, designed to simplify the transaction experience for car wash customers. The unit works with in-bay automatic or conveyor car wash systems and is the right choice for operators who wish to automate payment processes: the cashless unit accepts credit cards or wash codes. *C-Start* is a smart and efficient choice for petroleum market operators.

Customer Convenience and Ease of Use

C-Start features an ergonomic 12-inch touch screen user interface that is easy to understand and operate. Wash and pricing options can be viewed on a single screen, making it easy for customers to make quick decisions about which wash they wish to purchase, and for their payment procedures to be streamlined.

Flexibility

Car wash owners who want to simply accept credit cards and/or codes for payment will find that C-Start will meet their needs. Additional marketing applications are available for those who are eager to build business and increase revenues.

Marketing Options

Customizable promotions and video advertisements are standard features. An enhanced marketing package is available, offering 100,000+ house accounts which can be used for loyalty, prepaid, meet or subscription wash programs. Branding opportunities are enhanced through C-Start's customizable graphics panels and post-sale video advertising capabilities. C-Start can also be equipped with a ReachFree ID system (RFID) or 2D barcode imager.

Efficiency through Remote Management

Remote access tools allow the site owner to monitor status in real time, be notified of faults or alerts, receive daily reports and access all business data from off-site locations.

A Story From...

John Herdrich
Herdrich Petroleum/QuickPix
Rushville, IN

"The C-Start has changed the way that we do business at our car washes, and we are most pleased with its ease of use. Customers used to dig for change in order to purchase a wash. Now, they swipe a credit card that processes in a matter of seconds, guaranteeing a fast, satisfactory transaction. Our sales increased since installing the C-Start, and complaints have decreased tenfold. That's the direction we want to go.

Remote reporting gives us the ability to monitor usage in ways that we've never had at our washes, and the additional marketing options are great. We do a strong business in our *10 washes for the price of 9* bundle, and our managers have the ability to **tailor specials and promotions to their sites.**

The C-Start has been a great solution for us. It has allowed us to **grow our business at the wash while selling at the pump.** Its user-friendly operation gives our customers a great experience that keeps them coming back."

C-Start®

Features & Specifications

Standard Features

- Windows® POSReady operating system
- Integrated heater
- Two outdoor rated 5W speakers
- High speed thermal printer (text & graphics) with programmable receipt messages
- Visa®, MasterCard®, American Express® and Discover® acceptance via Internet credit card clearing system
- Wash menu function to show content of each wash package
- Bilingual screen and voice capabilities (English and Spanish)
- Programmable promotions such as discounts, complimentary washes, fundraisers and scheduled specials
- Allows for the sale of optional services, such as tire shine, surface protectants, etc. Custom logo buttons may be added to display these services.
- Remote error notifications through text or email message
- Pre- and post-sale advertisement to show while the customer is waiting for the wash to become available

Optional Features

- Ultrasonic proximity sensor starts messaging when vehicles drive up
- Enhanced marketing package for VIP Wash Pass® cards and house account applications with multi-site redemption
- POS Interface allows car wash codes to be sold at the gas dispensers or in the C-Store
- 2D barcode imager
- ReachFree ID subscription-based account system
- Credit processing through Wayne, Verifone or Gilbarco

Warranty

- One year limited warranty from date of purchase

Optional c-WashPal™ console (shown right) with a card reader, 7" color touch screen and ticket printer



Specifications

- **Size:**
C-Start: 18.5" W x 31" H x 18" D
c-WashPal Console: 9" W x 7.5" H x 7.5" D
c-WashPal Printer: 5.5" W x 5.5" H x 8" D
- **Shipping Weight:**
C-Start: 95 lbs
c-WashPal Console & Printer: 20 lbs
- **Power Requirements:**
C-Start: 120VAC, 8 Amps with dedicated circuit breaker
c-WashPal Console & Printer: 120VAC, 2 Amps for Console; 1.5 Amps for Printer
- **Regulatory Approvals:**
Certified to UL 60950, FCC part 15 compliant
- **Operating Temperatures:**
Certified -20F — 115F
Brick-in recommended for units operating at sustained periods below 0F and above 100F



Unitec – Who We Are

Unitec develops, designs and manufactures reliable, innovative point-of-sale entry systems for the car wash industry. In addition to selling complete systems, system components and parts, we develop custom applications for high-volume resellers and retailers, providing owners of automated car wash facilities the right equipment, tools and marketing opportunities to increase revenues while improving customer loyalty. Unitec has earned a reputation for producing systems of the highest quality and reliability in the industry, from simple swipe-and-go credit card terminals to the most sophisticated, internet-enabled and video-capable touch screen kiosks. We are in business to satisfy the car wash owner's foremost needs, offering free-standing, customer-activated products that integrate with all types of car wash control technologies.

24" and 30" Commercial/Industrial Blow Molded Brine Tanks



Clack offers both 24" and 30" round blow molded brine tanks. The introduction of the 30" diameter tank makes it the largest blow molded brine tank for commercial/industrial applications.

Like the 24" round tank, the 30" tank is molded of high density polyethylene for exceptional stress and crack resistant properties.

These tanks are ideal for industrial and commercial use and the 30" tank feature heavy wall thickness for increased durability.

Injection molded grids are available for both 24" and 30" tanks and use 1½" schedule 40 PVC pipe for leg supports.

The legs can be cut to any length for easy grid height adjustment. A precut leg kit for the 24" grid is also available, giving it an overall grid height of 10¼".

ORDER NUMBER	DESCRIPTION	LIQUID CAPACITY	SALT CAPACITY	HEIGHT W/LID	DIAMETER	SHIPPING WEIGHT	CARTON SIZE	UNITS PER CARTON
G22441CB1C00	24 x 41 Black Brine Tank	80 gal./ 303 liters	700 lbs./ 318 Kg	42.5 in/ 108 cm	24.5 in./ 62 cm	23.5 lbs./ 10.7 Kg	15 ft. ³	1
G22450CB1C00	24 x 50 Black Brine Tank	100 gal./ 378 liters	900 lbs./ 408 Kg	51.5 in/ 131 cm	24.5 in./ 62 cm	27.25 lbs./ 12.4 Kg	18 ft. ³	1
G23050CB1C00	30 x 50 Black Brine Tank	150 gal./ 579 liters	1400 lbs./ 640 Kg	52.5 in/ 133 cm	31 in./ 79 cm	49 lbs./ 22.3 Kg	30 ft. ³	1



ACCESSORY INFORMATION		
ORDER NUMBER	DESCRIPTION	QUANTITY/CARTON
H1080	24" Plastic Brine Grid (2 plates/set)	5 Sets
H1032	30" Plastic Brine Grid (2 plates/set)	3 Sets
H1089	PVC Grid Legs for 24" Grid (7/set)	5 Sets

FLECK® 2850 COMMERCIAL CONTROL VALVES

IDEAL FOR SMALL COMMERCIAL AND INDUSTRIAL APPLICATIONS

**MADE IN THE
USA**
OF FOREIGN & DOMESTIC PARTS



FEATURES/BENEFITS

Lead-free brass valve body for superior strength and durability

Continuous service flow rate of 46 GPM with a backwash of 47 GPM

Backwash capability accommodates softener tanks up to 36" and filters up to 24" in diameter

Fully adjustable 3- or 5-cycle control for efficient and reliable water treatment system

Designed for single or multiple tank systems

Environmental protective cover for water resistance, corrosion resistance, and UV stability

Time-tested, hydraulically-balanced piston for service and regeneration

Rugged-built electromechanical timer designed with heavy duty 3/8" wide plastic gears

OPTIONS

Filter or softener control valves

No hard water bypass piston

Brine cam auxiliary switch

Electromechanical timer auxiliary switch

Hot water

Versatile top or side mount

Manual lever operations

NXT- Network controller uses on-board communication capabilities to link multiple valves (via off-the-shelf CAT3, CAT5, or better cables) for system types 4, 5, 6, 7, 9, and 14

SXT- Large LCD display and user-selectable time clock or metered function; usable for filtration and softener systems

XT- Offers a two-line, 16 character LCD backlit display for easy entering of master and user programming as well as view of diagnostics

Electromechanical Timer- Simple to adjust and easy to service with quick access to all internal components



TESTED and CERTIFIED by the WQA to NSF/ANSI Standard 61 Section 8 Material Safety Only.



TESTED and CERTIFIED by the WQA to NSF/ANSI Standard 372 for Lead Free Compliance.



UL recognized to 979



Restriction of Hazardous Substance Compliant

VALVE SPECIFICATIONS

Valve Material	Lead-free brass*
Inlet/Outlet	1-1/2" NPTF/BSPF
Cycles	3 or 5

FLOW RATES (50 PSI INLET) – VALVE ALONE

Continuous 15 psi drop	46 GPM (10.4 m ³ /h)
Peak 25 psi drop	60 GPM (13.6 m ³ /h)
Cv flow at 1 psi drop	12
Max. Backwash 25 psi drop	47 GPM (10.7 m ³ /h)

REGENERATION

Downflow/Upflow	Downflow only
Adjustable Cycles	Yes
Time Available	
Electromechanical:	0 - 164 min/regeneration
SXT:	0 - 199 min/cycle
NXT:	0 - 240 min/cycle
XT:	0 - 240 min/cycle

METER INFORMATION

Meter Accuracy	
1" Paddle:	0.7 - 40 GPM ± 5% (0.16 - 9 m ³ /h)
1-1/2" Paddle:	1.5 - 75 GPM ± 5% (0.34 - 17 m ³ /h)
1-1/2" Turbine:	2 - 40 GPM +5/-8% (0.45 - 9 m ³ /h)
Meter Capacity Range	
1" Standard:	310 - 5,270 gal (1.2 - 20 m ³)
1" Extended:	1,550 - 26,350 gal (6 - 100 m ³)
1-1/2" Standard:	625 - 10,625 gal (2.5 - 40 m ³)
1-1/2" Extended:	3,125 - 53,125 gal (12 - 200 m ³)
SXT:	1 - 999,900 gal (0 - 3,785 m ³)
NXT:	1 - 9,900,000 gal (0 - 37,476 m ³)
XT:	1,000 - 9,900,000 gal (3.8 - 37,476 m ³)

DIMENSIONS

Distributor Pilot	1.9" O.D. (50 mm)
Drain Line	1" NPTM
Brine Valve	
1600 or 1650:	3/8"
1700 or 1710:	1/2"
Injector System	1600 or 1700
Mounting Base	4" - 8 UN
Height from Top of Tank	6.5" (165 mm)
Riser Tube Diameter	1-1/2" (38 mm)
Riser Height	1/4" Below top of tank

TYPICAL APPLICATIONS

Water Softener	14 - 36" diameter
Filters	14 - 30" diameter based on 10 GPM/ft ²

ADDITIONAL INFORMATION

Electrical Rating	24/110/220V 50/60 Hz
Estimated Shipping Weight	
Time Clock:	7 lbs
Metered Valve:	10 lbs
Pressure	
Hydrostatic:	300 psi (20 bar)
Working:	20 - 125 psi (1.4 - 8.5 bar)
Temperature	
Cold Water Valve:	34 - 110°F (1 - 43°C)
Hot Water Valve:	34 - 180°F (1 - 82°C)
Filter, Time Clock, 1600 Brine System	
Hot Water Valve:	34 - 150°F (1 - 66°C)
Meter, 1700 Brine System	

*As defined in the U.S. EPA Safe Drinking Water Act; the product also meets California Proposition 65 Standards for lead-free brass.



FILTRATION & PROCESS

5730 NORTH GLEN PARK ROAD, MILWAUKEE, WI 53209
P: 262.238.4400 | WWW.PENTAIRAQUA.COM | CUSTOMER CARE: 800.279.9404 | tech-support@pentair.com

All Pentair trademarks and logos are owned by Pentair, Inc. or its affiliates. All other registered and unregistered trademarks and logos are the property of their respective owners. Because we are continuously improving our products and services, Pentair reserves the right to change specifications without prior notice. Pentair is an equal opportunity employer.

40726 REV E JL14 © 2013 Pentair Residential Filtration, LLC. All Rights Reserved.