

CITYWIDE SIDEWALK REPAIR  
PROJECT  
CIP NO. 9720

EXHIBIT B

PROJECT LIMITS

LOCATION MAP

NOT TO SCALE

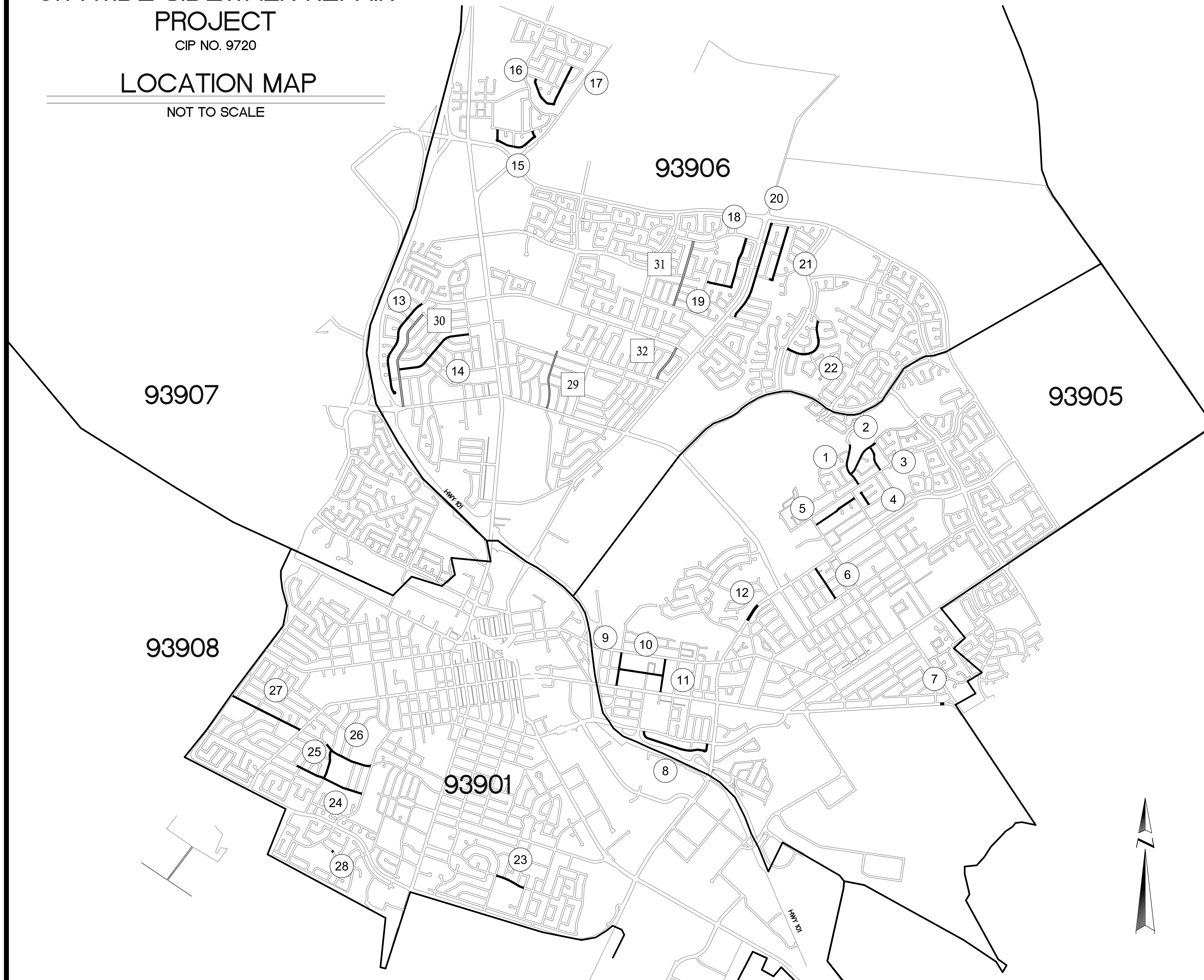

- BASE BID #1**
- DISTRICT 1**
- ① LAS CASITAS DRIVE,  
- BETWEEN NATIVIDAD CREEK BRIDGE & RIDER AVENUE
  - ② NOGAL DRIVE  
- BETWEEN LAS CASITAS & PACANA CIRCLE
  - ③ AMARILLO WAY  
- BETWEEN NOGAL DRIVE & RIDER AVENUE
  - ④ CARIBBEAN AVENUE  
- BETWEEN HAWAII PLACE & PACIFIC AVENUE
  - ⑤ ATLANTIC STREET  
- BETWEEN GARNER AVENUE & DEL MONTE AVENUE
- DISTRICT 2**
- ⑥ KIMMEL STREET  
- BETWEEN N. SANBORN ROAD & BEECH STREET
  - ⑦ ALISAL STREET  
- 1819 E. ALISAL STREET
  - ⑧ MEADOW DRIVE & MAGNOLIA DRIVE  
- BETWEEN JOHN STREET (EAST) & JOHN STREET (WEST)
- DISTRICT 4**
- ⑨ N. MADEIRA AVENUE  
- BETWEEN E. MARKET STREET & E. ALISAL STREET
  - ⑩ ROOSEVELT STREET  
- BETWEEN N. MADEIRA & N. PEARL STREET
  - ⑪ N. PEARL STREET  
- BETWEEN E. MARKET STREET & E. ALISAL STREET
  - ⑫ N. SANBORN ROAD  
- BETWEEN EUCALYPTUS DRIVE & N. MADEIRA AVENUE
- DISTRICT 5**
- ⑬ CHEROKEE DRIVE  
- BETWEEN SEMINOLE WAY & CUL-DE-SAC
  - ⑭ CRESCENT WAY  
- BETWEEN ADAMS STREET & N. FIRST STREET
  - ⑮ NORTHBRIDGE DRIVE  
- BETWEEN SWANER AVENUE (EAST) & SWANER AVENUE (WEST)
  - ⑯ LOUISE STREET  
- BETWEEN CLEVELAND AVENUE & LENNY STREET
  - ⑰ LENNY STREET  
- BETWEEN LOUISE STREET & HOOVER STREET
- DISTRICT 6**
- ⑱ EMERALD DRIVE  
- BETWEEN ARCADIA WAY & HUMBOLDT DRIVE
  - ⑲ DONNER WAY  
- BETWEEN ARCADIA WAY & HUMBOLDT DRIVE
  - ⑳ PESCADERO DRIVE  
- BETWEEN INGLEWOOD STREET & LOS COCHES AVENUE
  - ㉑ GLENDORA WAY  
- BETWEEN INGLEWOOD STREET & COMPTON WAY
  - ㉒ LEXINGTON DRIVE  
- BETWEEN INDEPENDENCE BOULEVARD & PROVINCETOWN DRIVE
- DISTRICT 3**
- BASE BID #2**
- ㉓ SAN MIGUEL AVENUE  
- BETWEEN SAN JUAN DRIVE & SAN FERNANDO DRIVE
- BASE BID #3**
- ㉔ PALMA DRIVE  
- BETWEEN SIERRA MADRE DRIVE & IVERSON STREET
- BASE BID #4**
- ㉕ SAN VINCENTE AVENUE  
- BETWEEN W. ACACIA STREET & PALMA DRIVE
- BASE BID #5**
- ㉖ W. ACACIA STREET  
- BETWEEN SAN VINCENTE AVENUE & IVERSON STREET
- BASE BID #6**
- ㉗ W. ACACIA STREET  
- BETWEEN S. DAVIS ROAD & W. ALISAL STREET
- BASE BID #6**
- ㉘ COLERIDGE DRIVE  
- 330 COLERIDGE DRIVE
- POTENTIAL EXTRA WORK LOCATIONS**
- DISTRICT 4**
- ㉙ MARYAL DRIVE  
- BETWEEN CHAPARRAL STREET & EAST LAUREL DRIVE
- DISTRICT 5**
- ㉚ ADAMS STREET  
- MOHAWK AVENUE & WEST LAUREL DRIVE
- DISTRICT 6**
- ㉛ KLAMATH DRIVE,  
- BETWEEN CALAVERAS DRIVE & ARCADIA WAY
  - ㉜ MARIN AVENUE  
- BETWEEN EAST ALVIN DRIVE & RAINIER DRIVE