

COVENTRY STREET TRAFFIC CALMING

TRAFFIC CIRCLE

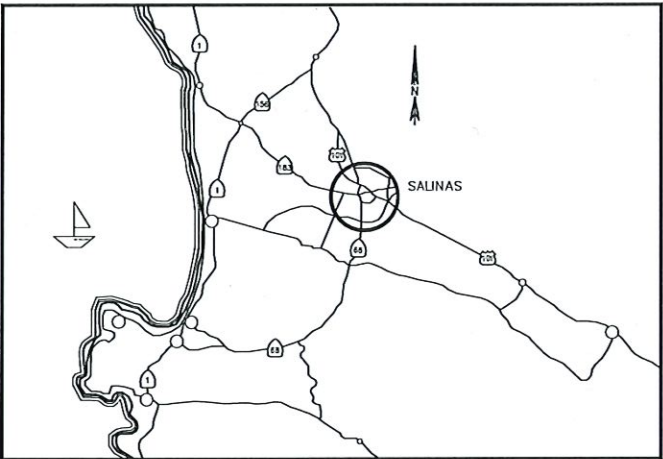

VICINITY MAP
NOT TO SCALE

SHEET INDEX	SHEET NO.
TITLE SHEET	1
CONSTRUCTION PLAN	2
DETAILS	3

LEGEND

- == EXISTING CURB AND GUTTER
- NEW SIGN ON NEW POLE
- REMOVE EXISTING PAVEMENT MARKINGS
- TEXT CALTRANS PAVEMENT MARKING TEXT OR ARROW SHOWN (A24A-E)
- AC ASPHALT CONCRETE



Know what's below.
Call before you dig.

GENERAL NOTES

- EXCEPT AS OTHERWISE SPECIFIED, ALL WORK AND MATERIALS SHALL CONFORM TO AND BE IN ACCORDANCE WITH THE APPLICABLE PROVISIONS OF THE CITY OF SALINAS STANDARD SPECIFICATIONS, DESIGN STANDARDS LATEST EDITION, AND STATE STANDARD PLANS (2022), CA MUTCD (LATEST EDITION) AND CONTRACT SPECIFICATIONS.
- THE EXISTING FACILITIES INDICATED ON THESE PLANS ARE DESIGNATED AS CLOSELY AS POSSIBLE TO REPRESENT EXISTING CONDITIONS. HOWEVER, IT SHALL BE THE CONTRACTOR'S RESPONSIBILITY TO ASCERTAIN THE EXISTENCE AND LOCATION OF ALL UNDERGROUND AND OVERHEAD FACILITIES AND TO PROTECT THEM FROM DAMAGE. THE CONTRACTOR SHALL BEAR TOTAL EXPENSE FOR REPAIR OR REPLACEMENT OF ANY UNDERGROUND OR OVERHEAD FACILITIES DAMAGED BY THEIR OPERATIONS. THE CONTRACTOR SHALL CONTACT U.S.A. (UNDERGROUND SERVICE ALERT, TELEPHONE NUMBER 811) 48 HOURS IN ADVANCE BEFORE PERFORMING ANY TRENCHING AND/OR EXCAVATION WORK.
- ANY EXISTING RAISED PAVEMENT MARKERS, LEGEND, AND/OR STRIPING THAT IS TO REMAIN AND IS DAMAGED AND/OR REMOVED DURING THE STRIPING WORK SHALL BE REPLACED BY THE CONTRACTOR AT THEIR COST PER THE PLANS AND SPECIFICATIONS. ALL REPLACED PAVEMENT MARKINGS AND STRIPING SHALL BE THERMOPLASTIC, PER PROJECT SPECIFICATIONS.
- IN THE EVENT OF ANY CONFLICT OF INFORMATION SHOWN ON THE PLANS, THESE SPECIFICATIONS, ANY CONFLICT BETWEEN THE PLAN AND THE INTENT FOR A CONSISTENT AND FUNCTIONAL FACILITY OR IN THE FIELD THE CONTRACTOR SHALL NOTIFY THE CITY ENGINEER IN WRITING, UPON WHICH TIME THE CITY ENGINEER SHALL RESOLVE THE CONFLICT BY THE ISSUANCE OF A WRITTEN CHANGE ORDER BY REVISING THE PLAN, SPECIFICATIONS AND/OR BOTH. THE CONTRACTOR SHALL BEAR FULL COST AND RESPONSIBILITY FOR WORK AFFECTED BY SUCH UNRESOLVED CONFLICTS AND PERFORMED BY THE CONTRACTOR PRIOR TO THE RESOLUTION BY THE CITY ENGINEER.
- THE CONTRACTOR SHALL EXERCISE ALL NECESSARY CAUTION TO AVOID DAMAGE TO ANY EXISTING TREES, LANDSCAPE, UTILITIES AND/OR SURFACE IMPROVEMENTS WHICH ARE TO REMAIN IN PLACE, AND SHALL BEAR FULL RESPONSIBILITY FOR ANY DAMAGE THERETO.
- THE CONTRACTOR SHALL FURNISH AND INSTALL ALL MATERIALS, EQUIPMENT, LABOR, AND INCIDENTAL FOR THE PROJECT EXCEPT AS SHOWN N.I.C., BY OTHERS (NOT IN CONTRACT OR BY OTHERS) OR CITY FURNISHED MATERIALS.
- THE CONTRACTOR IS RESPONSIBLE TO ENSURE THAT FINISHED AREAS OF THE PROJECT ARE PROTECTED FROM ANY DAMAGE, WHICH MAY RESULT FROM ADJACENT AREAS STILL UNDER CONSTRUCTION.
- ALL WORK TO BE SCHEDULED AND COORDINATED BY THE CONTRACTOR WITH THE CONSTRUCTION ACTIVITIES OF THE UTILITY COMPANIES AND/OR ANY OTHER CONTRACTOR(S) WORKING IN THE AREA.
- THE CONTRACTOR AGREES THAT THEY SHALL ASSUME SOLE AND COMPLETE RESPONSIBILITY FOR JOB SITE CONDITIONS, INCLUDING THE SAFETY OF PERSONS AND PROPERTY, DURING THE COURSE OF CONSTRUCTION OF THIS PROJECT AND THAT THIS REQUIREMENT SHALL APPLY CONTINUOUSLY AND NOT BE LIMITED TO NORMAL WORKING HOURS. THE CONTRACTOR SHALL DEFEND, INDEMNIFY AND HOLD THE CITY AND THE CITY ENGINEER HARMLESS FROM ANY AND ALL LIABILITY, REAL OR ALLEGED, IN CONNECTION WITH THE PERFORMANCE OF WORK ON THIS PROJECT, EXCEPTING LIABILITY ARISING FROM THE SOLE NEGLIGENCE OF THE CITY OR THE CITY ENGINEER.
- ALL LANE WIDTHS SHALL BE MEASURED BETWEEN CENTERLINES OF EACH ADJACENT SINGLE OR DOUBLE STRIPE OR FACE OF CURB AS APPROPRIATE.

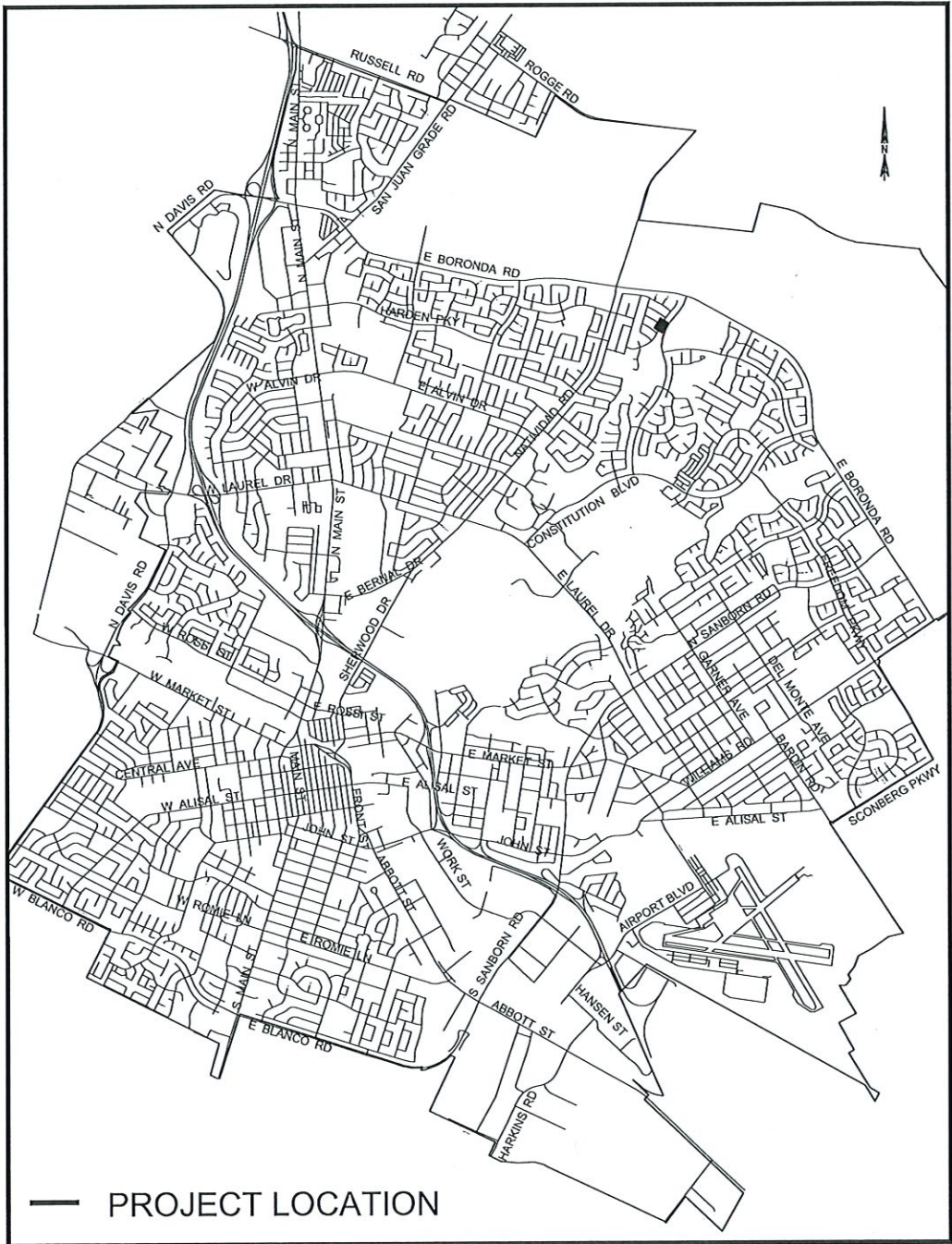

PROJECT LOCATION

LOCATION MAP
NOT TO SCALE

GENERAL NOTES:

- 1) SEE TITLE SHEET FOR GENERAL NOTES AND LEGEND.
2) EXISTING FACILITIES, UTILITIES, ETC. ARE OBSERVED AND WILL NEED TO BE VERIFIED BY THE CONTRACTOR.

CONSTRUCTION NOTES:

- 1 CONSTRUCT TRAFFIC CIRCLE PER DETAIL 1 & 2 ON SHEET 3.
2 INSTALL RUBBER RAISED LANE CURB PER RUBBERFORM SPECIFICATIONS. (N.I.C.)
3 FURNISH AND INSTALL W2-6 AND W16-12P ON TELESAR POST PER DETAIL ON SHEET 3.
4 INSTALL LIMIT LINE PER STATE STANDARD PLAN A24G.
5 INSTALL PAVEMENT MARKING "STOP" PER STATE STANDARD PLAN A24D.
6 INSTALL TYPE VI (L) ARROW PER STATE STANDARD PLAN A24A.
7 INSTALL DETAIL 22 PER STATE STANDARD PLAN A20A.
8 REMOVE EXISTING PAVEMENT TO NATIVE SOIL. SCARIFY 12" DEEP.
9 BACKFILL WITH TOP SOIL. PLACE IN 9" MAX LIFTS. MOUNT TOPSOIL AT CENTER OF CIRCLE 6" ABOVE TOP OF CURB. COMPACT TO 90% RELATIVE.
10 ADJUST EXISTING SANITARY SEWER MANHOLE TO GRADE.

SIGN CHART

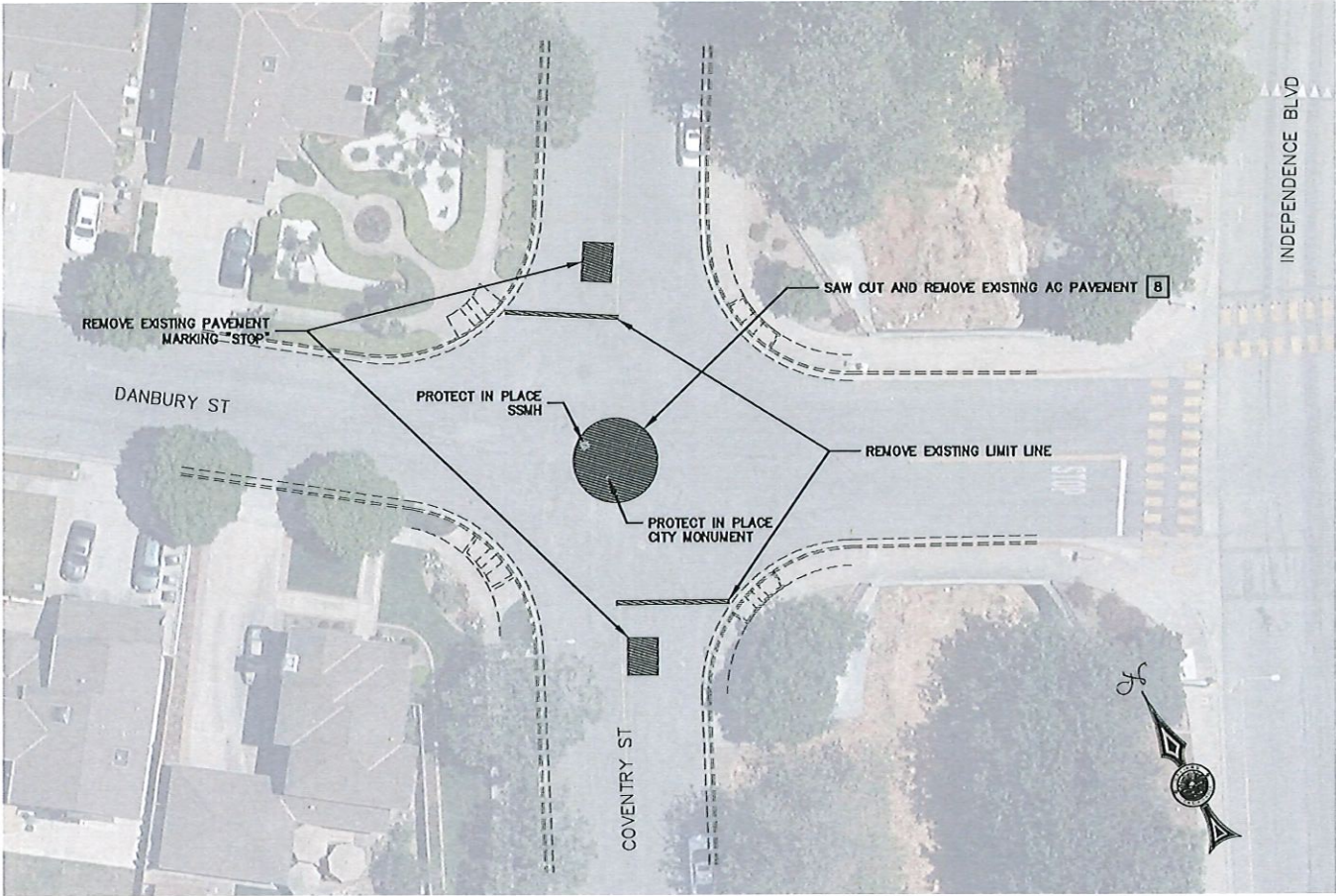
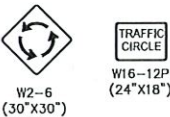

DEMOLITION LAYOUT

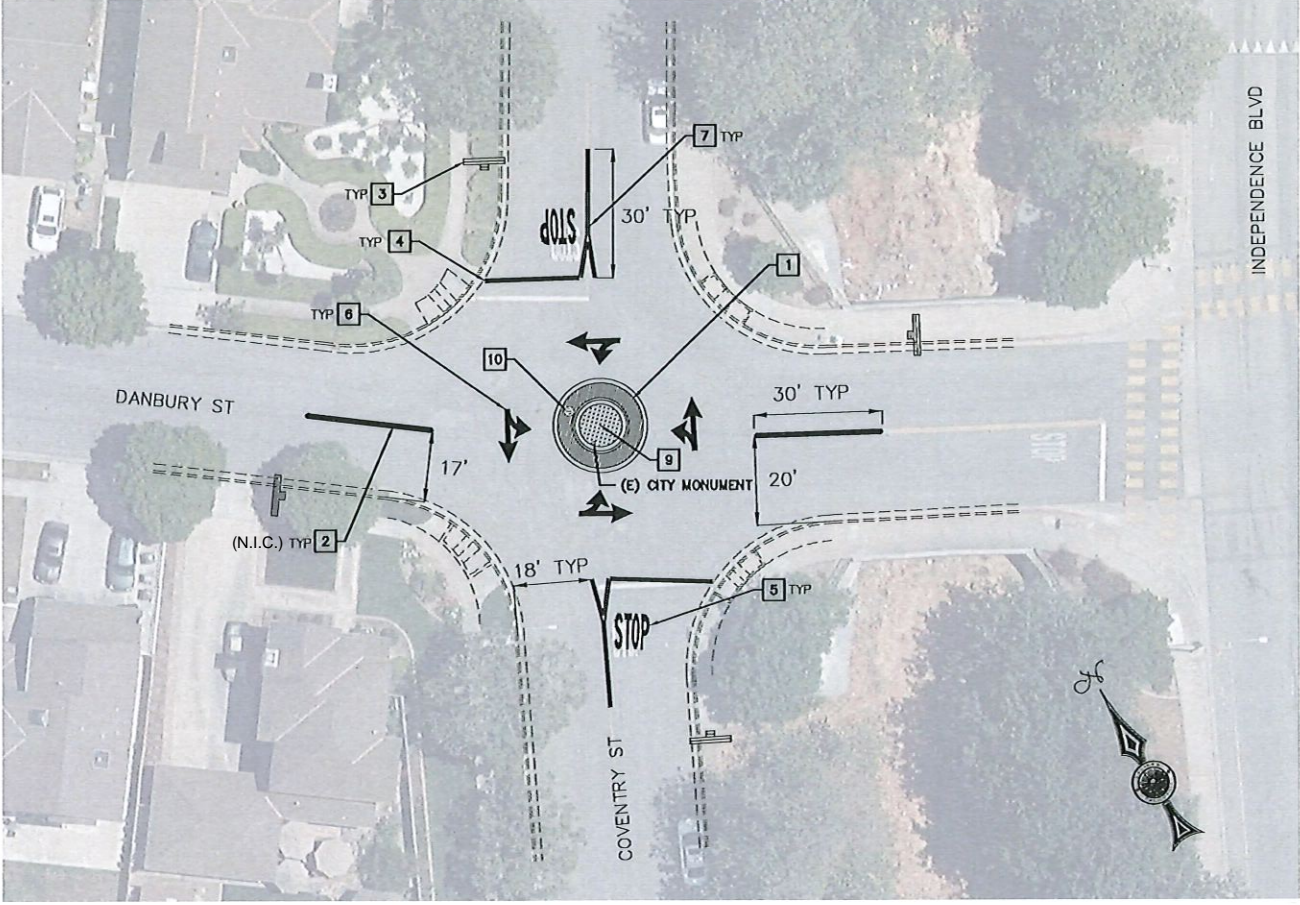

CONSTRUCTION LAYOUT

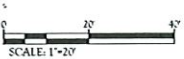

DATE	REVISION	APP.

COVENTRY STREET TRAFFIC CALMING		2
TRAFFIC CIRCLE		3

1	4" OF AGGREGATE BASE.
2	REMOVE EXISTING PAVEMENT TO NATIVE SOIL; SCARIFY 12" DEEP.
3	BACKFILL WITH TOP SOIL PLACED IN 9" MAX LIFTS, MOUND TOPSOIL AT CENTER OF CIRCLE 6" ABOVE TOP OF CURB COMPACT AT 90% RELATIVE.
4	NO.4, 12" STEEL DOWELS AT 4' ON CENTER PER DETAIL C ON CITY STANDARD PLAN 2R.



1. DRAWING NOT TO SCALE.
2. ALL TRAFFIC SIGNS SHALL CONFORM TO THE STATE OF CALIFORNIA MANUAL OF UNIFORM TRAFFIC CONTROL DEVICES (LATEST EDITION).
3. ALL TRAFFIC SIGNS SHALL MEET THE CA-MUTCD RETROREFLECTIVITY STANDARDS. ALL SIGNS SHALL HAVE ANTI-GRAFFITI SHEETING.
4. LETTERS, NUMBERS, SYMBOLS, BORDERS, SIZE AND STROKE SHALL CONFORM TO THE LATEST CALTRANS SIGN SPECIFICATIONS (UNLESS OTHERWISE NOTED).
5. SIGNS SHALL BE CONSTRUCTED OF 0.08" THICK ALUMINUM ALLOY, 6061-T6 OR 5136-H36.
6. ALL SIGNS ERECTED SHALL BE AFFIXED TO POSTS WITH GALVANIZED BOLTS, WASHERS, AND NUTS. THE FACE OF ALL SIGNS SHALL BE PROTECTED BY PLACING EITHER A FIBER OR NEOPRENE WASHER BETWEEN A METAL WASHER NEXT TO THE BOLT HEAD AND THE SIGN FACE. SIGN BACK BRACE SHALL BE USED ON ANY SIGN 36" X 36" OR LARGER.
7. INSTALLED SIGN AND POST SHALL BE PLUMB AND FREE OF VERTICAL AND LATERAL MOVEMENT.
8. ALIGN POST PERPENDICULAR TO PATH OF TRAVEL ± 15 DEGREES.



VICTOR STREET RAISED CROSSWALK

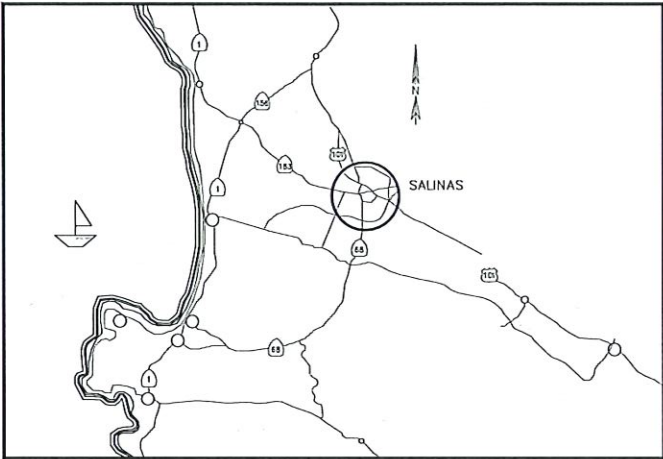

VICINITY MAP
NOT TO SCALE

SHEET INDEX	SHEET NO.
TITLE SHEET	1
DEMOLITION PLAN	2
GRADING PLAN	3
CONSTRUCTION PLAN	4
CONSTRUCTION DETAILS	5-6

EXISTING

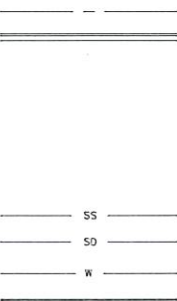

LEGEND

CENTERLINE
CURB AND GUTTER
SIDEWALK
SIGN AND POLE/POST
DETECTABLE WARNING SURFACE
CURB DRAIN
RECTANGULAR DRAINAGE CHANNEL
SANITARY SEWER LINE
STORM DRAIN LINE
WATER
STRIPING
STORM DRAIN MANHOLE
SANITARY SEWER MANHOLE
WATER VALVE
YIELD LINE
TRIPLE FOUR CROSSWALK
AC PAVEMENT
CONTOUR LINES
WOOD BOLLARDS
STREET LIGHT POLE
WATER FLOW

NEW

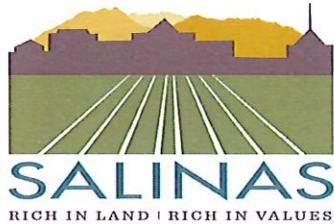

GENERAL NOTES

- EXCEPT AS OTHERWISE SPECIFIED, ALL WORK AND MATERIALS SHALL CONFORM TO AND BE IN ACCORDANCE WITH THE APPLICABLE PROVISIONS OF THE CITY OF SALINAS STANDARD SPECIFICATIONS, DESIGN STANDARDS LATEST EDITION, AND STATE STANDARD PLANS (2024), CA MUTCD (LATEST EDITION) AND CONTRACT SPECIFICATIONS.
- THE EXISTING FACILITIES INDICATED ON THESE PLANS ARE DESIGNATED AS CLOSELY AS POSSIBLE TO REPRESENT EXISTING CONDITIONS. HOWEVER, IT SHALL BE THE CONTRACTOR'S RESPONSIBILITY TO ASCERTAIN THE EXISTENCE AND LOCATION OF ALL UNDERGROUND AND OVERHEAD FACILITIES AND TO PROTECT THEM FROM DAMAGE. THE CONTRACTOR SHALL BEAR TOTAL EXPENSE FOR REPAIR OR REPLACEMENT OF ANY UNDERGROUND OR OVERHEAD FACILITIES DAMAGED BY THEIR OPERATIONS. THE CONTRACTOR SHALL CONTACT U.S.A. (UNDERGROUND SERVICE ALERT, TELEPHONE NUMBER 811) 48 HOURS IN ADVANCE BEFORE PERFORMING ANY TRENCHING AND/OR EXCAVATION WORK.
- ANY EXISTING RAISED PAVEMENT MARKERS, LEGEND, AND/OR STRIPING THAT IS TO REMAIN AND IS DAMAGED AND/OR REMOVED DURING THE STRIPING WORK SHALL BE REPLACED BY THE CONTRACTOR AT THEIR COST PER THE PLANS AND SPECIFICATIONS. ALL REPLACED PAVEMENT MARKINGS AND STRIPING SHALL BE THERMOPLASTIC, PER PROJECT SPECIFICATIONS.
- IN THE EVENT OF ANY CONFLICT OF INFORMATION SHOWN ON THE PLANS, THESE SPECIFICATIONS, ANY CONFLICT BETWEEN THE PLAN AND THE INTENT FOR A CONSISTENT AND FUNCTIONAL FACILITY OR IN THE FIELD THE CONTRACTOR SHALL NOTIFY THE CITY ENGINEER IN WRITING, UPON WHICH TIME THE CITY ENGINEER SHALL RESOLVE THE CONFLICT BY THE ISSUANCE OF A WRITTEN CHANGE ORDER BY REVISING THE PLAN, SPECIFICATIONS AND/OR BOTH. THE CONTRACTOR SHALL BEAR FULL COST AND RESPONSIBILITY FOR WORK AFFECTED BY SUCH UNRESOLVED CONFLICTS AND PERFORMED BY THE CONTRACTOR PRIOR TO THE RESOLUTION BY THE CITY ENGINEER.
- THE CONTRACTOR SHALL EXERCISE ALL NECESSARY CAUTION TO AVOID DAMAGE TO ANY EXISTING TREES, LANDSCAPE, UTILITIES AND/OR SURFACE IMPROVEMENTS WHICH ARE TO REMAIN IN PLACE, AND SHALL BEAR FULL RESPONSIBILITY FOR ANY DAMAGE THERETO.
- THE CONTRACTOR IS RESPONSIBLE TO ENSURE THAT FINISHED AREAS OF THE PROJECT ARE PROTECTED FROM ANY DAMAGE, WHICH MAY RESULT FROM ADJACENT AREAS STILL UNDER CONSTRUCTION.
- ALL WORK TO BE SCHEDULED AND COORDINATED BY THE CONTRACTOR WITH THE CONSTRUCTION ACTIVITIES OF THE UTILITY COMPANIES AND/OR ANY OTHER CONTRACTOR(S) WORKING IN THE AREA.
- THE CONTRACTOR AGREES THAT THEY SHALL ASSUME SOLE AND COMPLETE RESPONSIBILITY FOR JOB SITE CONDITIONS, INCLUDING THE SAFETY OF PERSONS AND PROPERTY, DURING THE COURSE OF CONSTRUCTION OF THIS PROJECT AND THAT THIS REQUIREMENT SHALL APPLY CONTINUOUSLY AND NOT BE LIMITED TO NORMAL WORKING HOURS. THE CONTRACTOR SHALL DEFEND, INDEMNIFY AND HOLD THE CITY AND THE CITY ENGINEER HARMLESS FROM ANY AND ALL LIABILITY, REAL OR ALLEGED, IN CONNECTION WITH THE PERFORMANCE OF WORK ON THIS PROJECT, EXCEPTING LIABILITY ARISING FROM THE SOLE NEGLIGENCE OF THE CITY OR THE CITY ENGINEER.
- THE CONTRACTOR SHALL FURNISH AND INSTALL ALL MATERIALS, EQUIPMENT, LABOR AND INCIDENTAL FOR THE PROJECT EXCEPT AS SHOWN N.I.C., OR CITY FURNISHED MATERIAL.
- ALL QUANTITIES AS SHOWN ON THE PLANS ARE APPROXIMATE ONLY AND FOR THE CONTRACTOR'S INFORMATION ONLY. THE CITY OF SALINAS DOES NOT, EXPRESSLY OR BY IMPLICATION, AGREE THAT THE ACTUAL AMOUNT OF WORK SHALL CORRESPOND THEREWITH. PAYMENT SHALL BE MADE ONLY ON THE BASIS OF THE ACTUAL QUANTITIES OF WORK PERFORMED.
- ALL LANE WIDTHS SHALL BE MEASURED BETWEEN CENTERLINES OF EACH ADJACENT SINGLE OR DOUBLE STRIPE OR FACE OF CURB AS APPROPRIATE.

ABBREVIATIONS

BW BACK OF WALK
DWY DRIVEWAY
EP EDGE OF PAVEMENT
FL FLOW LINE
G GROUND
LIP LIP OF GUTTER
P PAVEMENT ELEVATION
TC TOP OF CURB
TYP TYPICAL
S/W SIDEWALK



Know what's below.
Call before you dig.

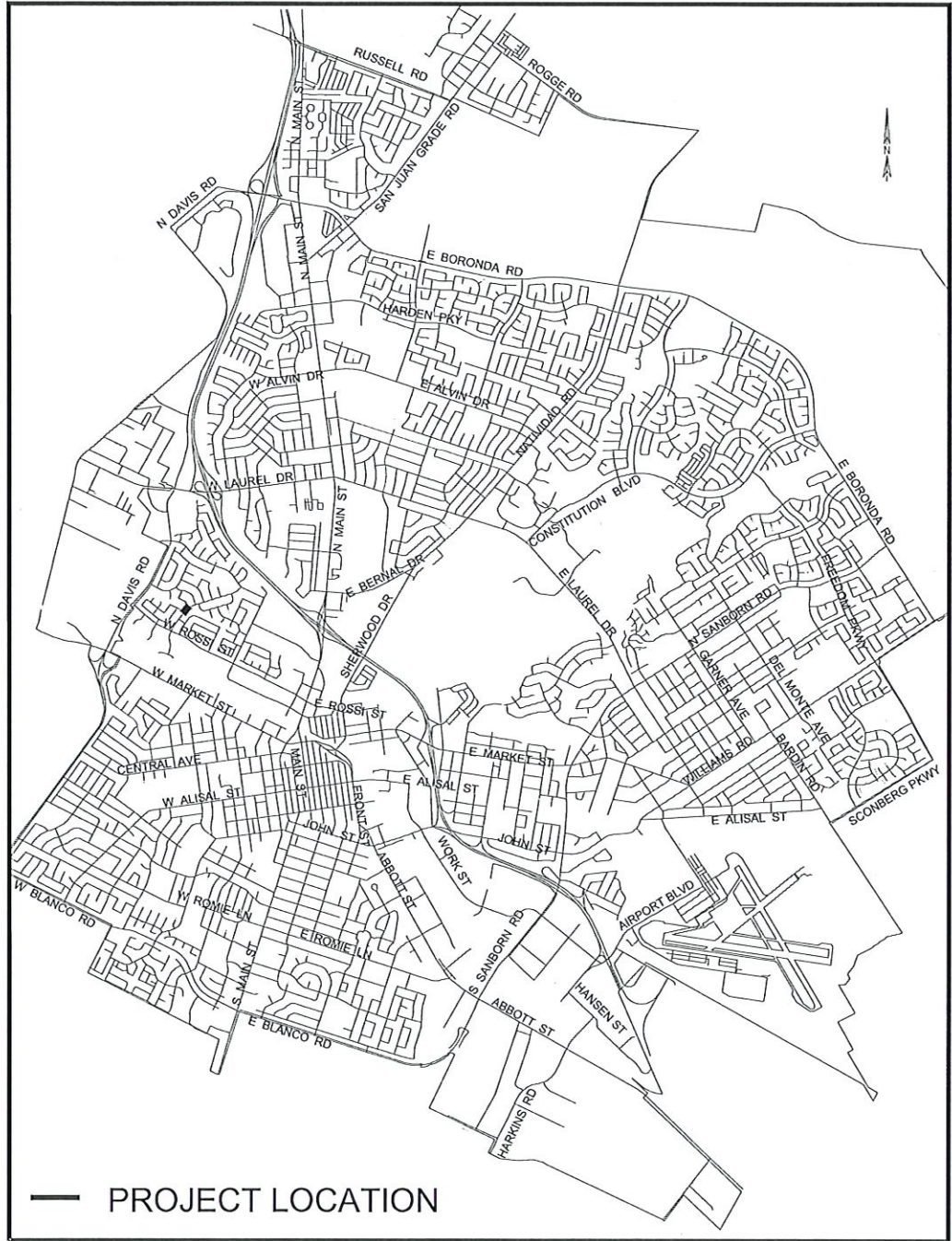

PROJECT LOCATION

LOCATION MAP
NOT TO SCALE

SHEET NOTES

1) SEE TITLE SHEET FOR GENERAL NOTES AND LEGEND.

CONSTRUCTION NOTES

- 1 SAW CUT REMOVE CONCRETE SIDEWALK TO NEAREST JOINT.
- 2 SAW CUT REMOVE CURB AND GUTTER.
- 3 SAW CUT REMOVE AC PAVEMENT TO AGGREGATE BASE. RECOMPACT EXISTING AGGREGATE BASE TO 95% RC.
- 4 REMOVE AND SALVAGE EXISTING STREET SIGN. DISPOSE OF POLE.
- 5 PROTECT IN PLACE EXISTING WOOD BOLLARDS AND FOUNDATION.
- 6 SAW CUT REMOVE AC PATHWAY TO AGGREGATE BASE. RECOMPACT AGGREGATE BASE TO 95% RC.
- 7 CONTRACTOR SCARIFY TOP 12" OF ORGANIC MATERIAL.

LEGEND

- REMOVE CONCRETE
- REMOVE AC PAVEMENT

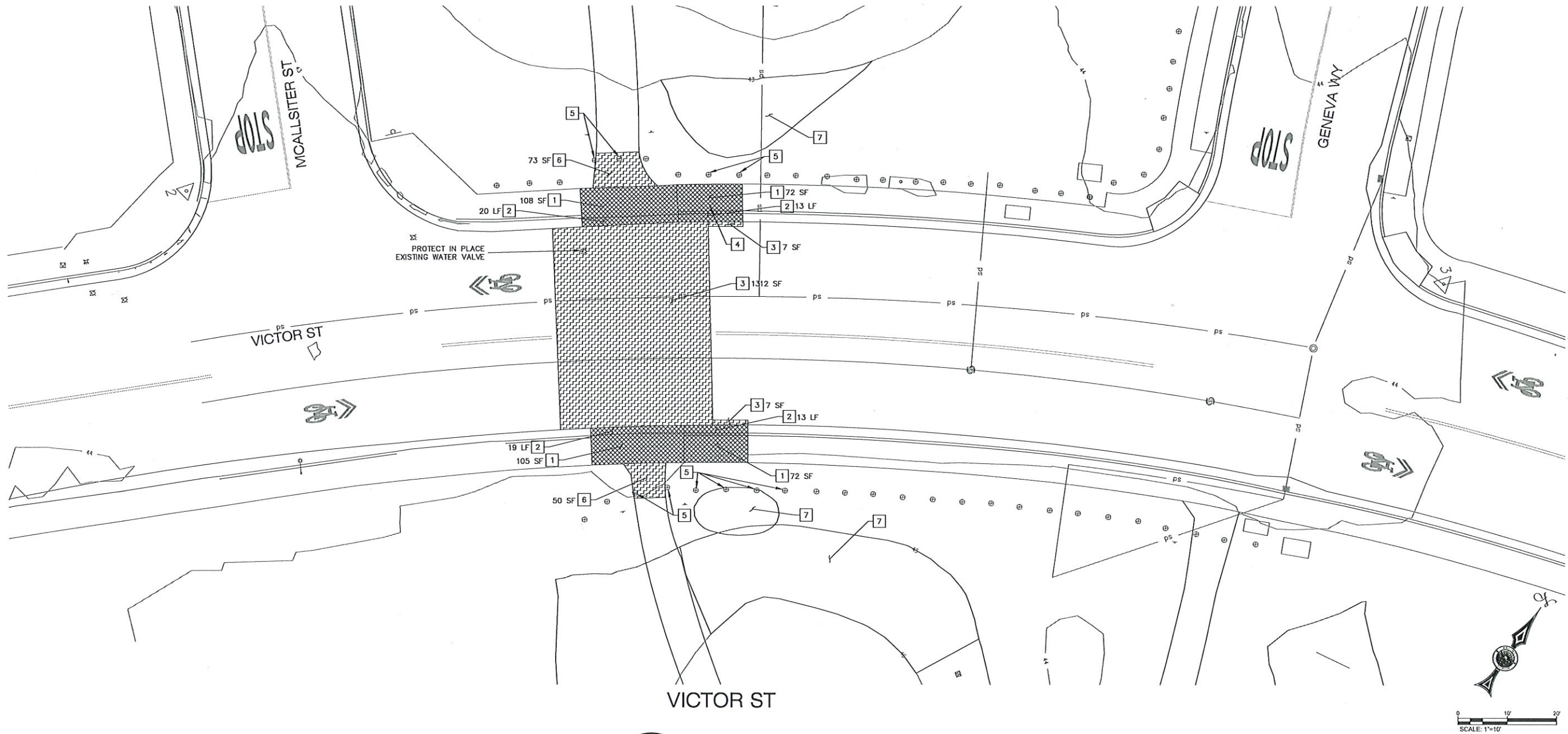

DATE	REVISION	APP.

SHEET NOTES

1) SEE TITLE SHEET FOR GENERAL NOTES AND LEGEND.

GRADING NOTES

1) SLOPES SHALL BE KEPT TO A 5:1

LEGEND

- 45 EXISTING CONTOURS
- 45 PROPOSED FINISH CONTOURS
- GRADE BREAK
- $\frac{-197.30}{TC}$ EXISTING ELEVATION
- $\frac{-197.30}{TC}$ PROPOSED ELEVATION

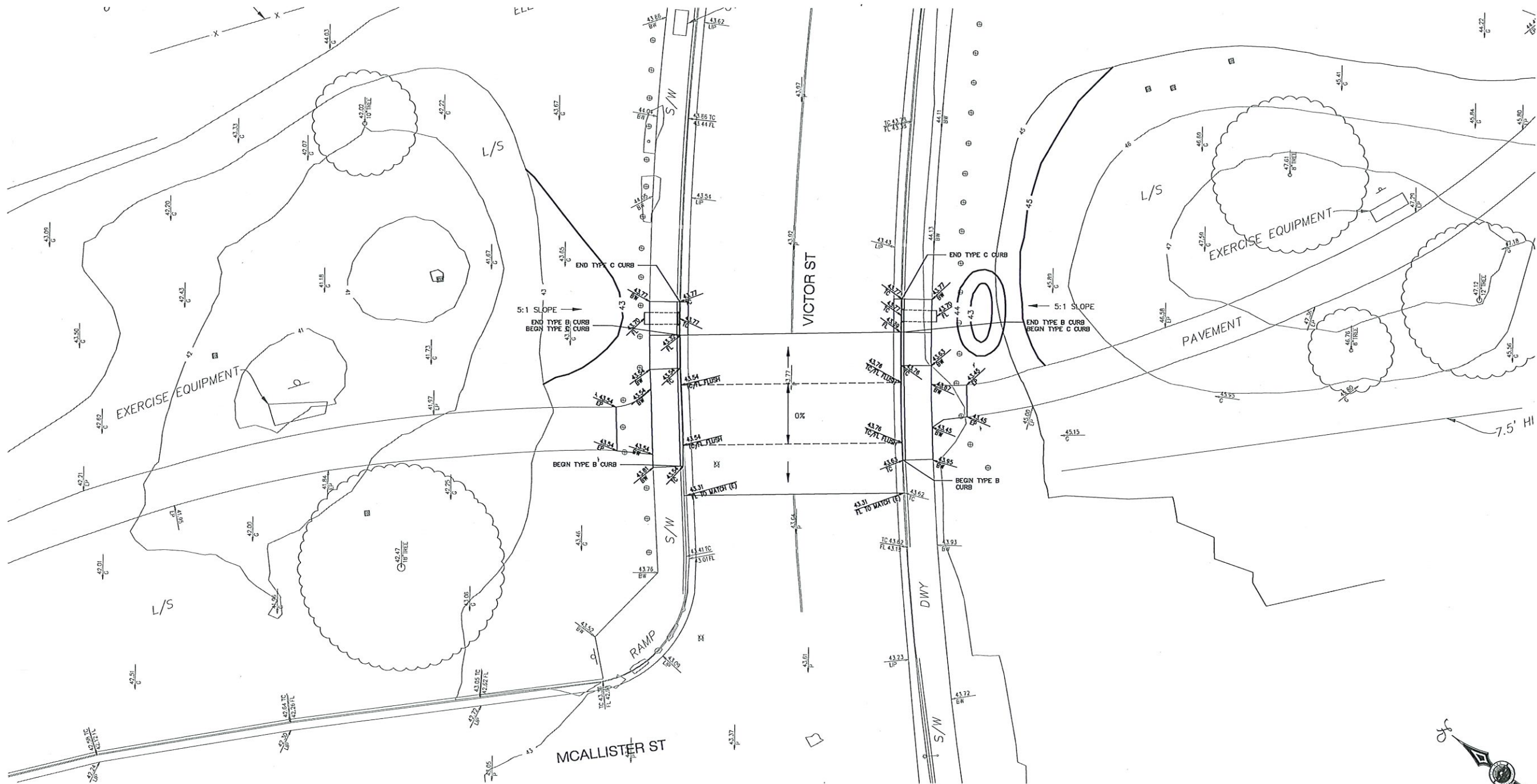

DATE	REVISION	APP.

SHEET NOTES

1) SEE TITLE SHEET FOR GENERAL NOTES AND LEGEND.

CONSTRUCTION NOTES

- 1 CONSTRUCT RAISED CROSSWALK PER DETAIL 1 ON SHEET 5.
- 2 FURNISH AND INSTALL DETECTABLE WARNING SURFACE PER DETAIL 1 ON SHEET 5.
- 3 CONSTRUCT CONCRETE SIDEWALK PER CITY STD PLAN NO. 2R.
- 4 CONSTRUCT TYPE "B" CURB PER CITY STD PLAN NO. 1.
- 5 CONSTRUCT TYPE "C" CURB AND GUTTER PER CITY STD PLAN NO. 1.
- 6 INSTALL ASPHALT CONCRETE PAVEMENT OVER AGGREGATE BASE, SECTION TO MATCH EXISTING.
- 7 FURNISH AND INSTALL W11-2 AND W16-7P ON NEW POST.
- 8 FURNISH AND INSTALL R1-5 ON NEW POST.

- 9 FURNISH AND INSTALL CURB DRAIN CURB-O-LET AND RECTANGULAR DRAINAGE CHANNEL PER MANUFACTURER'S SPECIFICATIONS AND DETAIL 3 ON SHEET 6.
- 10 INSTALL ASPHALT CONCRETE PATHWAY ABOVE EXISTING AGGREGATE BASE PER DETAIL 2 ON SHEET 6.
- 11 PLACE ROUNDED WASHED COBBLE SPLASH PER DETAIL 3 ON SHEET 6.
- 12 INSTALL SALVAGED STREET SIGN ON NEW POST.
- 13 FURNISH AND INSTALL RAISED CROSSWALK WARNING SIGN ON EXISTING STREET LIGHT POLE.
- 14 FURNISH AND INSTALL RAISED CROSSWALK WARNING SIGN ON NEW POST.
- 15 CONTRACTOR TO COORDINATE WITH UTILITY COMPANY FOR ADJUSTMENT OF EXISTING WATER VALVE TO NEW GRADE.

SIGN CHART



RAISED
CROSSWALK
WARNING SIGN
(30"x30")



W11-2
(30"x30")



W16-7P
(24"x12")



R1-5
(36"x36")

RAISED CROSSWALK WARNING SIGN

SIGN DIMENSIONS	COLOR CODE		
	BACKGROUND	MESSAGE	BORDER
30"x30"	FLUORESCENT-YELLOW	BLACK	BLACK

LEGEND

- CONCRETE
- AC PATHWAY
- AC PAVEMENT
- COBBLESTONE

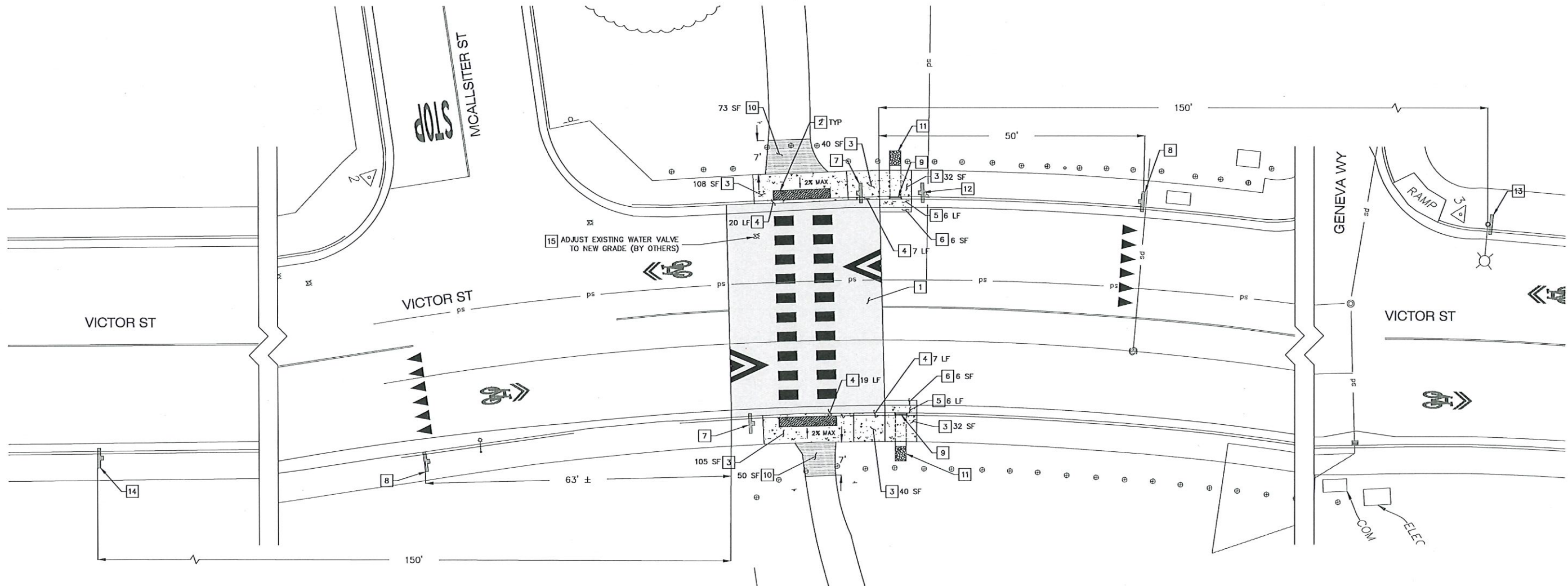

0 10' 20'
SCALE: 1"=10'

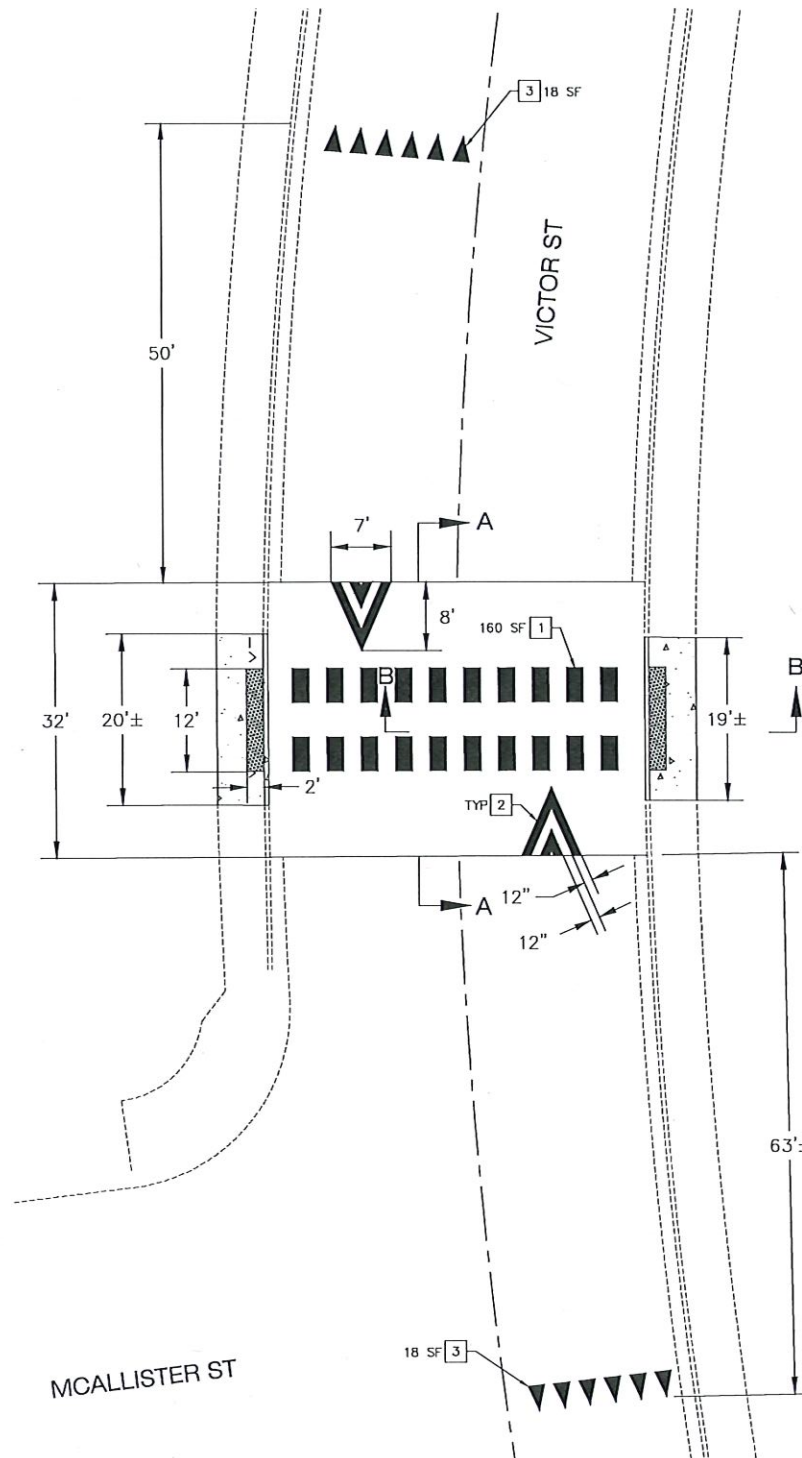

CONSTRUCTION NOTES

- 1 INSTALL WHITE TRIPLE FOUR THERMOPLASTIC PAVEMENT MARKING PER STATE STD PLAN A24F.
- 2 INSTALL CUSTOM WHITE THERMOPLASTIC MARKINGS.
- 3 INSTALL WHITE THERMOPLASTIC YIELD BAR PER STATE STD PLAN A24G.

1 RAISED CROSSWALK
SCALE 1:10

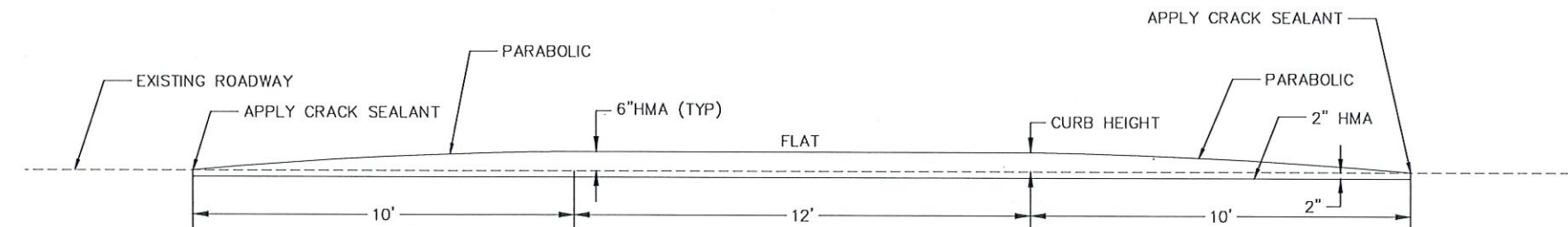

SECTION A-A
SCALE 1:2

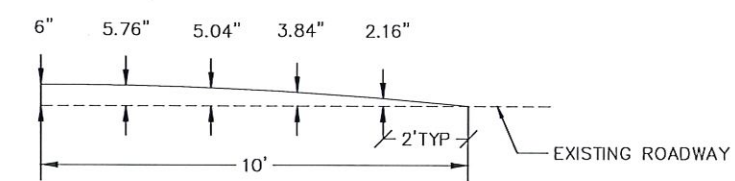

PARABOLIC SECTION
SCALE 1:2

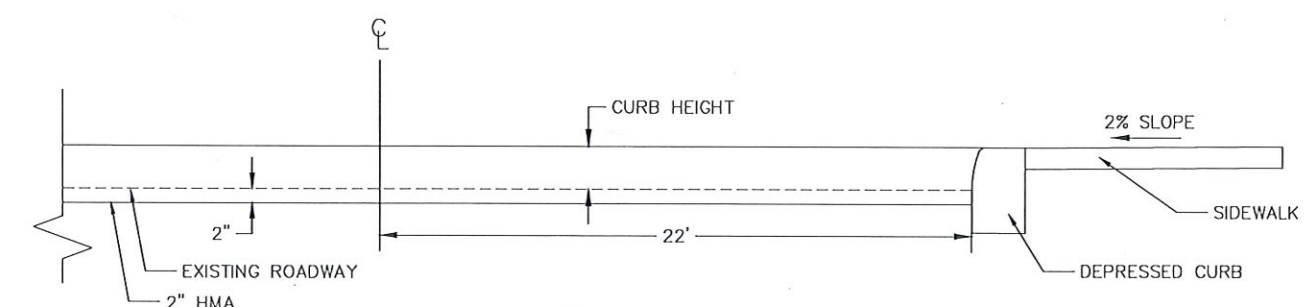

SECTION B-B
N.T.S.

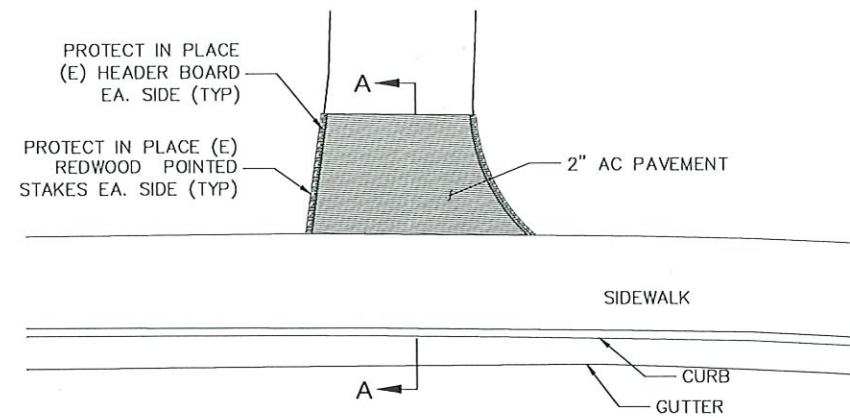

② A.C. PATHWAY (TYP.)
SCALE 1:5

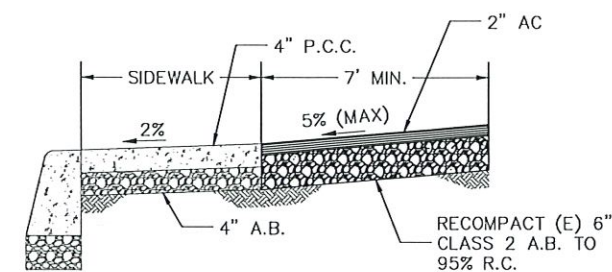

A.C. PATHWAY SECTION A-A
N.T.S.

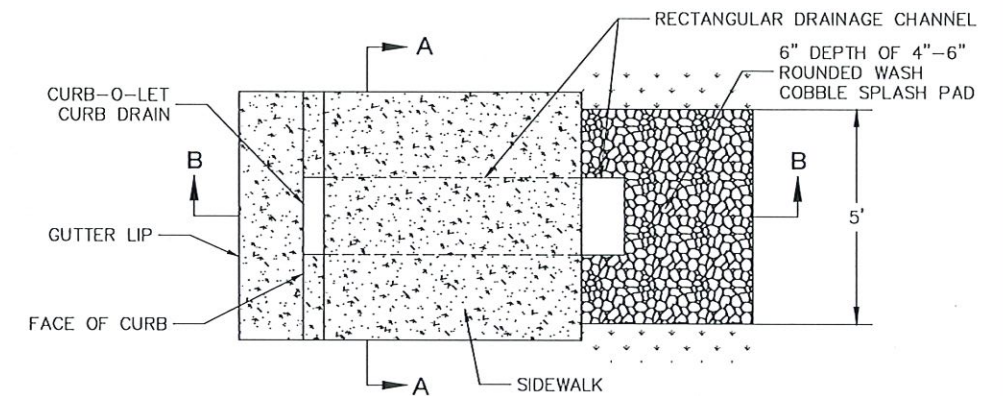

③ CURB DRAIN
SCALE 1:2

GENERAL NOTES

1. DRAWING NOT TO SCALE.
2. ALL TRAFFIC SIGNS SHALL CONFORM TO THE STATE OF CALIFORNIA MANUAL OF UNIFORM TRAFFIC CONTROL DEVICES (LATEST EDITION).
3. ALL TRAFFIC SIGNS SHALL MEET THE CA-MUTCD RETROREFLECTIVITY STANDARDS. ALL SIGNS SHALL HAVE ANTI-GRAFFITI SHEETING.
4. LETTERS, NUMBERS, SYMBOLS, BORDERS, SIZE AND STROKE SHALL CONFORM TO THE LATEST CALTRANS SIGN SPECIFICATIONS (UNLESS OTHERWISE NOTED).
5. SIGNS SHALL BE CONSTRUCTED OF 0.08\"/>

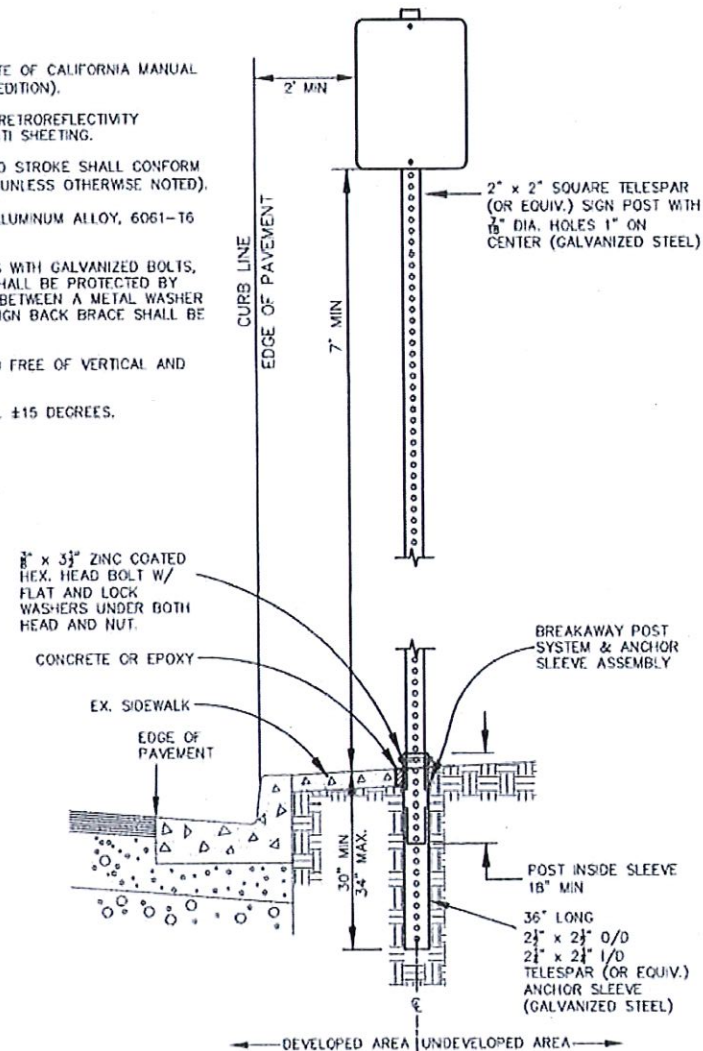

④ POST DETAIL
N.T.S.

NOTES:

1. CURB DRAIN SHALL BE CURB-O-LET TCD317-NS-INLET-1/8\"/>

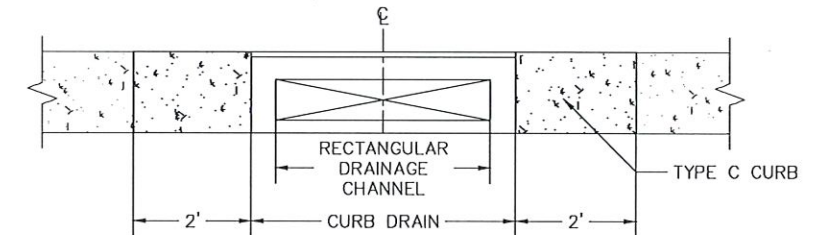

CURB DRAIN SECTION A-A
SCALE 1:2

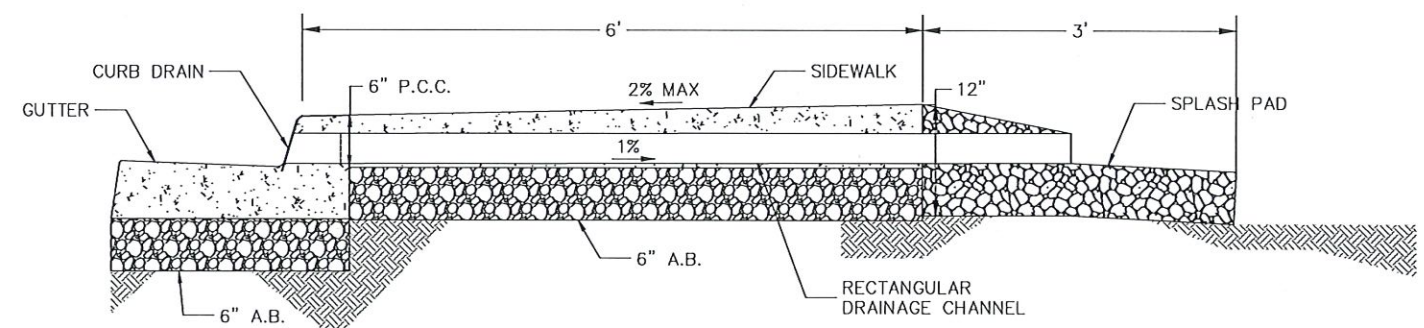

NOTES:

1. RECTANGULAR DRAINAGE CHANNEL FORM SHALL BE SUPPORTED DURING POURING OF CONCRETE.

CURB DRAIN SECTION B-B
N.T.S.



CITY OF SALINAS

PUBLIC WORKS DEPARTMENT

DESIGNED BY:
J. HERNANDEZ
GEO. BY:
J. HERNANDEZ
CONSTRUCTION INSPECTION SUPERVISOR:
G. RODRIGUEZ
APPROVED FOR CONSTRUCTION:
DATE: 4/13/25
ADRIANA ROBLES, P.E., C.F.M.
CITY ENGINEER



REVIEWED BY:
DATE:
OSCAR ESPINOZA, P.E.
SENIOR ENGINEER

DATE	REVISION	APP.

VICTOR STREET RAISED CROSSWALK

CONSTRUCTION DETAILS

PROJECT NO.	9163	SHEET NO.	6
DRAWN BY	JONATHAN HERNANDEZ	CHECKED BY	
DATE	4/26/25 2:35 PM		