



# City of Salinas

DEVELOPMENT ENGINEERING (PW) • 65 West Alisal Street • Salinas, California

Phone: (831) 758-7251 • [www.cityofsalinas.org](http://www.cityofsalinas.org)



## ENCROACHMENT PERMIT & APPLICATION

### CITY USE ONLY

PERMIT NO.: ENC20-0659

ISSUE DATE: 10/22/2020

EXPIRATION DATE: 04/22/2021

☒ PUBLIC IMPROVEMENT PLANS ☐ 50/50 PROGRAM ☐ FIBER ☐ SMALL CELL (LUMINAIRE) ☐ SMALL CELL (PRIVATE POLE)

☐ CONSTRUCTION – PRIVATE FACILITIES

☒ CONSTRUCTION – PUBLIC FACILITIES

☐ REVISION PERMIT #: \_\_\_\_\_

☐ OTHER: \_\_\_\_\_

### APPLICANT INFORMATION: Complete all fields

NAME: Teri Nelson

EMAIL: [tnelson@vc-inc.net](mailto:tnelson@vc-inc.net)

MAILING ADDRESS: 550 Greenville Rd

PHONE: (925) 245-1300

Livermore, CA 94550

CELL: (925) 290-9007

PROJECT LOCATION: 450 E Romie Lane

PROJECT DESCRIPTION: Mid Block Crossing Improvements on E Romie Lane: Raised Median, ADA compliant Ramps, Striping

(Include duration) \_\_\_\_\_

### CONTRACTOR INFORMATION: Complete all fields

CONTRACTOR NAME: FBD Vanguard Construction Inc.

EMAIL: [tnelson@vc-inc.net](mailto:tnelson@vc-inc.net)

ADDRESS: 550 Greenville Rd

PHONE: \_\_\_\_\_

Livermore, CA 94550

ONSITE CONTACT NO.: \_\_\_\_\_

CONTRACTOR LICENSE: 833032

EXPIRATION DATE: 02/28/2022

TYPE: A ☐ B ☒ C- 8

CITY BUSINESS LICENSE: pending

EXPIRATION DATE: \_\_\_\_\_

### ENCROACHMENT TYPE:

CHECK AND COMPLETE ALL APPLICABLE FIELDS

### INSPECTIONS REQUIRED:

CITY USE ONLY

DATE:

INITIALS:

<input type="checkbox"/> UTILITIES (LF)		<input checked="" type="checkbox"/> PRE-CONSTRUCTION MEETING		
<input checked="" type="checkbox"/> SIDEWALK (SF)	280	<input checked="" type="checkbox"/> TRAFFIC CONTROL		
<input checked="" type="checkbox"/> CURB & GUTTER (LF)	125	<input checked="" type="checkbox"/> BASE/SUBGRADE		
<input checked="" type="checkbox"/> ADA RAMP (EA)	2	<input checked="" type="checkbox"/> FORMS/REBAR		
<input type="checkbox"/> DRIVEWAY APPROACH (EA)		<input type="checkbox"/> UTILITIES		
<input checked="" type="checkbox"/> LANE CLOSURE (LF)	300	<input checked="" type="checkbox"/> SIGNS/STRIPING		
<input type="checkbox"/> PARKING SPACE CLOSURE (EA)		<input type="checkbox"/> LANDSCAPING/IRRIGATION		
<input type="checkbox"/> FIBER (LF)/SMALL CELL (EA)		<input checked="" type="checkbox"/> ASPHALT/CONCRETE		
<input checked="" type="checkbox"/> OTHER: PAVEMENT (SF)	1,600	<input checked="" type="checkbox"/> FINAL INSPECTION		

\* INSPECTION SHALL BE REQUESTED 24 HOURS PRIOR TO COMMENCEMENT OF WORK.

\* EMAIL [ENCROACHMENT@CI.SALINAS.CA.US](mailto:ENCROACHMENT@CI.SALINAS.CA.US) TO SCHEDULE INSPECTIONS.

\* UNINSPECTED WORK WILL RESULT IN A CITATION AND IS SUBJECT TO BEING REJECTED.

### ACKNOWLEDGEMENT & SIGNATURE

I understand the State of California Contractors License Requirements.

I have read the General Conditions attached to this application and will comply with them, any special conditions, and all provisions of the City of Salinas Municipal Code. Note: Applicant must sign and submit Page 5 of Permit Conditions.

Teri Nelson - FBD Vanguard Construction Inc.

CONTRACTOR/UTILITY  
REPRESENTATIVE NAME

SIGNATURE

10/07/2020

DATE



# City of Salinas

DEVELOPMENT ENGINEERING (PW) • 65 West Alisal Street • Salinas, California

Phone: (831) 758-7251 • [www.cityofsalinas.org](http://www.cityofsalinas.org)

## **Encroachment Permit** **General Conditions of Approval**

*NOTE: Below are general requirements for work within all public rights of way or city property. In addition to these requirements, the permittee must also comply with all the terms, conditions, rules, and procedures of the Encroachment Ordinance, Encroachment Agreement, and the Standard Specifications and Standard Plans (“City of Salinas Standards”) of the City of Salinas.*

- 1. Encroachment Permit Compliance Required.** No person shall make a right-of-way encroachment or cause any street cut to be made without having secured the proper permit. All work shall be performed in strict compliance with the terms and conditions of this permit. (City of Salinas Municipal Code Article V).
- 2. Failure to Comply.** Failure to comply with the requirements of this permit may result in one or more of the following:
  - A. The City Inspector shall issue a citation(s) at the expense of the Permittee.
  - B. The City Engineer shall order immediate suspension of work until non-compliance is resolved.
  - C. Should the Permittee or the Permittee’s contractor fail to correct the non-compliance, the City Engineer may cause removal and replacement of deficient work and/or completion of work to bring the project into compliance at the Permittee’s expense.
  - D. The City Engineer shall cause traffic controls to be set, as deemed necessary by the City Engineer, at the expense of the Permittee.
  - E. If the City Engineer deems emergency repairs necessary, he or she will attempt to notify the Permittee. If the Permittee cannot be contacted or fails to respond in a timely fashion, the City Engineer shall cause the work to be done at the Permittee’s expense.

Where corrective work described above is ordered by the City Engineer, the cost of that work shall be charged to the Permittee on a Labor, Equipment and Materials basis plus overhead to reimburse the City for its actual costs.

- 3. Notification.** The Permittee shall notify the City at least seventy-two (72) hours prior to start of work and at that time shall provide a project schedule. Permittee shall notify the Police Department, Fire Department, Emergency Service Agencies and the Monterey Salinas Transit (MST), of all work that may impede the passage of emergency vehicles and public transportation. Temporary “No Parking” signs shall be posted by the Contractor at least seventy-two (72) hours prior to commencement of work. Signs shall state days and hours when restrictions apply.
- 4. Inspection.** Work shall be inspected as indicated on the permit. To request an inspections, email [encroachment@ci.salinas.ca.us](mailto:encroachment@ci.salinas.ca.us) at least twenty-four (24) hours in advance of requested inspection time. Inspection requests shall reference encroachment permit number, type of inspection, time of inspection (AM or PM) and an onsite contact phone number if different than in the application/permit. Inspections shall be scheduled Monday through Friday, except holidays, from 8:00 AM. to 4:30 PM. No work requiring inspection shall be conducted on City observed holidays. Uninspected work will result in a citation and is subject to being rejected by the City Engineer.

- 5. Emergency Work.** A permit for emergency work shall be secured no later than five (5) business days following commencement of the emergency work. All emergency shall require the Permittee/Contractor to notify the City prior to commencement of emergency work by emailing [encroachment@ci.salinas.ca.us](mailto:encroachment@ci.salinas.ca.us).
- 6. Unknown Underground Facility.** If an unknown underground facility is encountered, work shall cease immediately, and both the City Engineer and the utility believed to own the facility shall be notified. Work shall not proceed until permit is granted by the City Engineer.
- 7. Posting.** The Permittee must keep the signed permit at the worksite or on the premises of the encroachment at all times.
- 8. Emergency Call-out.** A Permittee shall provide a twenty-four (24) hour emergency telephone number on the application and shall display its company name and emergency telephone number on its barricades. Failure to respond to an incident promptly shall require corrective measures by the City, the cost of which shall be borne by the Permittee.
- 9. Standards.** Work shall be constructed in accordance with applicable ordinances, codes, and City of Salinas Standards. A copy of the City of Salinas Standards can be acquired at the following link: [https://www.cityofsalinas.org/sites/default/files/departments\\_files/public\\_works\\_files/2008citystandards.pdf](https://www.cityofsalinas.org/sites/default/files/departments_files/public_works_files/2008citystandards.pdf).
- 10. Access.** The Permittee shall provide access to all areas in the vicinity of the encroachment and shall provide necessary temporary sidewalk and warning signs.
- 11. Public Safety.** The Permittee shall furnish, erect, and maintain barricades, lights, signs, flagmen, fencing, and other safety measures to give adequate protection to the public at all times. Failure of the Permittee to set required warning devices may result in a project shutdown, citation(s) and charges to the Permittee for costs incurred by the City.
- 12. Site Maintenance.** Work areas shall be maintained in a neat, clean and safe condition at all times. Debris shall be removed daily. The site shall be treated for dust control as necessary. Dirt tracked from the work site shall be cleaned from City streets, curbs, gutters, and sidewalks. The flushing of dirt and debris to storm drain or sanitary sewer facilities is strictly prohibited. The Permittee shall employ construction practices that will prevent pollutants such as mud, silt, chemical residue, and washings from concrete and saw cutting from entering storm drains. The site shall be properly secured during non-work hours.
- 13. Travel Lane & Sidewalk Closures.** The Permittee shall assure that all City streets, travel lanes, and sidewalks remain open at all times, unless a traffic control plan has been approved in advance by the City Engineer or his or her representative. A traffic control plan shall be submitted to the City Engineer or his or her representative for review and approval with Encroachment Permit Application.

Depending on project scope and site conditions, traffic control plans may need to be prepared by a California-licensed Traffic Control Firm. Traffic control plans must follow the current edition of the California Manual on Uniform Traffic Control Devices (CA MUTCD). Plans must be specific to the project site and conditions and phased, as appropriate, to the address construction of project improvements. Sample plans are not allowed.

City approval of the traffic control plan must precede notification of any closures. The City Engineer shall be notified of closure dates and duration at least five (5) working days in advance of proposed closure.
- 14. Work Hours.** All work in the public right-of-way is restricted to non-holiday weekdays 8:00 AM to 4:00 PM except as noted in Special Conditions of Approval or Construction Guidelines for Continuing Encroachment Installations, if applicable. Work is not allowed on weekends and City holidays.

- 15. Excavations.** All trenches created in existing pavement shall be neatly saw cut. Trench spoils shall be removed from the job site. Backfill shall consist of sand or approved granular material compacted to ninety-five percent (95%) Relative Compaction. Excavations within the public right-of-way shall be backfilled, compacted, and temporarily paved with cold mix “cut back” type A.C. prior to 4:00 PM to allow for vehicular and pedestrian traffic. The use of non-skid trench plates is allowed, provided the Contractor covers all the edges of the plates with cold mix material. It shall be the Permittee’s and the Contractor’s responsibility to maintain on a daily basis, including weekends and holidays, the amount of material necessary to maintain the trench surface flush with the existing street or sidewalk. In addition, the Contractor shall respond to and correct shifting trench plates regardless of the time of day. If Contractor fails to correct sinking backfill material or shifting trench plates in a timely manner, City reserves the right to correct the problem at the expense of the Contractor. All trenches shall be fully restored within thirty (30) days of first street cut.
- 16. Vehicle & Pedestrian Traffic.** The Permittee shall follow Caltrans standards for traffic control. The parking of any construction-related vehicles or storage of any material is not allowed on a public street or sidewalk unless approved in advance by the City Engineer.
- 17. Construction Staging Areas.** Proposed locations of construction staging areas shall be approved by the City Engineer. Any construction staging area proposed outside of the public right-of-way shall be disallowed unless the Permittee has secured the prior written approval of the property owner. Any construction staging proposed on public lands shall require a license agreement from the City.
- 18. Street Cuts.** No street pavement shall be cut unless specifically approved in writing pursuant to an Encroachment Permit. Trench restoration shall be according to the City of Salinas Standards, except as modified by additional Special Conditions of Approval or a design by a licensed civil engineer approved by the City Engineer. The Permittee shall use boring and jacking as an alternative to open cut of streets if required by the City Engineer.
- 19. Hazardous Materials.** The Permittee is responsible for satisfying all applicable procedures and regulations in the event hazardous materials are encountered. This includes notification to emergency phone number 911.
- 20. Monument Preservation.** Any City monument damaged, displaced, or destroyed by Permittee’s work shall be replaced by a State of California licensed land surveyor at Permittee’s sole expense. Location of any conflicting monuments shall be tied out prior to start of work.
- 21. Removal of Markings.** All sidewalk and/or pavement markings painted by Underground Services Alert (USA), utility companies, or Permittee shall be removed to the satisfaction of the City Engineer with ten (10) working days after completion of construction.
- 22. Traffic Striping and Pavement Markings.** Any traffic striping and/or pavement markings damaged or destroyed by Permittee’s work shall be replaced by Permittee to the satisfaction of the Traffic Engineer at Permittee’s sole expense.
- 23. Other Regulations.** It is the Permittee’s responsibility to comply with all City laws and regulations and to obtain all necessary permits. Such laws, regulations, and permits include, but are not limited to, the City Business License, Americans with Disabilities Act (ADA) and Division of Occupations Safety & Health Standards.
- 24. City License.** Contractors and Subcontractors must obtain a City of Salinas Business License.
- 25. Contractor License.** Contractors and Subcontractors must provide valid contractor license issued by the Contractors State License Board. Contractors may only execute work within their licensing classifications.

- 26. Bonding.** Any project requiring a Public Improvement Plan shall be responsible for furnishing a performance bond to be executed in the face amount of not less than one hundred fifty percent (150%) of the total construction cost.
- 27. As-Built.** Permittee shall provide as-built drawings showing any improvements or changes to city owned facilities.
- 28. Insurance.** The Permittee is responsible of furnishing a Certificate of Insurance with proper endorsements. Proof of liability insurance in the amount of \$1,000,000 naming the City of Salinas with endorsement sheets attached is required.
- 29. Indemnification.** To the fullest extent permitted by law, Permittee shall defend through counsel approved by City, indemnify, and hold harmless the City of Salinas, its officers, officials, representatives, agents, employees, and volunteers against any and all suits, damages, costs, fee, claims, demands, cause of action, losses, liabilities and expenses, including without limitation attorneys' fees, to the extent arising or resulting directly or indirectly from any act, errors or omissions of Permittee or Permittee's assistants, employees or agents, including all claims relating to the injury or death of any person or damage to any property.
- 30. Permit Commencement and Duration.** This permit is valid for the six (6) months from the date of issuance unless stated otherwise in the Special Conditions of Approval. This Permit will become void if work has not begun within ninety (90) days from date of issuance. Final inspection and acceptance of work shall close this Permit.
- 31. Time Extension.** If the expiration date stated on the permit will be exceeded, an extension request must be sent to [encroachment@ci.salinas.ca.us](mailto:encroachment@ci.salinas.ca.us) and approved by the City Engineer prior to the expiration date. The new work schedule shall be indicated on the request. Permit extensions will be limited to no more than two (2), one (1) month extensions from the original expiration date.
- 32. One-Year Warranty.** The Permittee shall assume a one (1) year warranty period from the date of acceptance for all material and workmanship for all work performed under this Permit in the City right-of-way. Between thirty (30) and forty-five (45) days after notice of completion, the Permittee shall check for trench settlement and make necessary adjustment, if any, and then call for an inspection. Permittee shall be released one (1) year after completion notice from all requirements to maintain trench pavement and patches when all permit conditions, including but not limited to required inspections, have been met.
- 33. Acceptance.** The Permittee's acceptance of this Permit shall constitute acceptance of and agreement to all of the conditions and requirements of this Permit and the ordinance authorizing issuance of such permit. Permittee's acceptance of this Permit acknowledges that is revocable by the City of Salinas, and that upon notification of revocation Permittee shall remove the encroachment at Permittee's own expense, without cost or obligation to the City. The Permittee acknowledges that the Permittee is subject to, and must comply with, all applicable sections of the City Municipal Code.

## SPECIAL CONDITIONS OF APPROVAL

- A. Design and construction of the encroachment that is the subject of this Permit shall be coordinated with the City of Salinas and all utilities having jurisdiction.
- B. Master Plan and Schedule of Work shall be updated weekly.
- C. Work site(s) shall have full-time Site Superintendence.
- D. 24-hour emergency phone numbers shall be updated as changes occur.
- E. Method of trench restoration shall be approved in advance of permit and shall be made an attachment to the permit.

*The following to be completed by Public Works staff, as necessary.*

- F. Improvements shall conform to the City of Salinas Quality Assurance Program.

See attached QAP.

G.

H.

I.

## APPLICANT ACKNOWLEDGEMENT & SIGNATURE

Signature of Permittee or Authorized Representative accepting General Conditions of Approval:

Teri Nelson	Project Coordinator	10/07/2020
Print Name	Title	Date

Signature

FBD Vangaurd Construction Inc., 550 Greenville Rd, Livermore, CA 94550

Representing (Name and Address)

Note: Applicant must also sign Encroachment Permit application.

*CITY USE ONLY*

Permit No.: ENC20-0659 Issue Date: 10/22/2020 Expiration Date: 04/22/2021

GENERAL PROJECT NOTES

- ALL IMPROVEMENTS SHALL BE CONSTRUCTED IN ACCORDANCE WITH THESE PLANS AND THE PROJECT SPECIFICATIONS.
- CONTRACTOR SHALL POSSESS THE CLASS (OR CLASSES) OF LICENSE AS SPECIFIED IN THE "NOTICE TO CONTRACTORS".
- EXACT FIELD LOCATION FOR NEW IMPROVEMENTS SHALL BE APPROVED BY THE ENGINEER BEFORE CONSTRUCTION.
- VERIFICATION OF EXISTING CONDITIONS: CONTRACTOR SHALL VERIFY ALL EXISTING CONDITIONS, ELEVATIONS, AND DIMENSIONS IN THE FIELD PRIOR TO CONSTRUCTION. IF ANY DISCREPANCIES ARE NOTED, THE CONTRACTOR SHALL NOTIFY THE ENGINEER IMMEDIATELY FOR DIRECTION.
- UNDERGROUND SERVICE ALERT: A MINIMUM OF 48 HOURS PRIOR TO CONSTRUCTION, CONTRACTOR SHALL NOTIFY UNDERGROUND SERVICE ALERT AT 811 FOR EXISTING UTILITY LOCATIONS.
- UNDERGROUND FACILITIES: THE LOCATION OF EXISTING UNDERGROUND UTILITY FACILITIES, IF SHOWN ON THE PLANS, ARE APPROXIMATE ONLY. THE EXISTENCE, LOCATION, AND DEPTH OF ALL UTILITIES MUST BE VERIFIED BY POSITIVE LOCATION (POTHOLING) BY THE CONSTRUCTION CONTRACTOR PRIOR TO EXCAVATION OR ANY CONSTRUCTION WHICH MAY BE AFFECTED BY THE LOCATION OR ELEVATION OF THE UTILITY. CONTRACTOR SHALL NOTIFY THE ENGINEER OF ANY CONFLICTS OR OMISSIONS.
- NOTICE TO PROCEED: CONTRACTOR SHALL NOT COMMENCE WORK UNTIL AFTER A PRE-CONSTRUCTION MEETING HAS BEEN HELD WITH THE CITY, AND AFTER AN ENCROACHMENT PERMIT HAS BEEN ISSUED BY THE CITY.
- TRAFFIC CONTROL DURING CONSTRUCTION SHALL BE THE CONTRACTOR'S RESPONSIBILITY AND SHALL BE IN ACCORDANCE WITH THE CONTRACT DOCUMENTS. THE CONTRACTOR SHALL PROVIDE ALL LIGHTS, SIGNS, BARRICADES, FLAG MEN, AND OTHER DEVICES TO PROVIDE FOR SAFE PASSAGE OF PUBLIC VEHICULAR, BIKE, AND PEDESTRIAN TRAFFIC THROUGHOUT THE CONSTRUCTION AREA. CONTRACTOR SHALL PROVIDE ALL NECESSARY SAFETY DEVICES IN ACCORDANCE WITH CURRENT CALTRANS TRAFFIC CONTROL STANDARDS INCLUDING, BUT NOT LIMITED TO, STRIPING, SIGNS, BARRICADES, AND FLAG PERSONS
- THE CONTRACTOR SHALL SUBMIT A DETAILED TRAFFIC CONTROL & SIGNING PLAN TO THE ENGINEER AT THE PRE-CONSTRUCTION MEETING. THE NOTICE TO PROCEED SHALL NOT BE ISSUED UNTIL SAID TRAFFIC CONTROL PLAN HAS BEEN SUBMITTED AND APPROVED BY THE CITY.
- CONTRACTOR SHALL KEEP EXISTING STREETS FREE FROM DIRT AND DEBRIS DURING ALL PHASES OF CONSTRUCTION, AND IMPLEMENT STORMWATER BMP.
- CONTRACTOR SHALL MAINTAIN ACCESS TO PROPERTIES ALONG EAST ROMIE LANE THROUGHOUT THE DURATION OF CONSTRUCTION ACTIVITIES.
- ALL EXISTING UTILITY FACILITIES WITHIN THE PROJECT SHOWN ON THE PLANS ARE TO ADJUSTED TO GRADE BY THE CONTRACTOR. UTILITY COMPANIES, HOWEVER, RESERVE THE RIGHTS TO ADJUST THEIR FACILITIES TO GRAD USING THEIR OWN FORCES AFTER THE CONTRACT IS AWARDED. NO COMPENSATION WILL BE ALLOWED FOR ANY ADJUSTMENT WHICH MAY BE PERFORMED BY THE OWNER OF THE FACILITIES. CONTRACTOR TO COORDINATE WITH UTILITY COMPANIES TO HAVE THEIR STRUCTURES ADJUSTED TO GRADE OR TO OBTAIN WRITTEN PERMISSION FROM UTILITY COMPANIES TO ADJUST THEIR STRUCTURES TO GRADE.
- UTILITY REPAIR: CONTRACTOR SHALL REPAIR ANY DAMAGE OR INTERRUPTION OF UTILITIES, WATER LINES OR IRRIGATION SYSTEMS CAUSED BY CONSTRUCTION IMMEDIATELY TO THE SATISFACTION OF THE DAMAGED UTILITY OWNER. IF OWNER COMPLETES THE REPAIR, CONTRACTOR IS RESPONSIBLE FOR REIMBURSEMENT COST.
- THE CONTRACTOR IS RESPONSIBLE FOR CONFORMING EXISTING STREETS, SURROUNDING LANDSCAPE, AND OTHER IMPROVEMENTS WITH A SMOOTH TRANSITION IN PAVING AND GRADING, ETC., AND IS TO AVOID ANY ABRUPT OR APPARENT CHANGES IN GRADES OR CROSS SLOPES, LOW SPOTS OR HAZARDOUS CONDITIONS.
- CONTRACTOR SHALL COMPLY WITH THE RULES AND REGULATIONS OF THE STATE CONSTRUCTION SAFETY ORDERS AND CAL OSHA.
- WHEN HAULING ANY EARTH, SAND, GRAVEL, STONE, DEBRIS, PAPER, OR ANY OTHER SUBSTANCE OVER ANY PUBLIC STREET, ALLEY, OR PUBLIC PLACE, THE CONTRACTOR SHALL NOT ALLOW MATERIAL TO BLOW OR SPILL OVER AND UPON SAID PUBLIC, ADJACENT OR PRIVATE PROPERTY.
- CONTRACTOR SHALL PROVIDE DUST CONTROL AT ALL TIMES. PRIOR TO OBTAINING WATER FROM FIRE HYDRANTS, CONTRACTOR SHALL OBTAIN A HYDRANT METER FROM OPERATOR OF WATER SYSTEM. GRADING OR ANY OTHER OPERATION THAT CREATES DUST SHALL BE STOPPED IMMEDIATELY IF DUST AFFECTS ADJACENT PROPERTIES. SUFFICIENT WATERING TO CONTROL DUST IS REQUIRED AT ALL TIMES AND A DUST PALLIATIVE MAY BE REQUIRED BY THE CITY ENGINEER. MUD TRACKED ONTO STREETS OR ADJACENT PROPERTIES SHALL BE REMOVED IMMEDIATELY BY THE CONTRACTOR. STREETS SHALL BE SWEEP AS DIRECTED BY THE CITY INSPECTOR.
- ALL EXISTING IRRIGATION, LANDSCAPE MATERIALS, PAVEMENT DELINEATION, CURB AND GUTTER, AND OTHER IMPROVEMENTS, THAT ARE NOT TO BE REMOVED BUT ARE DAMAGED DURING CONSTRUCTION, SHALL BE REPLACED OR RESTORED TO EXISTING CONDITION AT NO ADDITIONAL EXPENSE TO THE CITY AND TO THE SATISFACTION OF THE ENGINEER.
- TREES TO REMAIN SHALL BE FLAGGED AND MARKED PRIOR TO ANY CLEARING OR GRUBBING WORK. WHERE REQUIRED BY THE CITY, PROTECTIVE FENCING SHALL BE INSTALLED PRIOR TO COMMENCING ANY GRADING, REMOVAL, OR DEMO WORK. LOCATIONS OF FENCING SHALL BE DETERMINED IN THE FIELD BY THE CITY UPON COMPLETION OF THE STAKING DAYLIGHT LINES.
- CONTRACTOR TO NOTIFY ADJACENT BUSINESSES AND RESIDENTS NO LESS THAN 72 HOURS PRIOR TO A LANE CLOSURE.

# EAST ROMIE LANE MID-BLOCK CROSSING IMPROVEMENTS

MONTEREY COUNTY  
SALINAS, CALIFORNIA

TO BE SUPPLEMENTED BY:

PROJECT SPECIFICATIONS,  
CITY OF SALINAS DESIGN SPECIFICATIONS, DESIGN STANDARDS, AND  
STANDARD PLANS 2008 EDITION,  
CALTRANS STANDARD PLANS DATED OCTOBER 2018,  
CALIFORNIA MUTCD REV 5 DATED MARCH 2020

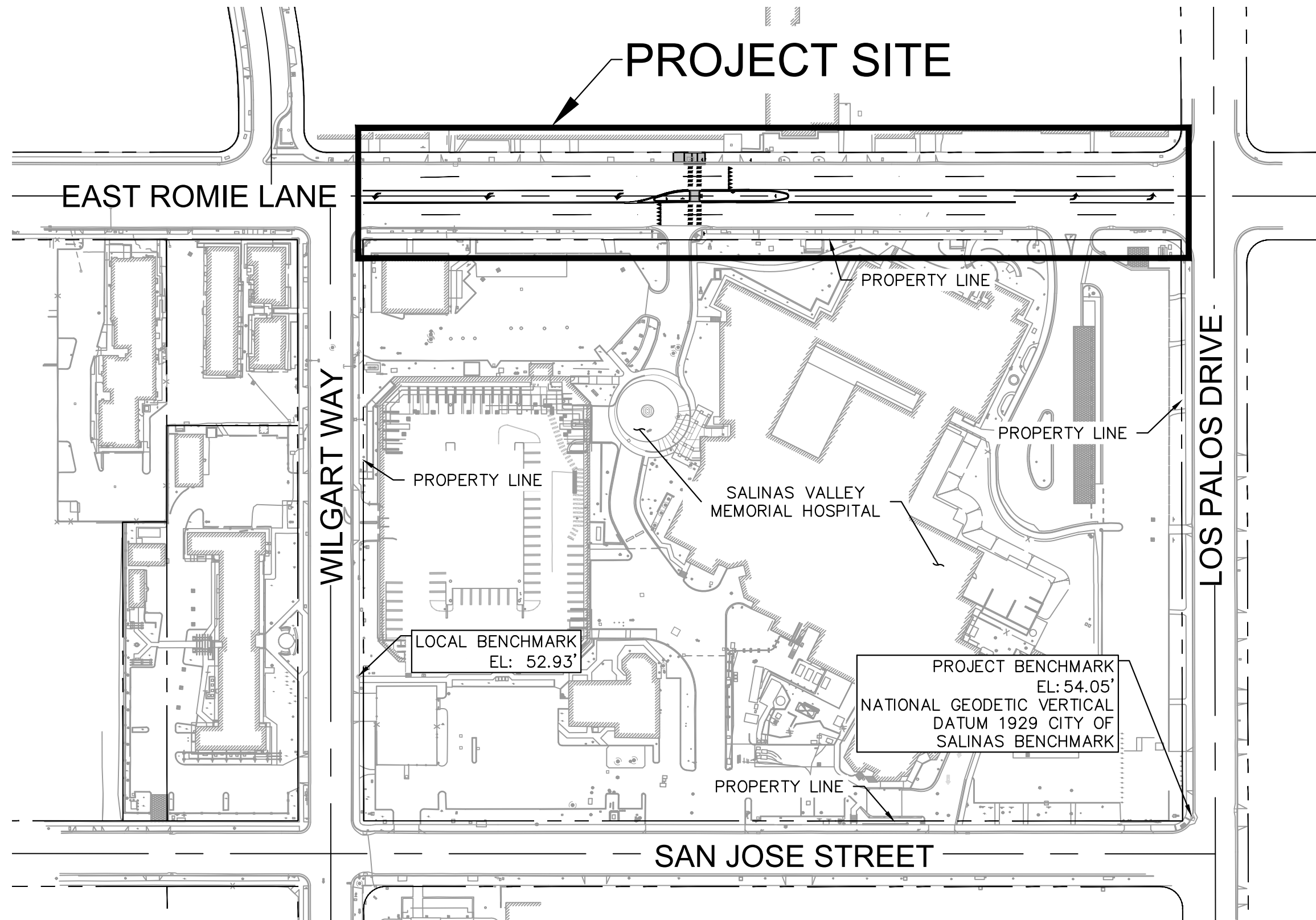

SHEET INDEX		
SHEET No	SHEET TITLE	SHEET CONTENTS
1	CV-1	COVER SHEET AND GENERAL NOTES
2-3	L-1 TO L-2	LAYOUT PLANS
4-5	SS-1 TO SS-2	SIGNING AND STRIPING PLANS

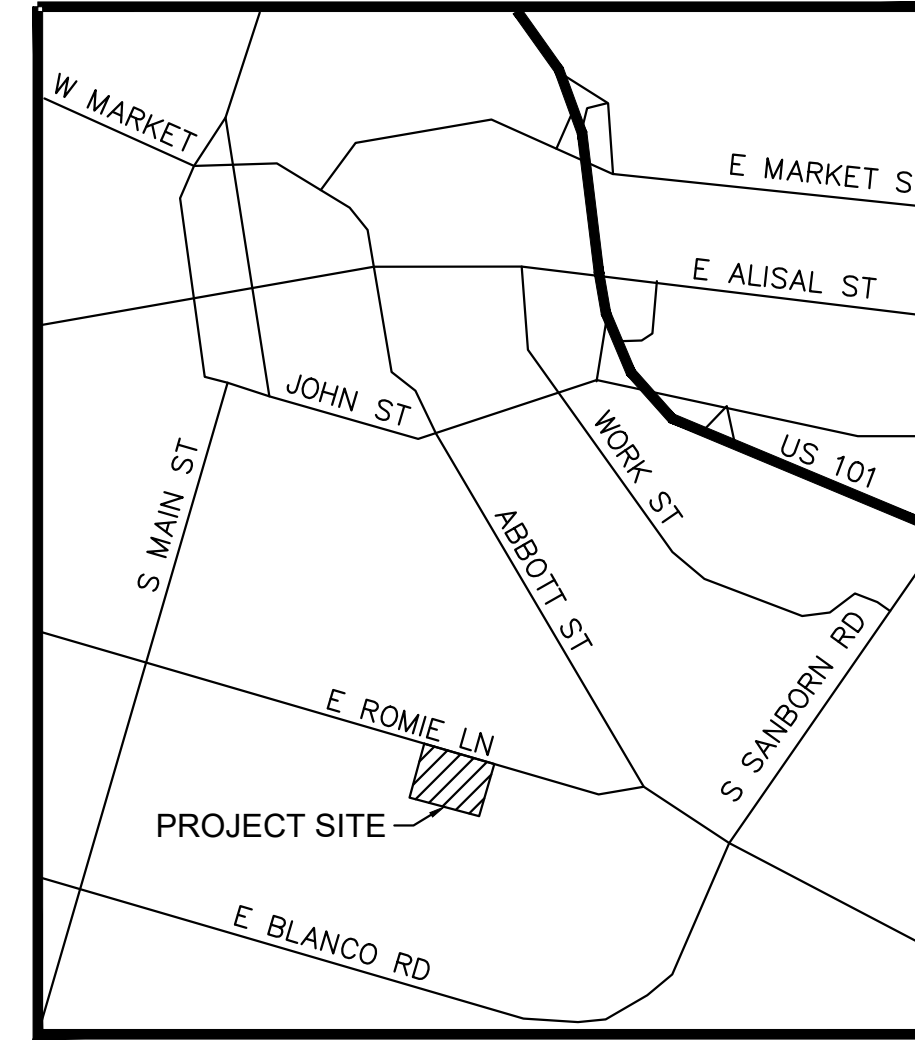

VICINITY MAP  
N.T.S.



## PROJECT DESCRIPTION

CONSTRUCT MID-BLOCK CROSSING IMPROVEMENTS ON EAST ROMIE LANE FROM WILGART WAY TO LOS PALOS DRIVE TO IMPROVE PEDESTRIAN ACCESS BETWEEN SVMHS FACILITIES. THE PROJECT SCOPE INCLUDES A RAISED MEDIAN, ADA-COMPLIANT CURB RAMPS, RRFB SYSTEM, AND ROADWAY STRIPING.

## BASIS OF BEARINGS AND ELEVATIONS

SURVEY IS BASED ON A COMPILATION OF TOPOGRAPHIC SURVEYS OF SVMHS PROPERTIES OVER THE COURSE OF 15 YEARS AND SUPPLEMENTAL TOPOGRAPHIC SURVEYS PERFORMED BY WHITSON ENGINEERS IN OCTOBER OF 2019 THROUGH MARCH OF 2020.

PROJECT BENCHMARK IS THAT NATIONAL GEODETIC VERTICAL DATUM 1929 (NGVD 29) CITY OF SALINAS BENCHMARK LOCATED ON CORNER OF LOS PALOS DRIVE AT SAN JOSE STREET DESCRIBED AS A 'T.C. N.W. COR BY C.B.' ELEVATION 54.05'.

ADD +2.84' TO NGVD 29 ELEVATION TO ADJUST TO NORTH AMERICAN VERTICAL DATUM 1988 (NAVD 88) ELEVATION.

LOCAL SITE BENCHMARK IS A SCRIBE 'X' IN SIDEWALK 160'± NORTH OF THE WILGART WAY AT SAN JOSE STREET INTERSECTION AS SHOWN HERON. ELEVATION 52.93'.

DIMENSIONS ARE SHOWN IN FEET AND DECIMALS THEREOF

UTILITY INFORMATION IS BASED ON HISTORIC SURVEY DATA IN COMBINATION WITH UTILITY MARKINGS PROVIDED BY CRUZ BROTHERS LOCATORS, INC. THE EXISTENCE, LOCATION, AND DEPTH OF ALL UTILITIES MUST BE VERIFIED BY POSITIVE LOCATION (POTHOLING) BY THE CONSTRUCTION CONTRACTOR PRIOR TO EXCAVATION OR ANY CONSTRUCTION WHICH MAY BE AFFECTED BY THE LOCATION OR ELEVATION OF THE UTILITY.



SALINAS VALLEY  
MEMORIAL HOSPITAL  
450 EAST ROMIE LANE  
SALINAS CA, 93901

EAST ROMIE LANE  
MID-BLOCK CROSSING  
IMPROVEMENTS

**Kimley»Horn**  
©2020 KIMLEY-HORN AND ASSOCIATES, INC.  
10 SOUTH ALMADEN BOULEVARD,  
SUITE 1250, SAN JOSE, CA 95113  
PHONE: 669-800-4130

CIVIL ENGINEER'S SEAL:



DRAWN BY: DW  
DESIGNED BY: DW  
CHECKED BY: FV  
PRINT DATE: 06/23/2020  
SHEET TITLE:

CV-1

SHEET NUMBER:

1

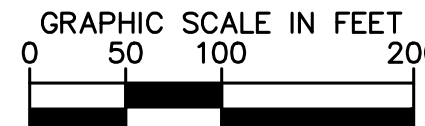
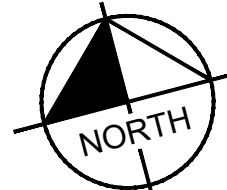

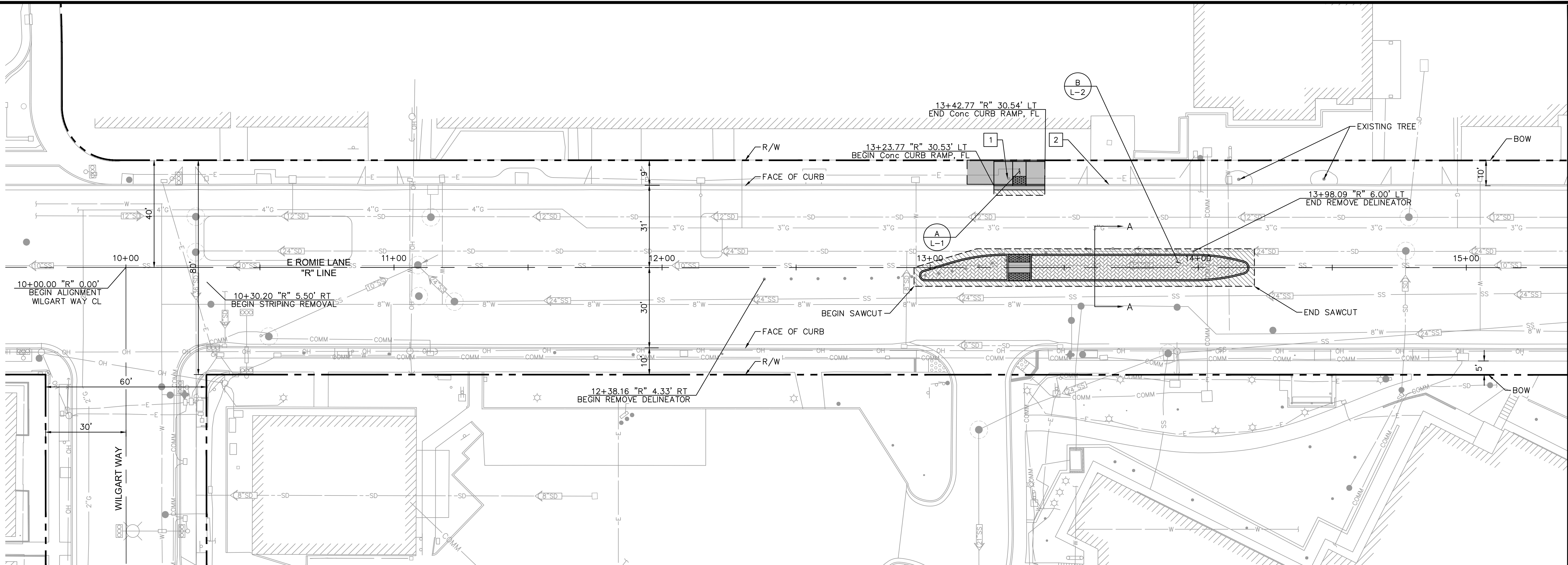

### LEGEND

- PCC (CURB, GUTTER, SIDEWALK, & CURB RAMP)
- ROADWAY (6.5" HMA & 10" CLASS II AB SECTION)
- DETECTABLE WARNING SURFACE
- PCC STAMPED CONCRETE (HERRINGBONE PATTERN)
- SAWCUT
- G- GAS LINE
- OH- OVERHEAD UTILITY LINE(S)
- SS- SANITARY SEWER LINE
- SD- STORM DRAIN LINE
- W- WATER LINE
- COMM- COMMUNICATION LINE
- E- ELECTRICAL LINE
- XX / XX DETAIL NO. / SHEET REFERENCE

### GENERAL CONSTRUCTION NOTES

- SAWCUT SHALL BE ON A NEAT LINE WITHOUT DAMAGING EXISTING AC OR CONCRETE THAT IS TO REMAIN IN PLACE. ANY DAMAGE TO THE ADJACENT SURFACE MATERIAL TO REMAIN SHALL BE REPAIRED OR REPLACED TO A CONDITION SATISFACTORY TO THE ENGINEER AT THE CONTRACTOR'S EXPENSE.
- ALL STATION CALLOUTS REFERENCE "R" LINE STATIONS, UNLESS OTHERWISE NOTED.
- CONTRACTOR SHALL VERIFY ALL RIGHTS OF WAY PRIOR TO CONSTRUCTION.
- SEE SIGNING AND STRIPING PLAN FOR PAVEMENT DELINEATION AND SIGNING DETAILS.
- EXISTING UTILITIES ARE PRESENT CLOSE TO THE PROPOSED WORK. CONTRACTOR SHALL POTHOLE AND FIELD LOCATE EXISTING UTILITIES AND NOTIFY THE ENGINEER OF ANY CONFLICTS WITH THE PROPOSED WORK PRIOR TO THE START OF CONSTRUCTION.
- ALL TREES SHALL BE PROTECTED IN PLACE, UNLESS CALLED OUT TO BE REMOVED. ANY TREES THAT ARE DAMAGED BY CONSTRUCTION ACTIVITIES SHALL BE REPLACED IN KIND AT NO ADDITIONAL EXPENSE TO THE CITY.

### CONSTRUCTION NOTES

- REMOVE EXISTING TREE
- EXISTING DRIVEWAY TO REMAIN

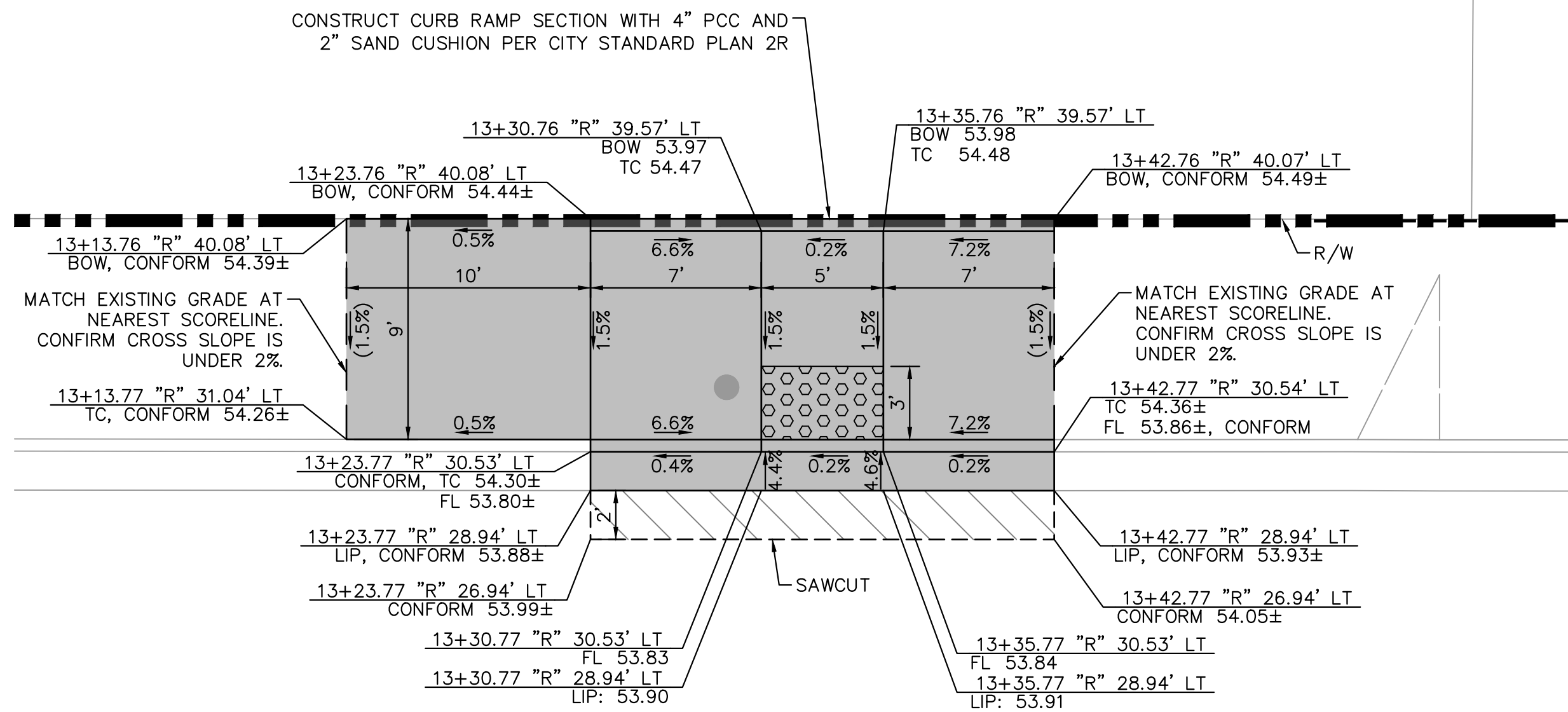
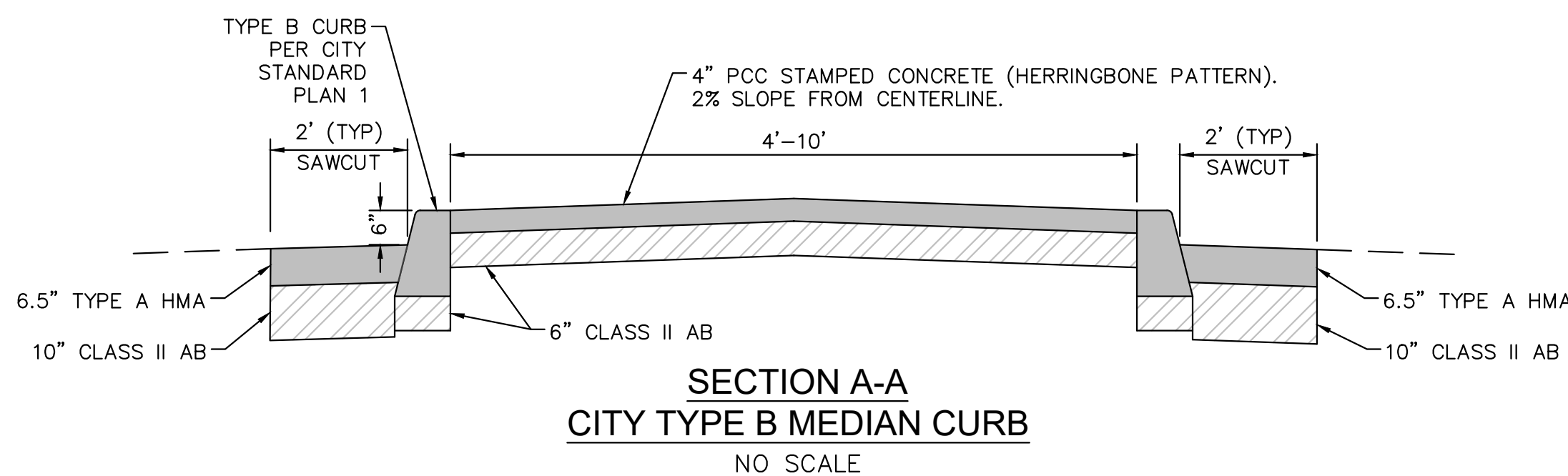

DETAIL A  
CALTRANS CASE C MODIFIED CURB RAMP  
SCALE: 1" = 5'

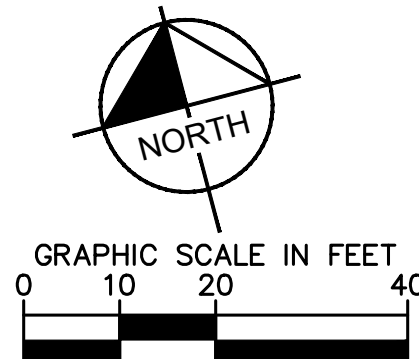

SALINAS VALLEY  
MEMORIAL HOSPITAL  
450 EAST ROMIE LANE  
SALINAS CA, 93901

**EAST ROMIE LANE  
MID-BLOCK CROSSING  
IMPROVEMENTS**

**Kimley»Horn**  
©2020 KIMLEY-HORN AND ASSOCIATES, INC.  
10 SOUTH ALMADEN BOULEVARD,  
SUITE 1250, SAN JOSE, CA 95113  
PHONE: 669-800-4130

CIVIL ENGINEER'S SEAL:

DRAWN BY: DW  
DESIGNED BY: DW  
CHECKED BY: FV  
PRINT DATE: 06/23/2020  
SHEET TITLE: L-1  
SHEET NUMBER: 2

MATCH LINE 15+38 SEE SHEET L-1

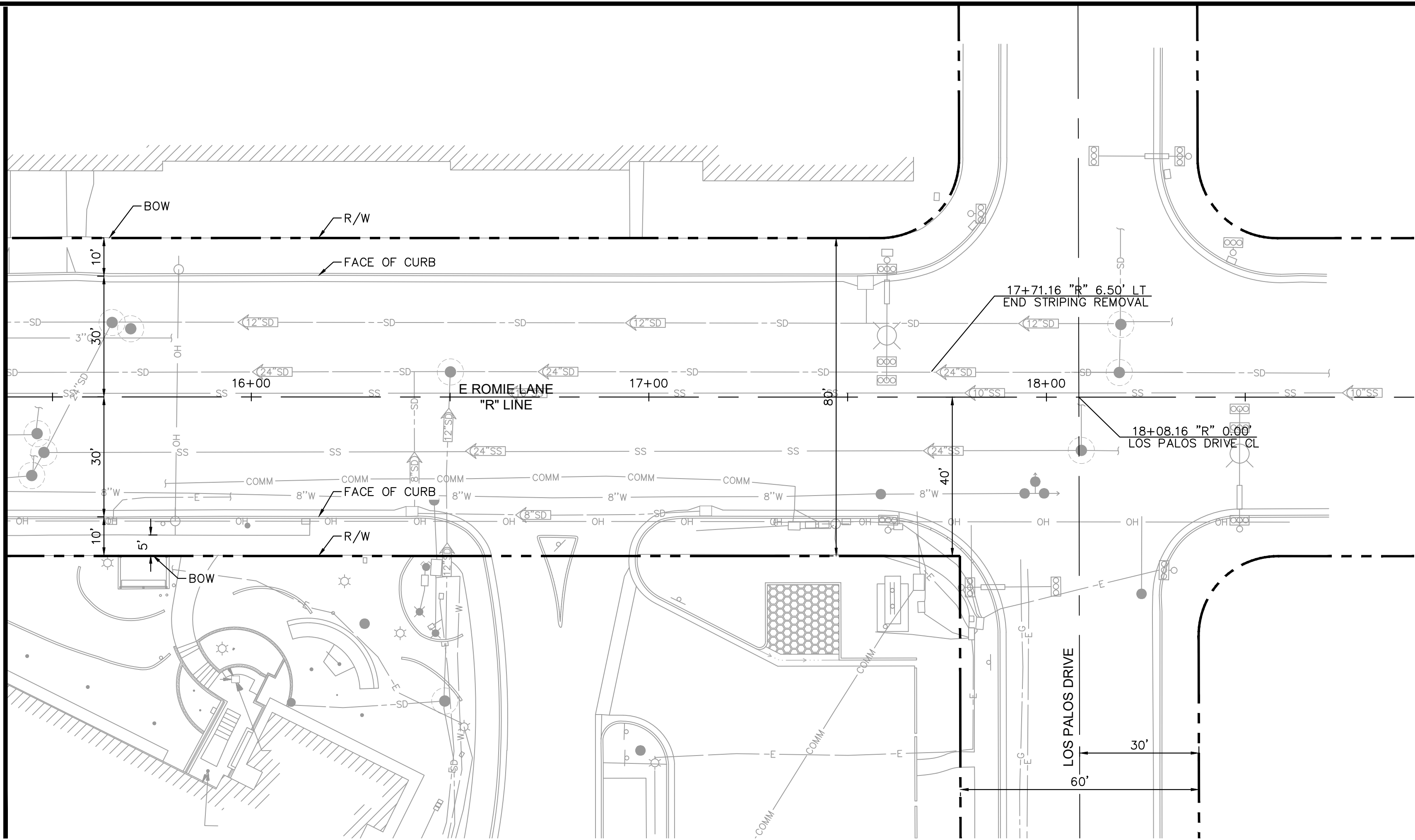

#### LEGEND

- PCC (CURB, GUTTER, SIDEWALK, & CURB RAMP)
- ROADWAY (6.5" HMA & 10" CLASS II AB SECTION)
- DETECTABLE WARNING SURFACE
- PCC STAMPED CONCRETE (HERRINGBONE PATTERN)
- SAWCUT
- GAS LINE
- OVERHEAD UTILITY LINE(S)
- SANITARY SEWER LINE
- STORM DRAIN LINE
- WATER LINE
- COMMUNICATION LINE
- ELECTRICAL LINE
- DETAIL NO. / SHEET REFERENCE

#### GENERAL CONSTRUCTION NOTES

- SAWCUT SHALL BE ON A NEAT LINE WITHOUT DAMAGING EXISTING AC OR CONCRETE THAT IS TO REMAIN IN PLACE. ANY DAMAGE TO THE ADJACENT SURFACE MATERIAL TO REMAIN SHALL BE REPAIRED OR REPLACED TO A CONDITION SATISFACTORY TO THE ENGINEER AT THE CONTRACTOR'S EXPENSE.
- ALL STATION CALLOUTS REFERENCE "R" LINE STATIONS, UNLESS OTHERWISE NOTED.
- CONTRACTOR SHALL VERIFY ALL RIGHTS OF WAY PRIOR TO CONSTRUCTION.
- SEE SIGNING AND STRIPING PLAN FOR PAVEMENT DELINEATION AND SIGNING DETAILS.
- EXISTING UTILITIES ARE PRESENT CLOSE TO THE PROPOSED WORK. CONTRACTOR SHALL POTHOLE AND FIELD LOCATE EXISTING UTILITIES AND NOTIFY THE ENGINEER OF ANY CONFLICTS WITH THE PROPOSED WORK PRIOR TO THE START OF CONSTRUCTION.
- ALL TREES SHALL BE PROTECTED IN PLACE, UNLESS CALLED OUT TO BE REMOVED. ANY TREES THAT ARE DAMAGED BY CONSTRUCTION ACTIVITIES SHALL BE REPLACED IN KIND AT NO ADDITIONAL EXPENSE TO THE CITY.

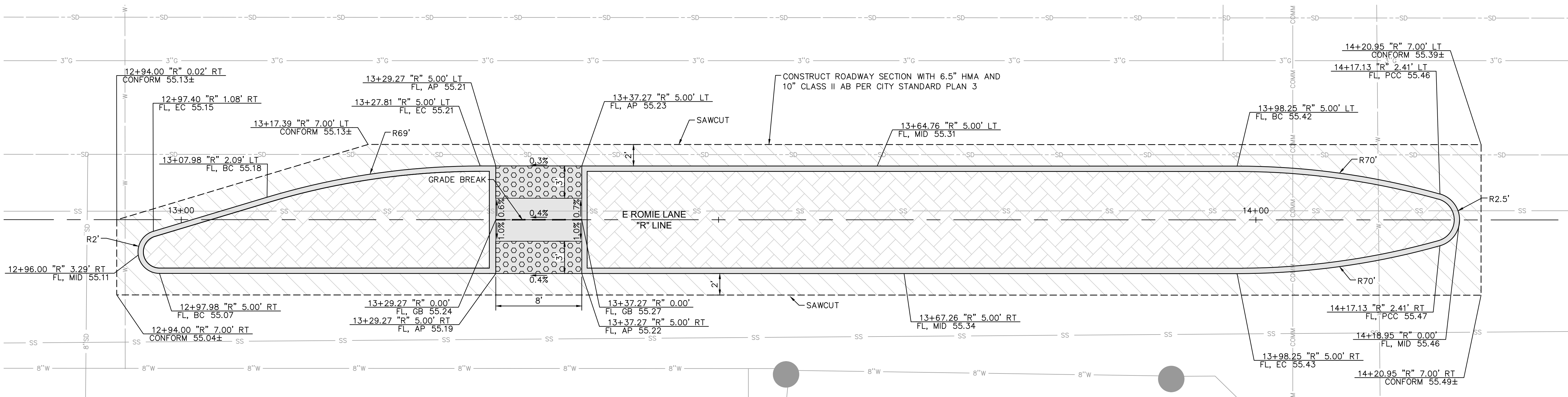

DETAIL B  
CITY TYPE B RAISED MEDIAN  
SCALE: 1" = 5'

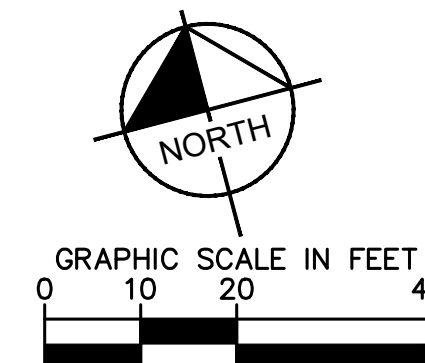
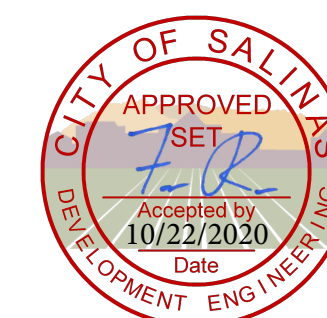

## EAST ROMIE LANE MID-BLOCK CROSSING IMPROVEMENTS

**Kimley»Horn**  
©2020 KIMLEY-HORN AND ASSOCIATES, INC.  
10 SOUTH ALMADEN BOULEVARD,  
SUITE 1250, SAN JOSE, CA 95113  
PHONE: 669-800-4130

CIVIL ENGINEER'S SEAL:



DRAWN BY: DW  
DESIGNED BY: DW  
CHECKED BY: FV  
PRINT DATE: 06/23/2020  
SHEET TITLE:

L-2

SHEET NUMBER:  
3

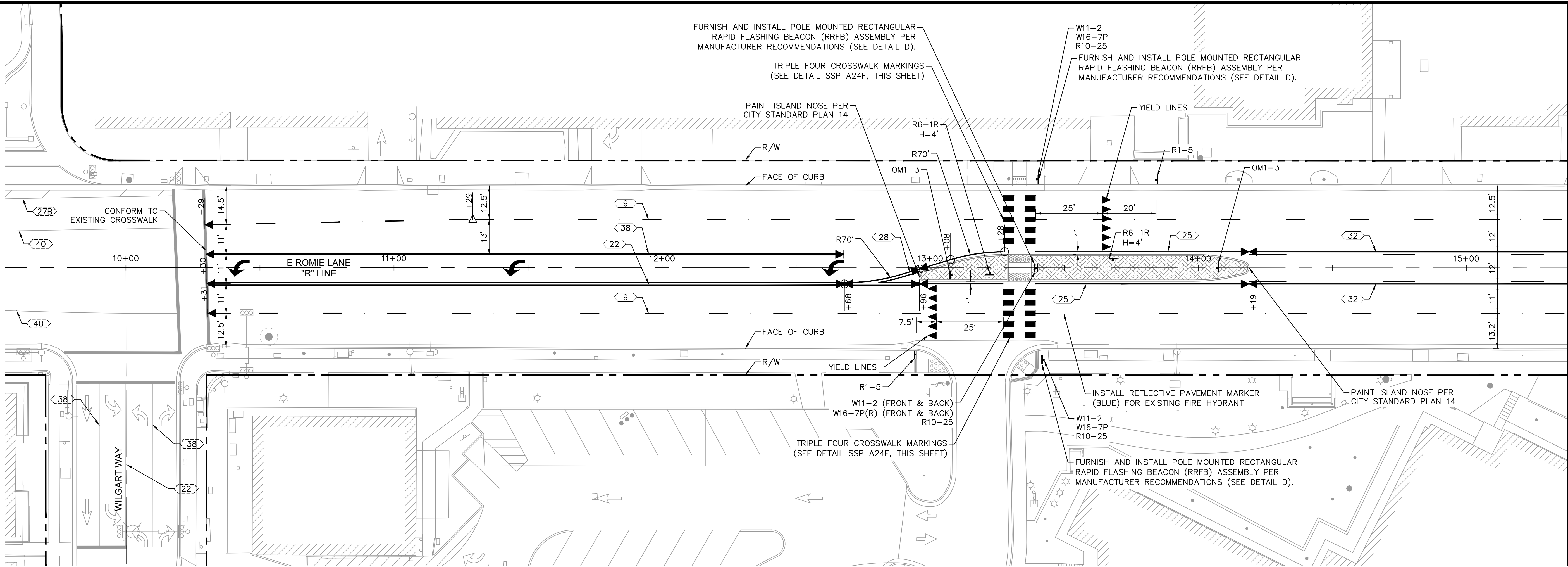

### GENERAL SIGNING AND STRIPING NOTES

- ALL STATION CALLOUTS REFERENCE "R" LINE STATIONS, UNLESS OTHERWISE NOTED.
- ALL EXISTING SIGNS SHALL BE PROTECTED IN PLACE UNLESS SPECIFIED FOR REMOVAL OR RELOCATION.
- EXISTING SIGNS SPECIFIED FOR REMOVAL SHALL NOT BE REMOVED UNTIL NO LONGER PERTINENT TO TRAFFIC CONTROL.
- ALL STRIPING CONFLICTING WITH PROPOSED STRIPING SHALL BE REMOVED PRIOR TO NEW STRIPING INSTALLATION. EXISTING STRIPING SHALL BE REMOVED COMPLETELY BY PAVEMENT GRINDING. PAVEMENT SCARRING RESULTING FROM STRIPING REMOVAL SHALL BE SEALED WITH TYPE II SLURRY.
- ALL PAVEMENT DELINEATION MUST BE IN ACCORDANCE WITH CURRENT VERSION OF THE CALIFORNIA MUTCD AND CALTRANS STANDARD PLANS.
- ALL STRIPING DIMENSIONS SHOWN ARE MEASURED FROM STRIPE TO STRIPE, STRIPE TO TOP OF CURB, OR STRIPE TO FACE OF CURB WHICHEVER SCENARIO IS CLOSER.
- CONCRETE FOUNDATION SHALL CONFORM TO CALTRANS STANDARD SPECIFICATION 56-3 "STANDARDS, POLES, PEDESTALS, AND POSTS".

### LEGEND

- EXISTING SIGN
- PROPOSED SIGN
- EXISTING STRIPING DETAIL
- PROPOSED STRIPING DETAIL
- STRIPING CHANGE
- STRIPING LIMIT
- ANGLE POINT
- PAVEMENT MARKING

STRIPING AND MARKING SCHEDULE			
DETAIL	PATTERN OR LEGEND	LF	SQFT
9	LANELINE	1433	-
22	CENTERLINE	384	-
25	LEFT EDGELINE	227	-
28	MEDIAN ISLAND	30	-
32	TWO WAY LEFT TURN LANE	208	-
38	CHANNELIZING LINE	333	-
PM	TYPE IV ARROW	-	75
PM	TRIPLE FOUR CROSSWALK	-	80
PM	YIELD LINE MARKINGS	-	36
TOTAL		2615	191

SIGN SCHEDULE			
DETAIL	STATION	DESCRIPTION	EA
R1-5	12+96, 13+85	YIELD TO PEDESTRIANS	2
R6-1R	13+22, 13+68	ONE WAY RIGHT (H=4')	2
R10-25	13+40	PUSH BUTTON FOR LIGHTS	3
W11-2	13+40	PEDESTRIAN CROSSING	4
W16-7P	13+40	ARROW	4
OM1-3	13+08, 14+07	TYPE 1 OBJECT MARKER	2
TOTAL			17

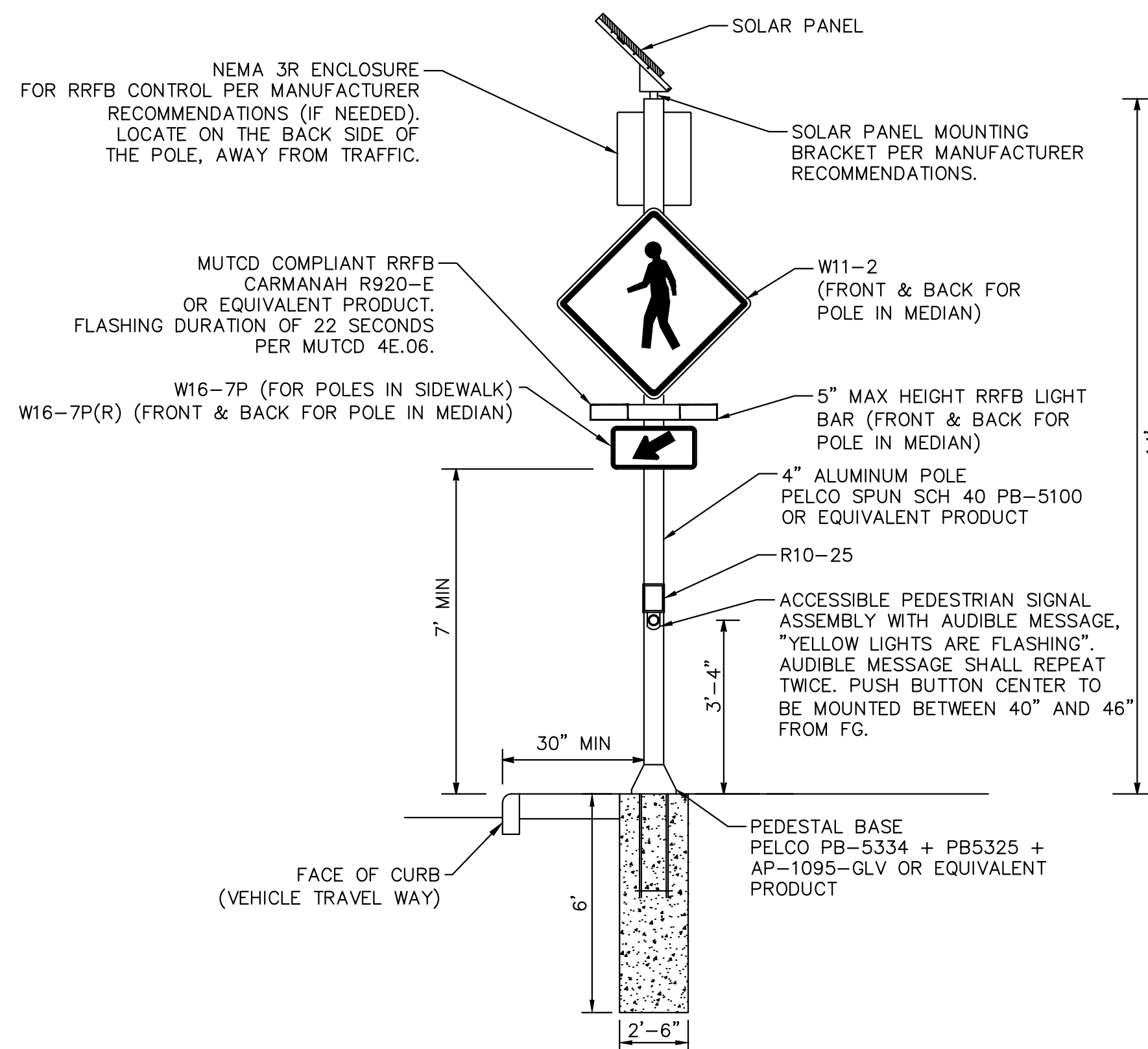

DETAIL D  
RECTANGULAR RAPID FLASHING  
BEACON (RRFB) ASSEMBLY  
NO SCALE

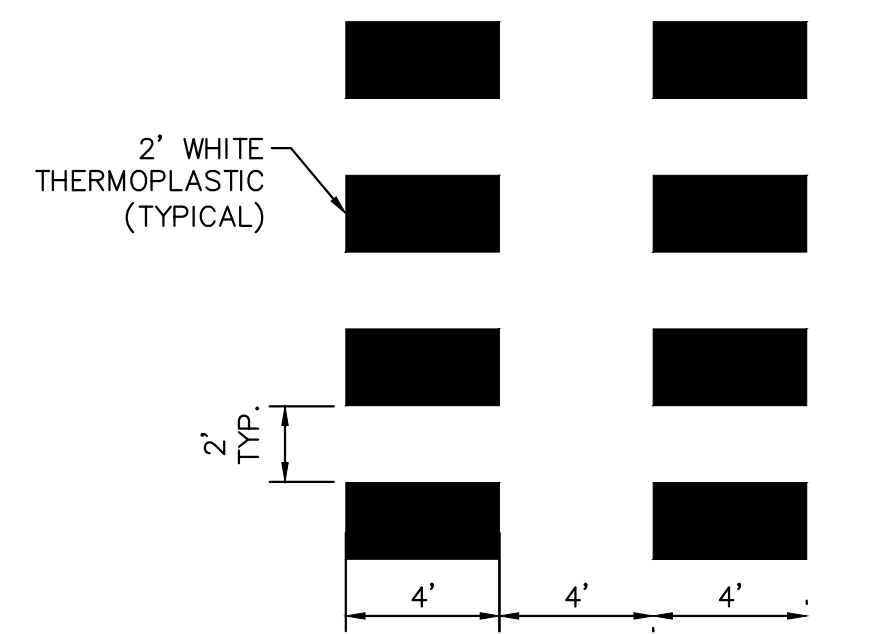

SSP A24F  
TRIPLE FOUR CROSSWALK  
NO SCALE

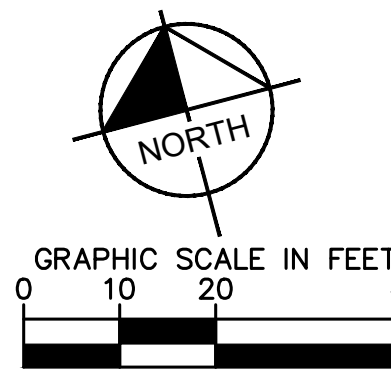

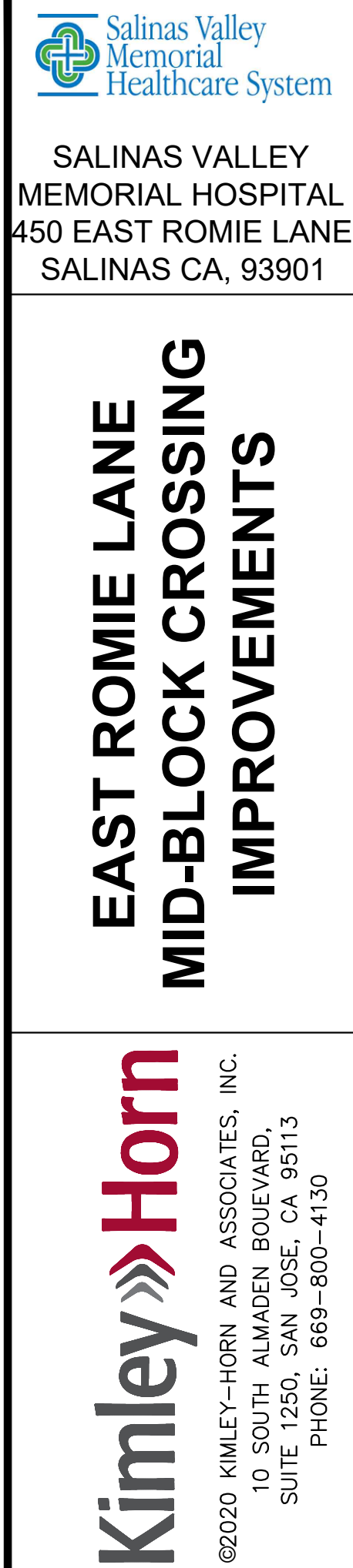

SALINAS VALLEY  
MEMORIAL HOSPITAL  
450 EAST ROMIE LANE  
SALINAS CA, 93901

**EAST ROMIE LANE  
MID-BLOCK CROSSING  
IMPROVEMENTS**

**Kimley»Horn**  
©2020 KIMLEY-HORN AND ASSOCIATES, INC.  
10 SOUTH ALMADEN BOULEVARD,  
SUITE 1250, SAN JOSE, CA 95113  
PHONE: 669-800-4130

CIVIL ENGINEER'S SEAL:

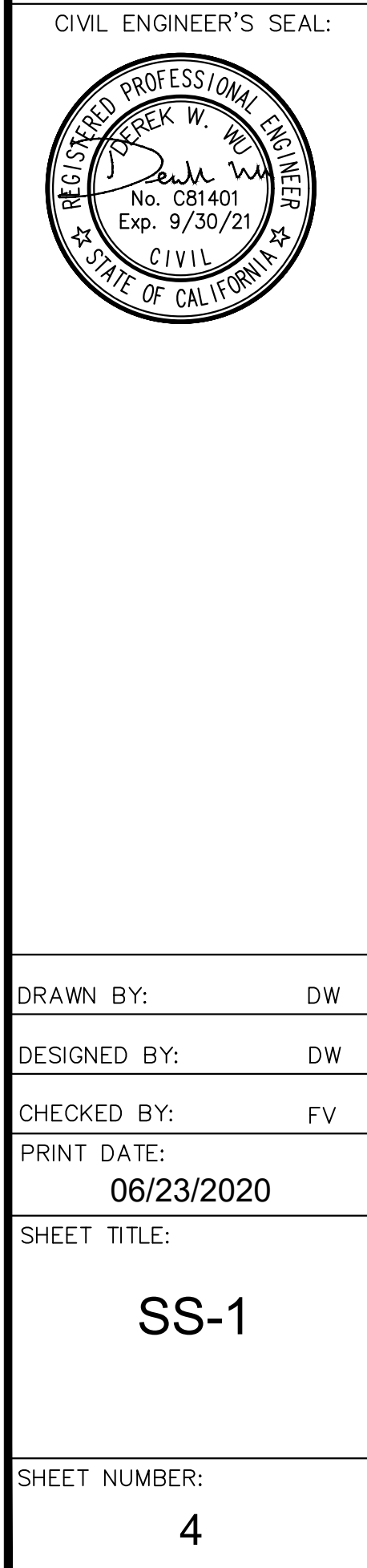

DRAWN BY: DW  
DESIGNED BY: DW  
CHECKED BY: FV  
PRINT DATE: 06/23/2020  
SHEET TITLE: SS-1  
SHEET NUMBER: 4

MATCH LINE 15+38 SEE SHEET SS-1

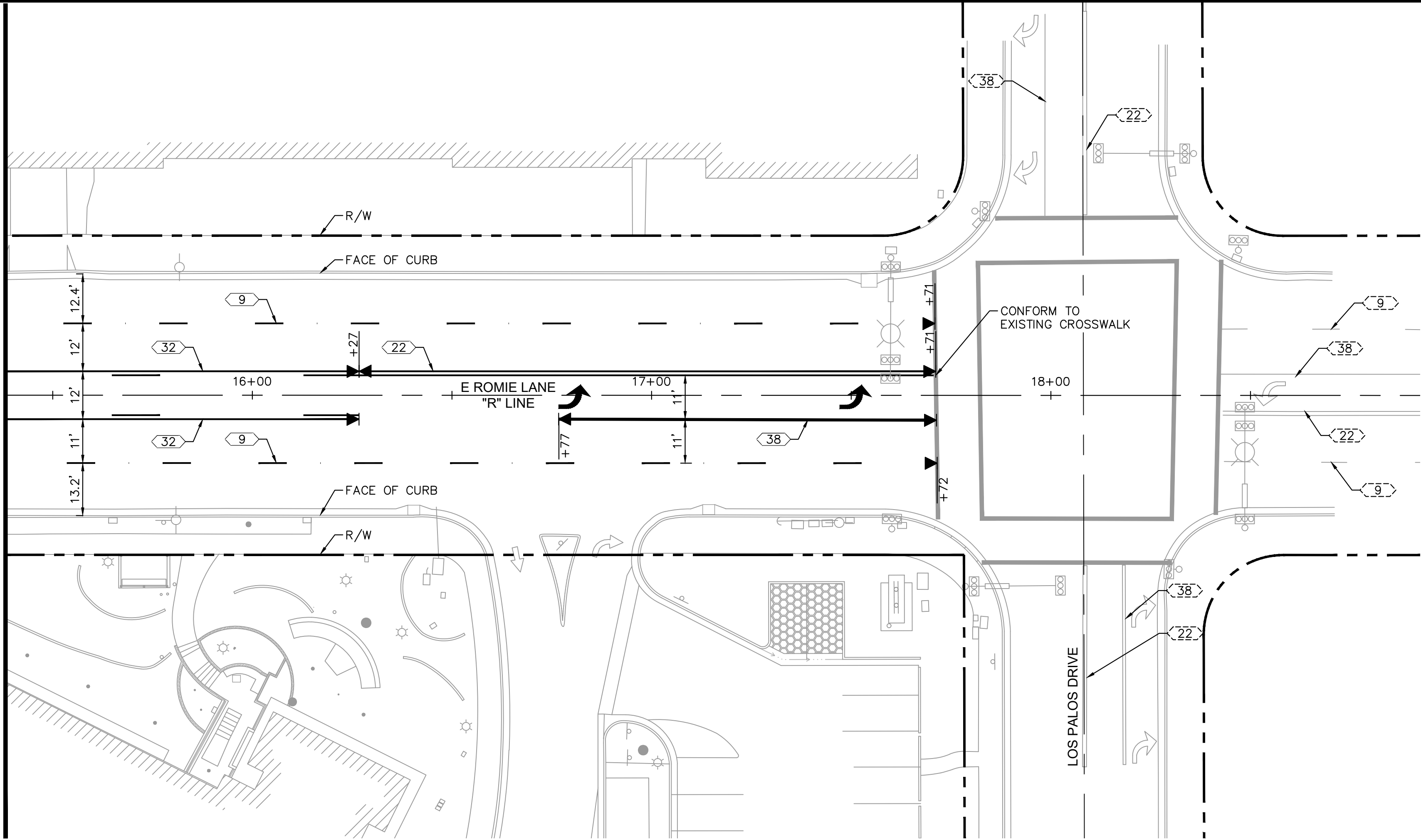

GENERAL SIGNING AND STRIPING NOTES

1. ALL STATION CALLOUTS REFERENCE "R" LINE STATIONS, UNLESS OTHERWISE NOTED.
2. ALL EXISTING SIGNS SHALL BE PROTECTED IN PLACE UNLESS SPECIFIED FOR REMOVAL OR RELOCATION.
3. EXISTING SIGNS SPECIFIED FOR REMOVAL SHALL NOT BE REMOVED UNTIL NO LONGER PERTINENT TO TRAFFIC CONTROL.
4. ALL STRIPING CONFLICTING WITH PROPOSED STRIPING SHALL BE REMOVED PRIOR TO NEW STRIPING INSTALLATION. EXISTING STRIPING SHALL BE REMOVED COMPLETELY BY PAVEMENT GRINDING. PAVEMENT SCARRING RESULTING FROM STRIPING REMOVAL SHALL BE SEALED WITH TYPE II SLURRY.
5. ALL PAVEMENT DELINEATION MUST BE IN ACCORDANCE WITH CURRENT VERSION OF THE CALIFORNIA MUTCD AND CALTRANS STANDARD PLANS.
6. ALL STRIPING DIMENSIONS SHOWN ARE MEASURED FROM STRIPE TO STRIPE, STRIPE TO TOP OF CURB, OR STRIPE TO FACE OF CURB WHICHEVER SCENARIO IS CLOSER

LEGEND

- EXISTING SIGN
- PROPOSED SIGN
- EXISTING STRIPING DETAIL
- PROPOSED STRIPING DETAIL
- STRIPING CHANGE
- STRIPING LIMIT
- ANGLE POINT
- PAVEMENT MARKING

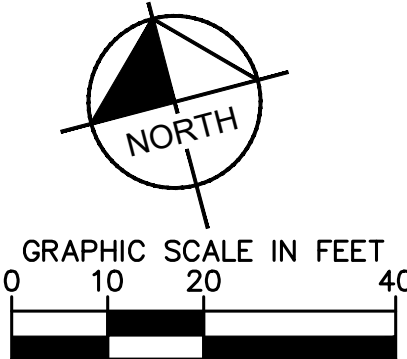

SALINAS VALLEY  
MEMORIAL HOSPITAL  
450 EAST ROMIE LANE  
SALINAS CA, 93901

**EAST ROMIE LANE  
MID-BLOCK CROSSING  
IMPROVEMENTS**

**Kimley»Horn**  
©2020 KIMLEY-HORN AND ASSOCIATES, INC.  
10 SOUTH ALMADEN BOULEVARD,  
SUITE 1250, SAN JOSE, CA 95113  
PHONE: 669-800-4130

CIVIL ENGINEER'S SEAL:

DRAWN BY:	DW
DESIGNED BY:	DW
CHECKED BY:	FV
PRINT DATE:	06/23/2020
SHEET TITLE:	SS-2
SHEET NUMBER:	5

**TRAFFIC CONTROL PLAN  
EAST ROMIE LANE MID-BLOCK CROSSING IMPROVEMENTS  
MEDIAN WORK PLAN - SALINAS, CA**

**DRAFT**



**Legend**

- Type III Barricade
- 28" Traffic Cone
- Delineator
- Compliance Barricade
- Work Area
- Sign and Stand
- Direction of Travel
- Concrete K-Rail
- Crash Cushion
- NTS Not To Scale
- TA/NS Tow-Away/No Stopping
- Parking Control Officer
- Flagger
- Type I Barricade
- Flashing Beacon
- (N) Sewer

**Table 6C-3(CA). Taper Length Criteria for Temporary Traffic Control Zones**  
(for 12 foot Offset Width)

Speed* S (mph)	Minimum Taper Length** for Width of Offset 12 feet (W)			
	Merging L (feet)	Shifting L/2 (feet)	Shoulder L/3 (feet)	Down Stream (feet)***
20	80	40	27	50
25	125	63	42	50
30	180	90	60	50
35	245	123	82	50
40	320	160	107	50
45	540	270	180	50
50	600	300	200	50
55	660	330	220	50
60	720	360	240	50
65	780	390	260	50
70	840	420	280	50
75	900	450	300	50

\* - Posted speed limit, off-peak 85th-percentile speed prior to work starting, or the anticipated operating speed in mph.

\*\* - For other offsets use the following merging taper length formula for L:  
For speeds of 40 mph or less, L=WS/60  
For speeds of 45 mph or more, L=WS

Where:  
L = taper length in feet  
W = width of offset in feet  
S = posted speed limit, off-peak 85th-percentile speed prior to work starting, or the anticipated operating speed in mph

\*\*\* - Maximum downstream taper length is 100 feet. See Section 6C.08.

**Table 6F-101(CA). Maximum Spacing of Channelizing Devices**

Speed (mph)	Maximum Channelizing Devices Spacing		
	Taper* (feet)	Tangent (feet)	Conflict** (feet)
20	20	40	10
25	25	50	12
30	30	60	15
35	35	70	17
40	40	80	20
45	45	90	22
50	50	100	25
55	50	100	25
60	50	100	25
65	50	100	25
70	50	100	25
75	50	100	25

\* Maximum channelizing device spacing for all speeds on one-lane/two-way tapers is 20 feet.  
Maximum channelizing device spacing for all speeds on downstream tapers is 20 feet.  
All other tapers are as shown.

\*\* Use on intermediate and short-term projects for taper and tangent sections where there are no pavement markings or where there is a conflict between existing pavement markings and channelizing devices.

**Table 6C-1. Recommended Advance Warning Sign Minimum Spacing**

Road Type	Distance Between Signs**		
	A	B	C
Urban <i>downspeeds</i> - 25 mph or less***	100 feet	100 feet	100 feet
Urban <i>downspeeds</i> - more than 25 mph to 40 mph***	250 feet	250 feet	250 feet
Urban <i>downspeeds</i> - more than 40 mph***	350 feet	350 feet	350 feet
Rural	500 feet	500 feet	500 feet
Expressway / Freeway	1,000 feet	1,500 feet	2,640 feet

\* *Speed upstream to be determined by the highway engineer.*

\*\* The column headings A, B, and C are the dimensions shown in Figures 6H-1 through 6H-46. The A dimension is the distance from the transition or point of restriction to the first sign. The B dimension is the distance between the first and second signs. The C dimension is the distance between the second and third signs. (The "first sign" is the sign in a three-sign series that is closest to the TTC zone. The "third sign" is the sign that is furthest upstream from the TTC zone.)

\*\*\* Posted speed limit, off-peak 85th-percentile speed prior to work starting, or other anticipated operating speed in mph.

Plan Scale  
1" = 50'

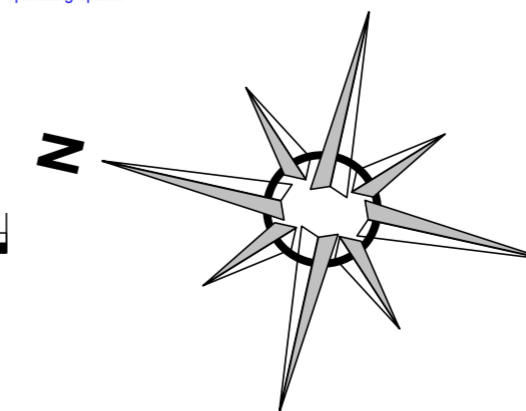

3450 3RD ST #3C  
SAN FRANCISCO, CA 94124  
415-206-1700 PHONE  
415-206-1711 FAX  
INFO@CMCTRAFFIC.COM

LICENSE NO 792059  
CLASS A, 31, C21  
WBE/SBE/LBE/DBE CERTIFIED  
WWW.CMCTRAFFIC.COM

**Date:** 10/06/2020 **Author:** AM/DD **Project:** SAFE ROUTE TO SCHOOL PROJECT  
**Client:** VANGUARD CONSTRUCTION **Location:** BENICIA, RIO VISTA, VALLEJO **TCP:** 001  
**CMC Job #:** 2667 **REV:** 0

**Comments:**

- 1) WORK HOURS: SEE TRAFFIC LANE REQUIREMENTS TABLE
- 2) CONTRACTOR TO VERIFY EXISTING STRIPING IS ACCURATE PRIOR TO START OF WORK.
- 3) ALL TRAFFIC CONTROL SHALL CONFORM TO THE LATEST EDITION OF CA MUTCD.
- 4) ALL TRAFFIC CONTROL DEVICES SHALL BE RETROREFLECTIVE IF SETUP DURING HOURS OF DARKNESS.
- 5) MAINTAIN LOCAL ACCESS TO BUSINESSES AND RESIDENTS AT ALL TIME.
- 6) THE CONTRACTOR SHALL NOT PREVENT OR DELAY THE OPERATION OF MASS TRANSIT VEHICLES AT ANY TIME. CONTRACTOR SHALL COORDINATE WITH TRANSIT SERVICES PRIOR TO WORK TO RELOCATE BUS STOP.
- 7) THE CONTRACTOR SHALL PERFORM THE APPROPRIATE MEASURES TO ENSURE THE SAFETY OF BICYCLISTS ON ALL STREET ON WHICH THERE IS CONSTRUCTION.



**TRAFFIC CONTROL PLAN  
EAST ROMIE LANE MID-BLOCK CROSSING IMPROVEMENTS  
CURB RAMP WORK PLAN - SALINAS, CA**

**DRAFT**

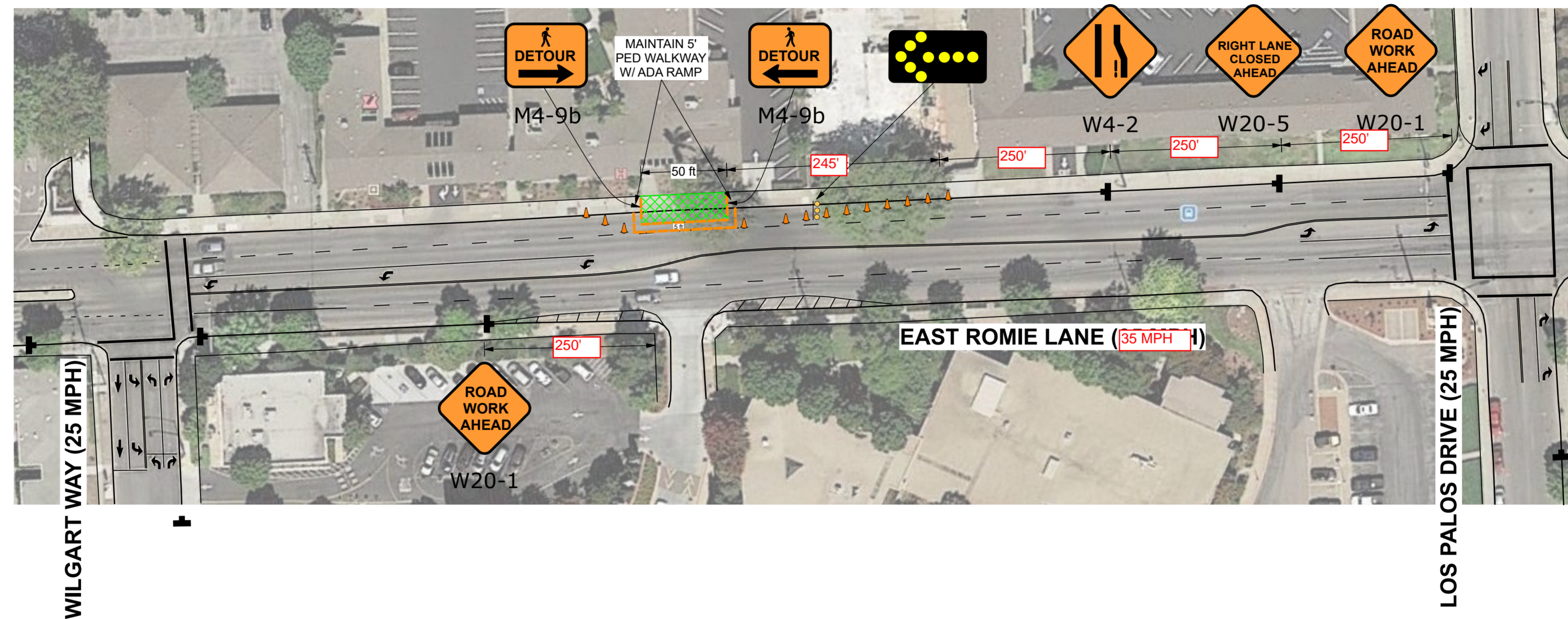

**Legend**

- Type III Barricade
- 28" Traffic Cone
- Delineator
- Compliance Barricade
- Work Area
- Sign and Stand
- Direction of Travel
- Concrete K-Rail
- Crash Cushion
- NTS Not To Scale
- TA/NS Tow-Away/No Stopping
- Parking Control Officer
- Flagger
- Type I Barricade
- Flashing Beacon
- (N) Sewer

**Table 6C-3(CA). Taper Length Criteria for Temporary Traffic Control Zones**  
(for 12 feet Offset Width)

Speed* S (mph)	Minimum Taper Length** for Width of Offset 12 feet (W)			
	Merging L (feet)	Shifting L/2 (feet)	Shoulder L/3 (feet)	Down Stream (feet)***
20	80	40	27	50
25	125	63	42	50
30	180	90	60	50
35	245	123	82	50
40	320	160	107	50
45	540	270	180	50
50	600	300	200	50
55	660	330	220	50
60	720	360	240	50
65	780	390	260	50
70	840	420	280	50
75	900	450	300	50

\* - Posted speed limit, off-peak 85th-percentile speed prior to work starting, or the anticipated operating speed in mph.

\*\* - For other offsets use the following merging taper length formula for L:

For speeds of 40 mph or less,  $L = WS/60$   
For speeds of 45 mph or more,  $L = WS$   
Where:  
L = taper length in feet  
W = width of offset in feet  
S = posted speed limit, off-peak 85th-percentile speed prior to work starting, or the anticipated operating speed in mph

\*\*\* - Maximum downstream taper length is 100 feet. See Section 6C.08.

**Table 6F-101(CA). Maximum Spacing of Channelizing Devices**

Speed (mph)	Maximum Channelizing Devices Spacing		
	Taper* (feet)	Tangent (feet)	Conflict** (feet)
20	20	40	10
25	25	50	12
30	30	60	15
35	35	70	17
40	40	80	20
45	45	90	22
50	50	100	25
55	50	100	25
60	50	100	25
65	50	100	25
70	50	100	25
75	50	100	25

\* Maximum channelizing device spacing for all speeds on one-lane/two-way tapers is 20 feet.  
Maximum channelizing device spacing for all speeds on downstream tapers is 20 feet.  
All other tapers are as shown.

\*\* Use on intermediate and short-term projects for taper and tangent sections where there are no pavement markings or where there is a conflict between existing pavement markings and channelizing devices.

**Table 6C-1. Recommended Advance Warning Sign Minimum Spacing**

Road Type	Distance Between Signs**		
	A	B	C
Urban - <u>down to 25 mph or less***</u>	100 feet	100 feet	100 feet
Urban - <u>more than 25 mph to 40 mph***</u>	250 feet	250 feet	250 feet
Urban - <u>down to more than 40 mph***</u>	350 feet	350 feet	350 feet
Rural	500 feet	500 feet	500 feet
Expressway / Freeway	1,000 feet	1,500 feet	2,640 feet

\* Speed not to be determined by the highway agency.

\*\* The column headings A, B, and C are the dimensions shown in Figures 6H-1 through 6H-46. The A dimension is the distance from the transition or point of restriction to the first sign. The B dimension is the distance between the first and second signs. The C dimension is the distance between the second and third signs. (The "first sign" is the sign in a three-sign series that is closest to the TTC zone. The "third sign" is the sign that is furthest upstream from the TTC zone.)

\*\*\* Posted speed limit, off-peak 85th-percentile speed prior to work starting, or other anticipated operating speed in mph.

Plan Scale  
1" = 50'

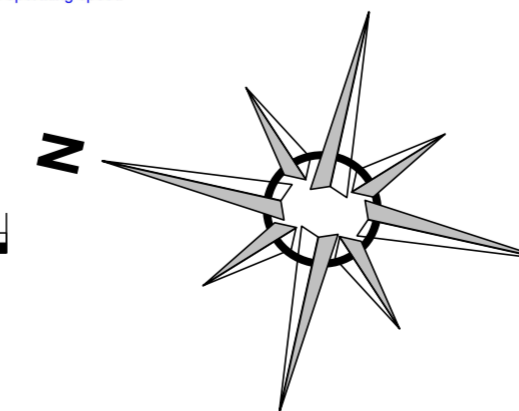

3450 3RD ST #3C  
SAN FRANCISCO, CA 94124  
415-206-1700 PHONE  
415-206-1711 FAX  
INFO@CMCTRAFFIC.COM

LICENSE NO 792059  
CLASS A, 31, C21  
WBE/SBE/LBE/DBE CERTIFIED  
WWW.CMCTRAFFIC.COM

**Date:** 10/06/2020 **Author:** AM/DD **Project:** SAFE ROUTE TO SCHOOL PROJECT  
**Client:** VANGUARD CONSTRUCTION **Location:** BENICIA, RIO VISTA, VALLEJO **TCP:** 002  
**CMC Job #:** 2667 **REV:** 0

**Comments:**

- 1) WORK HOURS: SEE TRAFFIC LANE REQUIREMENTS TABLE
- 2) CONTRACTOR TO VERIFY EXISTING STRIPING IS ACCURATE PRIOR TO START OF WORK.
- 3) ALL TRAFFIC CONTROL SHALL CONFORM TO THE LATEST EDITION OF CA MUTCD.
- 4) ALL TRAFFIC CONTROL DEVICES SHALL BE RETROREFLECTIVE IF SETUP DURING HOURS OF DARKNESS.
- 5) MAINTAIN LOCAL ACCESS TO BUSINESSES AND RESIDENTS AT ALL TIME.
- 6) THE CONTRACTOR SHALL NOT PREVENT OR DELAY THE OPERATION OF MASS TRANSIT VEHICLES AT ANY TIME. CONTRACTOR SHALL COORDINATE WITH TRANSIT SERVICES PRIOR TO WORK TO RELOCATE BUS STOP.
- 7) THE CONTRACTOR SHALL PERFORM THE APPROPRIATE MEASURES TO ENSURE THE SAFETY OF BICYCLISTS ON ALL STREET ON WHICH THERE IS CONSTRUCTION.

