



ENGINEER'S REPORT

MIRA MONTE MAINTENANCE DISTRICT
ASSESSMENT DISTRICT NO. 2000-1
(Pursuant to Article II, Chapter 21C of the Salinas City Code)

Fiscal Year 2017 - 2018

Auditor's Copy

ENGINEER'S REPORT

**MIRA MONTE MAINTENANCE DISTRICT
ASSESSMENT DISTRICT NO. 2000-1
(Pursuant to Article II, Chapter 21C of the Salinas City Code)**

Fiscal Year 2017 – 2018

The undersigned respectfully submits the enclosed report as directed by the City Council.

DATED: _____, 2017.

JAMES E. SANDOVAL, City Engineer

By: _____

I HEREBY CERTIFY that the enclosed Engineer's Report, together with Assessment and Assessment Diagram thereto attached, was filed with me on the ____ day of _____, 2017.

PATRICIA M. BARAJAS, City Clerk
City of Salinas, Monterey County, California

By: _____

I HEREBY CERTIFY that the enclosed Engineer's Report, together with Assessment and Assessment Diagram thereto attached, was approved and confirmed by the City Council of the City of Salinas, California, on the ____ day of _____, 2017.

PATRICIA M. BARAJAS, City Clerk
City of Salinas, Monterey County, California

By: _____

I HEREBY CERTIFY that the enclosed Engineer's Report, together with Assessment and Assessment Diagram thereto attached, was filed with the County Auditor of the County of Monterey on the ____ day of _____, 2017.

PATRICIA M. BARAJAS, City Clerk
City of Salinas, Monterey County, California

By: _____

ENGINEER'S REPORT

MIRA MONTE MAINTENANCE DISTRICT (LANDSCAPE & LIGHTING DISTRICT NO. 2) ASSESSMENT DISTRICT NO. 2000-1 (Pursuant to Article II, Chapter 21C of the Salinas City Code)

Fiscal Year 2017 - 2018

ROBERT C. RUSSELL, Engineer of Work for Assessment District No. 2000-1, City of Salinas, Monterey County, California, makes this report, as directed by the City Council, pursuant to Section 22585 of the Streets and Highways Code (Landscaping and Lighting Act of 1972).

The maintenance, repair, reconstruction, and operation of the public improvements, which are the subject of this report, are briefly described as follows:

1. Maintenance, repair, reconstruction, and operation of the landscaping, irrigation systems, and public improvements within said district. Public improvements include curbs, gutters, asphalt street improvements, sidewalks, masonry walls, concrete-paver driveway clusters, parkway strips adjacent to curbs, landscape easements, tot lots, landscaped open space parcels, appurtenant water mains, irrigation systems, public lighting fixtures on all streets and driveway clusters listed below. This maintenance, servicing and operation is in accordance with NPDES requirements of the City of Salinas storm water permit.
 - Fitzgerald Street – landscaped Parcel D (approx. 1,679 SF) with Trellis and bench, 4 cluster driveways (approx. 13,103 SF), street improvements from Hemmingway Drive to 150 feet more or less west of Bradbury, including curbs, gutters, and sidewalks (approx. 33,100 SF), and street frontage landscaping (approx. 4,250 SF); and
 - Southerly portion of Hemingway Drive – landscaped Parcels I (approx. 2,166 SF), J (approx. 3,920 SF) and K (approx. 1,578 SF), 3 cluster driveways (approx. 7,352 SF), and street frontage landscaping (approx. 8,336 SF) from Fitzgerald Street northerly 1,010 feet more or less to Nantucket Boulevard; and
 - Southerly Portion of Bradbury Drive – landscaped Parcel E [Tot Lot] (approx. 5,669 SF) with play equipment, 11 cluster driveways (approx. 45,958 SF) and street frontage landscaping (approx. 9,435 SF) from Fitzgerald Street northerly 870 feet more or less to Nantucket Boulevard, and 1,900 feet more or less northerly to Boronda Road; and
 - Northerly Portion of Bradbury Drive – landscaped Parcel G [Tot Lot] (approx. 5,896 SF) with play equipment, 10 cluster driveways (approx. 58,941 SF) and street frontage landscaping (approx. 12,745 SF) from Nantucket Boulevard northerly 900 feet more or less to a cul-de-sac near Boronda Road, including “emergency access- turf block”; and
 - Longfellow Drive – 1 cluster driveway, and street frontage landscaping from Hemingway Drive to Bradbury Street.

2. Maintenance, repair, reconstruction, and operation may include, but not limited to spraying pesticides, manicure care of landscaped areas, debris removal, remove and replacement of concrete sidewalks and pavers, street resurfacing and/or reconstruction, and any and all other items of work necessary and incidentals, such as utilities, engineering, inspection, contract administration, etc., for the proper maintenance, repair, reconstruction, and operation thereof. Other incidental costs such as contingencies, assessment collection costs, legal fees, and administration are assessed to and paid by the District on the same basis as the improvements specified above.

The public improvements along Nantucket Boulevard and Parcels A, B, C, and C1, (P.G. & E.'s Tower Line right-of-way) of the Vesting Tentative Map for the Cottages of Mira Monte, a Planned Unit Development are not included in this maintenance assessment district; as they are included in the existing North/East Area Maintenance District (Landscape Maintenance District No. 1).

This report consists of six parts, as follows:

PART A - Plans and specifications for the improvements. Although separately bound, the plans and specifications are a part of this report and are included in it by reference.

PART B - An estimate of the cost of the maintenance, repair, and operation.

PART C - An assessment of the estimated cost of the improvement on each benefited parcel of land within the assessment district.

PART D - A statement of the method by which the undersigned has determined the amount proposed to be assessed against each parcel.

PART E - A list of names and addresses of the owners of real property within this assessment district, as shown on the last equalized assessment roll for taxes, or as known to the Clerk.

PART F - A diagram showing all of the parcels of real property within this assessment district. (Note: The diagram is keyed to Part C by assessment number.)

Respectfully submitted,

JAMES E. SANDOVAL, City Engineer
Engineer of Work

PART A

ENGINEER'S REPORT

MIRA MONTE MAINTENANCE DISTRICT

ASSESSMENT DISTRICT NO. 2000-1

(Pursuant to Article II, Chapter 21C of the Salinas City Code)

Fiscal Year 2017 - 2018

Plans and specifications for the improvements to be maintained are those prepared by the H.D. Peters & Company (Streets, Sidewalks, etc.) and David G. Ralfe & Associates (Landscaping). These plans and specifications are filed separately in the office of the Department of Public Works and Maintenance Services Division of the City of Salinas and are hereby incorporated in this Report by reference.

PART B

ENGINEER'S REPORT

MIRA MONTE MAINTENANCE DISTRICT
ASSESSMENT DISTRICT NO. 2000-1
(Pursuant to Article II, Chapter 21C of the Salinas City Code)

Fiscal Year 2017 - 2018

| BUDGET ITEM | AMOUNT |
|---------------------------------------|----------------------|
| DIRECT COSTS | |
| Maintenance | |
| In-House Inspection | \$ 16,320.00 |
| Maintenance | \$ 50,000.00 |
| Special Dept. Supplies | \$ 3,412.22 |
| Water | \$ 30,000.00 |
| Utilities | |
| Street Lights / Electricity | \$ 4,000.00 |
| Direct Subtotal | \$ 103,732.22 |
| ADMINISTRATION COSTS | |
| Agency Administrative Expenses | \$ 15,000.00 |
| Professional Fees | \$ 4,000.00 |
| City's Collection Fee | \$ 2,030.00 |
| Administrative Subtotal | \$ 21,030.00 |
| CAPITAL IMPROVEMENT PROJECT | |
| Capital Improvement Expenses | \$ - |
| LEVY BREAKDOWN | |
| Total Direct, Admin and Capital Costs | \$ 124,762.22 |
| Operating Reserve Collection | \$ - |
| Capital Reserve Collection | \$ - |
| Levy Breakdown Subtotal | \$ 124,762.22 |
| LEVY ADJUSTMENTS | |
| Operating Reserve Contribution | \$ - |
| Capital Reserve Contribution | \$ - |
| Additional City Contribution | \$ - |
| Estimated Interest Earnings | \$ (2,000.00) |
| Levy Adjustments Subtotal | \$ (2,000.00) |
| BALANCE TO LEVY | \$ 122,762.22 |
| OPERATING RESERVE | |
| Estimated Balance at June 30, 2017 | \$ - |
| FY2017/2018 Collection/(Contribution) | \$ - |
| Estimated Balance at June 30, 2018 | \$ - |
| CAPITAL IMPROVEMENT RESERVE | |
| Estimated Balance at June 30, 2017 | \$ 143,900.00 |
| FY2017/2018 Collection/(Contribution) | \$ - |
| Estimated Balance at June 30, 2018 | \$ 143,900.00 |
| DISTRICT STATISTICS | |
| Total Parcels | 203 |
| Total Parcels Levied | 203 |
| Parcel Assessment Rate | |
| Rate per Parcel | \$ 594.74 |

```

R ..... Page 1 ..... T
<AMD.DEF> Assessment & Maintenance District Definition Update

District Code : 2000-1

1) Description : Mira Monte Maint. District
2) District Type : M Maintenance District
3) County Tax Code : 656 Mira Monte Maintenance Distric
4) Allow Updates : Y
5) Actual Assesmnt : Y
6) Cash Deadline : _____
7) Proposed Total : _____

** Assessment Districts ***          ***** Maintenance Districts *****
8) Bond Discount Pcnt: _____ % 10) City Pcnt Fee : _____ %
9) Bond Reserve Pcnt : _____ % 11) City Flat Fee : 10.00 or : _____ %
12) County Pcnt Fee: _____ %
13) County Flat Fee: _____ or : _____ %

OPTIONS: (F)ile, (E)nd, (DEL)ete, field <#> to change,
(CD) Code Screen, (ZN) Zoning Screen, (SUM)mary, (PAR)cel detail
(N)ext (P)revious or (PRINT) Screen, (.H)elp for additional options
F ..... 11:40:06 05 JUN 2017 ..... G

```

```

R ..... Page 1 ..... T
<AMD.DEF.SUM> Assessment & Maintenance District Summary Inquiry

Maintenance District
District : 2000-1 Mira Monte Maint. District

Last Calculated : 26 JUL 2016

Number of Parcels : 203

Total Detail : 120,732.22

Bond Discount :
Bond Reserve :

City Fee : 2,030.00 or 10.00
County Fee :

Total Amount : 122,762.22

OPTIONS: (F)ile, (SUM)mary, (PAR)cel detail,
(CD) Action Code Screen, (ZN) Zoning Screen, (PRINT) Screen, (DEF),
(WF) Window Forward, (WB) Window Back, (N)ext or (P)revious Screen
F ..... 09:23:04 05 JUN 2017 ..... G

```

```

R ..... Page 1 ..... T
<AMD.DEF.CD> Assessment & Maintenance District Action Code Inquiry

District : 2000-1 Mira Monte Maint. District

Code Description..... Unit Unit Description Unit Cost
1) 1 Assessment per S.F.U. pp Per Parcel 594.7400
2) 2 Assessment per S.F.U. ea 594.7400
3) _____
4) _____
5) _____
6) _____
7) _____
8) _____
9) _____
10) _____
11) _____
12) _____
13) _____
14) _____
15) _____

OPTIONS: (F)ile, (SUM)mary, (PAR)cel detail,
(DEF) Definition Master Screen, (ZN) Zoning Screen, (PRINT) Screen,
(WF) Window Forward, (WB) Window Back, (N)ext or (P)revious Screen
F ..... 09:11:05 05 JUN 2017 ..... G

```

```

R ..... Page 1 ..... T
<AMD.DEF.CDS> Action Code Summary Totals

District : 2000-1 Mira Monte Maint. District

Code Description..... Count Total Quantity Total Cost
1) 1 Assessment per S.F.U. 203 203.00 120,732.22
2) 2 Assessment per S.F.U.
3) _____
4) _____
5) _____
6) _____
7) _____
8) _____
9) _____
10) _____
11) _____
12) _____
13) _____
14) _____
15) _____

OPTIONS: (F)ile, (SUM)mary, (PAR)cel detail,
(DEF) Definition Master Screen, (ZN) Zoning Screen, (PRINT) Screen,
(WF) Window Forward, (WB) Window Back, (N)ext or (P)revious Screen
F ..... 09:12:45 05 JUN 2017 ..... G

```

<AMD.DEF.ZN> Assessment & Maintenance District Zoning Code Inquiry

District : 2000-1 Mira Monte Maint. District

| | ZoningCode | Description..... | Frontage Multiplr | Area Multiplr | Parcel Count |
|-----|------------|----------------------------|----------------------|------------------|-----------------|
| 1) | OS | Open Space | 1.0000 | 1.0000 | 14 |
| 2) | PS | Public and Semipublic | 1.0000 | 1.0000 | |
| 3) | R-L-5.5 | Low Density Residential | 1.0000 | 1.0000 | 20 |
| 4) | R-L-6.5 | Low Density Residential | 1.0000 | 1.0000 | |
| 5) | R-M-2.9 | Medium Density Residential | 1.0000 | 1.0000 | 183 |
| 6) | R-M-3.6 | Medium Density Residential | 1.0000 | 1.0000 | |
| 7) | R-M-4.0 | Medium Density Residential | 1.0000 | 1.0000 | |
| 8) | _____ | _____ | _____ | _____ | |
| 9) | _____ | _____ | _____ | _____ | |
| 10) | _____ | _____ | _____ | _____ | |
| 11) | _____ | _____ | _____ | _____ | |
| 12) | _____ | _____ | _____ | _____ | |
| 13) | _____ | _____ | _____ | _____ | |
| 14) | _____ | _____ | _____ | _____ | |
| 15) | _____ | _____ | _____ | _____ | |

. OPTIONS: (E)nd, (SUM)mary, (PAR)cel detail,
 . (DEF) Definition Master Screen, (CD) Code Screen, (PRINT) Screen,
 . (WF) Window Forward, (WB) Window Back, (N)ext or (P)revious Screen

PART C

ENGINEER'S REPORT

**MIRA MONTE MAINTENANCE DISTRICT
ASSESSMENT DISTRICT NO. 2000-1
(Pursuant to Article II, Chapter 21C of the Salinas City Code)**

Fiscal Year 2017 - 2018

ASSESSMENT ROLL BY PARCEL

See "Part E" of this report.

PART D

ENGINEER'S REPORT

MIRA MONTE MAINTENANCE DISTRICT ASSESSMENT DISTRICT NO. 2000-1 (Pursuant to Article II, Chapter 21C of the Salinas City Code)

Fiscal Year 2017 - 2018

METHOD OF DISTRIBUTION OF COSTS

The cost of maintenance, repair, reconstruction, and operation for this district are distributed equally among the total number of single family units (SFU) within the district boundaries, or approved SFU pursuant to Vesting Tentative Map No. 99-1 which are within the district boundaries.

Proposed and existing community open space parcels, neighborhood parklands, creeks, flood control, utility, and landscape easements, or parcels not developable independently are not assessed.

Common area parcels within Mira Monte's Development project are not assessed, as unit assessments allow for this use.

All assessed parcels (units) shall be assessed an additional \$10.00 for the City's collection fee.

In any year beyond fiscal year 2005/2006, the assessment on each parcel shall increase based on the amount of the increase in the Engineers News Record (ENR) Index of the previous calendar year.

The amount assessed is based upon the special benefits to be derived by the various properties within the district. The facilities and infrastructure to be maintained, repaired, reconstructed, and operated confer no general benefit upon the public at large inasmuch as these facilities and infrastructure serve only the entire Mira Monte Development project.

PART E

ENGINEER'S REPORT

**MIRA MONTE MAINTENANCE DISTRICT
ASSESSMENT DISTRICT NO. 2000-1
(Pursuant to Article II, Chapter 21C of the Salinas City Code)**

Fiscal Year 2017 - 2018

PROPERTY OWNERS LIST

Attached hereto are the names and addresses of each property owner as shown on the County Assessor's tax roll.

| Parcel..... | Situs Address..... | Owner Address..... | Assessment.... | City Fee.. | County Fee | Total Levy.... |
|--------------|----------------------|---|----------------|------------|------------|----------------|
| 153261035000 | 975 Longfellow Dr | Jensen Anna M 975 Longfellow Dr Salinas, CA 93906 | 594.74 | 10.00 | | 604.74 |
| 153261036000 | 979 Longfellow Dr | Cardenas Jose 979 Longfellow Dr Salinas, CA 93905 | 594.74 | 10.00 | | 604.74 |
| 153261037000 | 981 Longfellow Dr | Chen Jianguo 3965 Chamberer Dr San Jose, CA 95135 | 594.74 | 10.00 | | 604.74 |
| 153261038000 | 983 Longfellow Dr | Gonzales Sergio & Malory 983 Longfellow Dr Salinas, CA 93906 | 594.74 | 10.00 | | 604.74 |
| 153261039000 | 987 Longfellow Dr | Abuella Ali M 987 Longfellow Dr Salinas, CA 93906 | 594.74 | 10.00 | | 604.74 |
| 153261041000 | 976 Longfellow Dr | Jiang Liansong 4578 Rhapsody Way San Jose, CA 95111 | 594.74 | 10.00 | | 604.74 |
| 153261042000 | 980 Longfellow Dr | Byroju Venkat K & Byroju Rajani 625 Hammersmith Dr Suwanee, GA 30024 | 594.74 | 10.00 | | 604.74 |
| 153261043000 | 984 Longfellow Dr | Yates David Scott 984 Longfellow Dr Salinas, CA 93906 | 594.74 | 10.00 | | 604.74 |
| 153261044000 | 988 Longfellow Dr | Moncayo Erika & Anthony 988 Longfellow Dr Salinas, CA 93906 | 594.74 | 10.00 | | 604.74 |
| 153262001000 | 1901 Bradbury Street | Alejo Isaac Jacob 1901 Bradbury St Salinas, CA 93906 | 594.74 | 10.00 | | 604.74 |
| 153262002000 | 1903 Bradbury Street | Hibert Thomas J & Laura E Hiber t Trs 843 Via Mirada Monterey, CA 93940 | 594.74 | 10.00 | | 604.74 |
| 153262003000 | 1905 Bradbury Street | Cuevas Elizabeth Marie 1905 Bradbury St Salinas, CA 93906 | 594.74 | 10.00 | | 604.74 |
| 153262004000 | 1907 Bradbury Street | Contreras Benjamin E & Rosa Mar ia Calderon 1907 Bradbury St Salinas, CA 93906 | 594.74 | 10.00 | | 604.74 |
| 153262005000 | 1909 Bradbury Street | Castillo Linda R 1909 Bradbury St Salinas, CA 93906 | 594.74 | 10.00 | | 604.74 |
| 153262006000 | 1911 Bradbury Street | Parks John & Diane 1911 Bradbury St Salinas, CA 93906 | 594.74 | 10.00 | | 604.74 |
| 153262007000 | 1915 Bradbury Street | Iniakov Alexander & Romyana 8424 Hidden Ridge Road Salinas, CA 93907 | 594.74 | 10.00 | | 604.74 |
| 153262008000 | 1919 Bradbury Street | Rivera Mauricio D & Lorsche Tu azon 1919 Bradbury St Salinas, CA 93906 | 594.74 | 10.00 | | 604.74 |

CITY OF SALINAS
Assessment Roll by Parcel
District 2000-1 Mira Monte Maint. District

| Parcel..... | Situs Address..... | Owner Address..... | Assessment.... | City Fee.. | County Fee | Total Levy.... |
|--------------|----------------------|--|----------------|------------|------------|----------------|
| 153262009000 | 1921 Bradbury Street | Hernandez Socrates Et Al 1921 Bradbury St Salinas, CA 93906 | 594.74 | 10.00 | | 604.74 |
| 153262010000 | 1923 Bradbury Street | Hernandez Salvador 1923 Bradbury St Salinas, CA 93906 | 594.74 | 10.00 | | 604.74 |
| 153262011000 | 1925 Bradbury Street | Esquivel Rose M 1925 Bradbury St Salinas, CA 93906 | 594.74 | 10.00 | | 604.74 |
| 153262012000 | 1927 Bradbury Street | Franco Antonio F 1927 Bradbury St Salinas, CA 93906 | 594.74 | 10.00 | | 604.74 |
| 153262013000 | 1929 Bradbury Street | Handley Jill A 1929 Bradbury St Salinas, CA 93906 | 594.74 | 10.00 | | 604.74 |
| 153262014000 | 1931 Bradbury Street | Banuelos Irene M 1931 Bradbury St Salinas, CA 93906 | 594.74 | 10.00 | | 604.74 |
| 153262015000 | 1933 Bradbury Street | Shu Lianghua & Qiyu Li 16235 50th Ave N Plymouth, MN 55446 | 594.74 | 10.00 | | 604.74 |
| 153262016000 | 1935 Bradbury Street | Ravan Olivia M 1935 Bradbury St Salinas, CA 93906 | 594.74 | 10.00 | | 604.74 |
| 153262017000 | 1939 Bradbury Street | Duarte John R 1939 Bradbury St Salinas, CA 93906 | 594.74 | 10.00 | | 604.74 |
| 153262018000 | 1941 Bradbury Street | Sarmiento Romano B & Aimee T 1941 Bradbury St Salinas, CA 93906 | 594.74 | 10.00 | | 604.74 |
| 153262019000 | 1943 Bradbury Street | Colvin Matthew C & Costelow-col vin Jennifer 1943 Bradbury St Salinas, CA 93906 | 594.74 | 10.00 | | 604.74 |
| 153262020000 | 1945 Bradbury Street | Yuan Jing-dong & Yang Zhang 911 Padre Dr Salinas, CA 93901 | 594.74 | 10.00 | | 604.74 |
| 153262021000 | 1947 Bradbury Street | Kahn Harold R & Kathleen M 1947 Bradbury St Salinas, CA 93906 | 594.74 | 10.00 | | 604.74 |
| 153262022000 | 1949 Bradbury Street | Reyno Gerry A & Reyno Lorna A 1949 Bradbury St Salinas, CA 93906 | 594.74 | 10.00 | | 604.74 |
| 153262023000 | 1951 Bradbury Street | Gomez Eleazar & Gomez Claudia F 1951 Bradbury St Salinas, CA 93906 | 594.74 | 10.00 | | 604.74 |
| 153262024000 | 1955 Bradbury Street | Nieto Charles & Beatrice Trs 9735 Hillview Terr Salinas, CA 93907 | 594.74 | 10.00 | | 604.74 |
| 153262025000 | 1957 Bradbury Street | Barnett Kimberly Ann 1957 Bradbury St Salinas, CA 93906 | 594.74 | 10.00 | | 604.74 |
| 153262026000 | 1959 Bradbury Street | Zhao Min & Weidong Wang 1240 Campana Way | 594.74 | 10.00 | | 604.74 |

CITY OF SALINAS
Assessment Roll by Parcel
District 2000-1 Mira Monte Maint. District

| Parcel..... | Situs Address..... | Owner Address..... | Assessment.... | City Fee.. | County Fee | Total Levy.... |
|--------------|----------------------|---|----------------|------------|------------|----------------|
| | | Salinas, CA 93905 | | | | |
| 153262027000 | 1961 Bradbury Street | Pacio Mario & Mary 1961 Bradbury St Salinas, CA 93906 | 594.74 | 10.00 | | 604.74 |
| 153262028000 | 1963 Bradbury Street | Hoover Johnny L 1963 Bradbury St Salinas, CA 93906 | 594.74 | 10.00 | | 604.74 |
| 153262029000 | 1965 Bradbury Street | Quizon Teresa M 1965 Bradbury St Salinas, CA 93906 | 594.74 | 10.00 | | 604.74 |
| 153262030000 | 1967 Bradbury Street | Palomares Yolanda 2074 Naida Ave San Jose, CA 95122 | 594.74 | 10.00 | | 604.74 |
| 153262031000 | 1969 Bradbury Street | Oliver Audrey L 1969 Bradbury St Salinas, CA 93906 | 594.74 | 10.00 | | 604.74 |
| 153262032000 | 1971 Bradbury Street | Jordan James C & Lugo Guadalupe I 1971 Bradbury St Salinas, CA 93906 | 594.74 | 10.00 | | 604.74 |
| 153262033000 | 1973 Bradbury Street | Bellam Suresh & Uma 1199 E Pat Clinton Rd Unit # 60 7 Vernon, FL 60061 | 594.74 | 10.00 | | 604.74 |
| 153262034000 | 1975 Bradbury Street | Morford Jay A & Lynn A Oschmann Tr 22644 Oak Canyon Rd Salinas, CA 93908 | 594.74 | 10.00 | | 604.74 |
| 153262035000 | 1977 Bradbury Street | Nevin Nancy 1977 Bradbury St Salinas, CA 93906 | 594.74 | 10.00 | | 604.74 |
| 153262036000 | 1979 Bradbury Street | Pena Tony & Green Shara L 1979 Bradbury St Salinas, CA 93906 | 594.74 | 10.00 | | 604.74 |
| 153262037000 | 1987 Bradbury Street | Rodriguez Jose Et Al 1987 Bradbury St Salinas, CA 93906 | 594.74 | 10.00 | | 604.74 |
| 153262038000 | 1991 Bradbury Street | Mohler Howard & Carmen S 1991 Bradbury St Salinas, CA 93906 | 594.74 | 10.00 | | 604.74 |
| 153262039000 | 1995 Bradbury Street | Hollines Jennifer J Tr 1995 Bradbury St Salinas, CA 93906 | 594.74 | 10.00 | | 604.74 |
| 153262040000 | 1999 Bradbury Street | Shi Ning & Yao Chen Lei 3253 Falls Creek Dr San Jose, CA 95135 | 594.74 | 10.00 | | 604.74 |
| 153262041000 | 1902 Bradbury Street | Esparza Sergio E 1902 Bradbury St Salinas, CA 93906 | 594.74 | 10.00 | | 604.74 |
| 153262042000 | 1904 Bradbury Street | Burns William H Jr & Suzanne M 1904 Bradbury St Salinas, CA 93906 | 594.74 | 10.00 | | 604.74 |
| 153262043000 | 1906 Bradbury Street | Bermudez Regugio 1906 Bradbury St | 594.74 | 10.00 | | 604.74 |

CITY OF SALINAS
Assessment Roll by Parcel
District 2000-1 Mira Monte Maint. District

| Parcel..... | Situs Address..... | Owner Address..... | Assessment.... | City Fee.. | County Fee | Total Levy.... |
|-------------------|----------------------|--|----------------|------------|------------|----------------|
| Salinas, CA 93906 | | | | | | |
| 153262044000 | 1908 Bradbury Street | Dodds Steven M & Zamora T 1908 Bradbury St Salinas, CA 93905 | 594.74 | 10.00 | | 604.74 |
| 153262045000 | 1910 Bradbury Street | Salas Vanessa V & Alfredo 1910 Bradbury St Salinas, CA 93906 | 594.74 | 10.00 | | 604.74 |
| 153262046000 | 1912 Bradbury Street | Gu Qi & Chen Yamin 2636 Sunnycrest Ct Fremont, CA 94539 | 594.74 | 10.00 | | 604.74 |
| 153262047000 | 1914 Bradbury Street | Tapia Jose L 1914 Bradbury St Salinas, CA 93906 | 594.74 | 10.00 | | 604.74 |
| 153262048000 | 1916 Bradbury Street | Landon Robert & Sunhye K 1090 Faulkner St Salinas, CA 93906 | 594.74 | 10.00 | | 604.74 |
| 153262049000 | 1918 Bradbury Street | Chen Yun Zhi & Ren Xue Ying 1140 E Clark Ave #170 Orcutt, CA 93455 | 594.74 | 10.00 | | 604.74 |
| 153262050000 | 1920 Bradbury Street | Venegas Claudia F 1920 Bradbury St Salinas, CA 93906 | 594.74 | 10.00 | | 604.74 |
| 153262051000 | 1922 Bradbury Street | Dias Frederico C & Rosa 1922 Bradbury St Salinas, CA 93906 | 594.74 | 10.00 | | 604.74 |
| 153262052000 | 1924 Bradbury Street | Rios-dominguez Alejandro & Dinh Thu Thi Minh 1924 Bradbury St Salinas, CA 93906 | 594.74 | 10.00 | | 604.74 |
| 153262053000 | 1926 Bradbury Street | Ramirez Victoriano P Jr 1926 Bradbury St Salinas, CA 93906 | 594.74 | 10.00 | | 604.74 |
| 153262054000 | 1928 Bradbury Street | Dimaggio Joseph L Tr 22 Los Encinos Dr Monterey, CA 93940 | 594.74 | 10.00 | | 604.74 |
| 153262055000 | 1930 Bradbury Street | Valencia Antonio R & Leslie Mar ie 1930 Bradbury St Salinas, CA 93906 | 594.74 | 10.00 | | 604.74 |
| 153262056000 | 1936 Bradbury Street | Anyanwu Nkemjika T 1936 Bradbury St Salinas, CA 93906 | 594.74 | 10.00 | | 604.74 |
| 153262057000 | 1962 Bradbury Street | Robles David M & Griselda 1962 Bradbury St Salinas, CA 93906 | 594.74 | 10.00 | | 604.74 |
| 153262058000 | 1960 Bradbury Street | Becerra Gerardo C & Pina Leonor P 1960 Bradbury St Salinas, CA 93906 | 594.74 | 10.00 | | 604.74 |
| 153262059000 | 1958 Bradbury Street | Bachtelle Jeffrey S & Katherine R 1958 Bradbury St Salinas, CA 93906 | 594.74 | 10.00 | | 604.74 |
| 153262060000 | 1956 Bradbury Street | Cheong Deok Whan & Jung Hwa Trs | 594.74 | 10.00 | | 604.74 |

| Parcel..... | Situs Address..... | Owner Address..... | Assessment.... | City Fee.. | County Fee | Total Levy.... |
|--------------|----------------------|---|----------------|------------|------------|----------------|
| | | 10717 Country Meadows Rd Salinas, CA 93907 | | | | |
| 153262061000 | 1954 Bradbury Street | Adams Altheia M Et Al 1954 Bradbury St Salinas, CA 93906 | 594.74 | 10.00 | | 604.74 |
| 153262062000 | 1964 Bradbury Street | Rajbhandari Sushil K & Shrestha Reena 1964 Bradbury St Salinas, CA 93906 | 594.74 | 10.00 | | 604.74 |
| 153262063000 | 1966 Bradbury Street | Barrientos Anthony 1966 Bradbury St Salinas, CA 93906 | 594.74 | 10.00 | | 604.74 |
| 153262064000 | 1968 Bradbury Street | Chamberlin Rebecca Irene 1968 Bradbury St Salinas, CA 93906 | 594.74 | 10.00 | | 604.74 |
| 153262065000 | 1970 Bradbury Street | Jensen John & Gail 1970 Bradbury St Salinas, CA 93906 | 594.74 | 10.00 | | 604.74 |
| 153262066000 | 1972 Bradbury Street | Chavez Alejandro & Irene P 1972 Bradbury St Salinas, CA 93906 | 594.74 | 10.00 | | 604.74 |
| 153262067000 | 1974 Bradbury Street | Morales Benjamin & Gabriela 1203 Modena St Salinas, CA 93905 | 594.74 | 10.00 | | 604.74 |
| 153262068000 | 1976 Bradbury Street | Storms Richard Ray Jr & Laura K 1976 Bradbury St Salinas, CA 93906 | 594.74 | 10.00 | | 604.74 |
| 153262069000 | 1978 Bradbury Street | Gonzalez Jerry 1978 Bradbury St Salinas, CA 93906 | 594.74 | 10.00 | | 604.74 |
| 153262070000 | 1980 Bradbury Street | Girard Patricia 1980 Bradbury St Salinas, CA 93906 | 594.74 | 10.00 | | 604.74 |
| 153262071000 | 1982 Bradbury Street | Rivas Rafael Antonio & Brenda M 1982 Bradbury St Salinas, CA 93906 | 594.74 | 10.00 | | 604.74 |
| 153262072000 | 1984 Bradbury Street | Liu George & Gina Li 103 Kelly Way Scotts Valley, CA 95066 | 594.74 | 10.00 | | 604.74 |
| 153262073000 | 1986 Bradbury Street | Vasquez Felipe & Lizette 18570 Van Buren Ave Salinas, CA 93906 | 594.74 | 10.00 | | 604.74 |
| 153262074000 | 1988 Bradbury Street | Lebaron Matthew W & Paularae J 1988 Bradbury St Salinas, CA 93906 | 594.74 | 10.00 | | 604.74 |
| 153262075000 | 1990 Bradbury Street | Park Jaeduck & Jinsu 1990 Bradbury St Salinas, CA 93906 | 594.74 | 10.00 | | 604.74 |
| 153262076000 | 1992 Bradbury Street | Gonzales Alexander 1992 Bradbury St Salinas, CA 93906 | 594.74 | 10.00 | | 604.74 |
| 153262077000 | 1994 Bradbury Street | Morin Jake R & Arviso Andrea R 1994 Bradbury St Salinas, CA 93906 | 594.74 | 10.00 | | 604.74 |

| Parcel..... | Situs Address..... | Owner Address..... | Assessment.... | City Fee.. | County Fee | Total Levy.... |
|--------------|----------------------|---|----------------|------------|------------|----------------|
| 153262078000 | 1996 Bradbury Street | Medina Martin 1996 Bradbury St Salinas, CA 93906 | 594.74 | 10.00 | | 604.74 |
| 153262079000 | 1998 Bradbury Street | Ayala Martin & Emma 1998 Bradbury St Salinas, CA 93906 | 594.74 | 10.00 | | 604.74 |
| 153611001000 | 997 Fitzgerald St | Burchell Gregory & Tracy D 997 Fitzgerald St Salinas, CA 93906 | 594.74 | 10.00 | | 604.74 |
| 153611002000 | 999 Fitzgerald St | Martinez Bertha A Et Al 999 Fitzgerald St Salinas, CA 93906 | 594.74 | 10.00 | | 604.74 |
| 153611003000 | 1001 Fitzgerald St | Robledo Sabrina M & Torres Rica rdo R 1001 Fitzgerald St Salinas, CA 93906 | 594.74 | 10.00 | | 604.74 |
| 153611004000 | 1003 Fitzgerald St | Jardini Daniel A & Rodriguez So nia C Trs 225 E Romie Lane Salinas, CA 93901 | 594.74 | 10.00 | | 604.74 |
| 153611005000 | 1005 Fitzgerald St | Chesterman Donald Michael Tr Et Al 18201 Berta Canyon Rd Salinas, CA 93907 | 594.74 | 10.00 | | 604.74 |
| 153611006000 | 1007 Fitzgerald St | Le Nghe Le & Lu Lien Kim 967 Galindo Ct Milpitas, CA 95035 | 594.74 | 10.00 | | 604.74 |
| 153611007000 | 1821 Hemingway Dr | Rodgers Daniel M 1821 Hemingway Dr Salinas, CA 93906 | 594.74 | 10.00 | | 604.74 |
| 153611008000 | 1823 Hemingway Dr | Duffin Sally Y & Hamlet James W 1823 Hemingway Dr Salinas, CA 93906 | 594.74 | 10.00 | | 604.74 |
| 153611009000 | 1825 Hemingway Dr | Price David Jr 1825 Hemingway Dr Salinas, CA 93906 | 594.74 | 10.00 | | 604.74 |
| 153611010000 | 1827 Hemingway Dr | Joo Eun Jin 1827 Hemingway Dr Salinas, CA 93906 | 594.74 | 10.00 | | 604.74 |
| 153611011000 | 1829 Hemingway Dr | Jones Robert Douglas Jr & Tammy Renee 1829 Hemingway Dr Salinas, CA 93906 | 594.74 | 10.00 | | 604.74 |
| 153611012000 | 1831 Hemingway Dr | Baldwin Jack 1831 Hemingway Dr Salinas, CA 93906 | 594.74 | 10.00 | | 604.74 |
| 153611013000 | 1835 Hemingway Dr | Reese Pamela Laura Tr 1835 Hemingway Dr Salinas, CA 93906 | 594.74 | 10.00 | | 604.74 |
| 153611014000 | 1837 Hemingway Dr | Gonzalez-trigueros Misael & Alv arez Elizabeth S 1837 Hemingway Dr Salinas, CA 93906 | 594.74 | 10.00 | | 604.74 |
| 153611015000 | 1839 Hemingway Dr | Marquez Elida C 1839 Hemingway Dr | 594.74 | 10.00 | | 604.74 |

| Parcel..... | Situs Address..... | Owner Address..... | Assessment.... | City Fee.. | County Fee | Total Levy.... |
|--------------|----------------------|--|----------------|------------|------------|----------------|
| | | Salinas, CA 93906 | | | | |
| 153611016000 | 1841 Hemingway Dr | Verduzco Bianca Angela & Alejandro 2100 Alisal Rd Salinas, CA 93908 | 594.74 | 10.00 | | 604.74 |
| 153611017000 | 1851 Hemingway Dr | Rodriguez Israel M 1848 London Salinas, CA 93906 | 594.74 | 10.00 | | 604.74 |
| 153611018000 | 1853 Hemingway Dr | Roy Gabriel & Vimala J 9944 Great Oaks Way Fairfax, VA 22030 | 594.74 | 10.00 | | 604.74 |
| 153611019000 | 1855 Hemingway Dr | Salinas Ruben Resendiz & Perez Sarai Villanueva 1855 Hemingway Dr Salinas, CA 93906 | 594.74 | 10.00 | | 604.74 |
| 153611020000 | 1857 Hemingway Dr | Gabriel Udelio & Genoveva 1857 Hemingway Dr Salinas, CA 93906 | 594.74 | 10.00 | | 604.74 |
| 153611027000 | 1802 Bradbury Street | Jasim Atheel M 1802 Bradbury St Salinas, CA 93906 | 594.74 | 10.00 | | 604.74 |
| 153611028000 | 1804 Bradbury Street | Rodriguez Sergio E & Martha M C 1804 Bradbury St Salinas, CA 93906 | 594.74 | 10.00 | | 604.74 |
| 153611029000 | 1806 Bradbury Street | Dotson-kelly Ethan C & Erin P T rs 1806 Bradbury St Salinas, CA 93906 | 594.74 | 10.00 | | 604.74 |
| 153611030000 | 1808 Bradbury Street | Qualls Angela D 1808 Bradbury St Salinas, CA 93906 | 594.74 | 10.00 | | 604.74 |
| 153611031000 | 1810 Bradbury Street | Garcia Roberto Luna Et Al 1810 Bradbury St Salinas, CA 93906 | 594.74 | 10.00 | | 604.74 |
| 153611032000 | 1812 Bradbury Street | San Juan Joseph O & San Juan Rosalyn G 1812 Bradbury St Salinas, CA 93906 | 594.74 | 10.00 | | 604.74 |
| 153611033000 | 1814 Bradbury Street | Ruvalcaba Teresa 1814 Bradbury St Salinas, CA 93906 | 594.74 | 10.00 | | 604.74 |
| 153611034000 | 1816 Bradbury Street | Ortega Renee S 1816 Bradbury St Salinas, CA 93906 | 594.74 | 10.00 | | 604.74 |
| 153611035000 | 1818 Bradbury Street | Roach Timothy & Trinidad 1818 Bradbury St Salinas, CA 93906 | 594.74 | 10.00 | | 604.74 |
| 153611036000 | 1820 Bradbury Street | Tapia San Juana & Valverde Harvey 1820 Bradbury St Salinas, CA 93906 | 594.74 | 10.00 | | 604.74 |
| 153611037000 | 1822 Bradbury Street | Cleveland Ray A 1822 Bradbury St Salinas, CA 93906 | 594.74 | 10.00 | | 604.74 |

CITY OF SALINAS
Assessment Roll by Parcel
District 2000-1 Mira Monte Maint. District

| Parcel..... | Situs Address..... | Owner Address..... | Assessment.... | City Fee.. | County Fee | Total Levy.... |
|--------------|----------------------|--|----------------|------------|------------|----------------|
| 153611038000 | 1824 Bradbury Street | Jauss Wayne M & Barbara M 1824 Bradbury St Salinas, CA 93906 | 594.74 | 10.00 | | 604.74 |
| 153611039000 | 1826 Bradbury Street | Vega Jeronimo 1826 Bradbury St Salinas, CA 93906 | 594.74 | 10.00 | | 604.74 |
| 153611040000 | 1828 Bradbury Street | Santos Rita Ramirez & Gerardo 1828 Bradbury St Salinas, CA 93906 | 594.74 | 10.00 | | 604.74 |
| 153611041000 | 1832 Bradbury Street | Bustamante Octavio Et Al 1832 Bradbury St Salinas, CA 93906 | 594.74 | 10.00 | | 604.74 |
| 153611042000 | 1834 Bradbury Street | Pacheco Regulo Antonio 1834 Bradbury St Salinas, CA 93906 | 594.74 | 10.00 | | 604.74 |
| 153611043000 | 1836 Bradbury Street | Supnick Susan Marie & Lindsey P eter W 1836 Bradbury St Salinas, CA 93906 | 594.74 | 10.00 | | 604.74 |
| 153611044000 | 1838 Bradbury Street | Leal Anna Lisa & Lopez Richard A 1838 Bradbury St Salinas, CA 93906 | 594.74 | 10.00 | | 604.74 |
| 153611045000 | 1840 Bradbury Street | Becerra Leopoldo Alvarez 1840 Bradbury St Salinas, CA 93906 | 594.74 | 10.00 | | 604.74 |
| 153611046000 | 1842 Bradbury Street | Campos Jose Francisco & Ruelas De Campos Maria A 1842 Bradbury St Salinas, CA 93906 | 594.74 | 10.00 | | 604.74 |
| 153611047000 | 1850 Bradbury Street | Herrera Martin E & Ramirez Albe rto S 1151 Trivoli Way Salinas, CA 93905 | 594.74 | 10.00 | | 604.74 |
| 153611048000 | 1852 Bradbury Street | Hernandez Juan Carlos & Leticia P 1852 Bradbury St Salinas, CA 93906 | 594.74 | 10.00 | | 604.74 |
| 153611049000 | 1854 Bradbury Street | Pimentel Marianna 1854 Bradbury St Salinas, CA 93906 | 594.74 | 10.00 | | 604.74 |
| 153611050000 | 1856 Bradbury Street | Ni Kong Dong 519 Van Nort St King City, CA 93930 | 594.74 | 10.00 | | 604.74 |
| 153611051000 | 1858 Bradbury Street | Diaz Tony Tr 100 Stony Point Rd # 180 Santa Rosa, CA 95401 | 594.74 | 10.00 | | 604.74 |
| 153611052000 | 1860 Bradbury Street | Sazykina Ekaterina 1860 Bradbury St Salinas, CA 93906 | 594.74 | 10.00 | | 604.74 |
| 153611053000 | 1862 Bradbury Street | Richards Jay Anthony & Juana An drea 1862 Bradbury St Salinas, CA 93906 | 594.74 | 10.00 | | 604.74 |
| 153611054000 | 1864 Bradbury Street | U S Bank Na Tr | 594.74 | 10.00 | | 604.74 |

CITY OF SALINAS
Assessment Roll by Parcel
District 2000-1 Mira Monte Maint. District

| Parcel..... | Situs Address..... | Owner Address..... | Assessment.... | City Fee.. | County Fee | Total Levy.... |
|--------------|----------------------|--|----------------|------------|------------|----------------|
| | | 200 Business Park Dr #103 Armonk, NY 10504 | | | | |
| 153611055000 | 1866 Bradbury Street | Huang Tong 20462 Chalet Ln Saratoga, CA 95070 | 594.74 | 10.00 | | 604.74 |
| 153611056000 | 1868 Bradbury Street | Fam Medhat Fam Tr 1868 Bradbury St Salinas, CA 93906 | 594.74 | 10.00 | | 604.74 |
| 153611057000 | 1870 Bradbury Street | Garcia Benjamin Deanda & Deanda Lourdes 1870 Bradbury St Salinas, CA 93906 | 594.74 | 10.00 | | 604.74 |
| 153611058000 | 1872 Bradbury Street | Lee Tak Ming 1872 Bradbury St Salinas, CA 93906 | 594.74 | 10.00 | | 604.74 |
| 153611059000 | 1874 Bradbury Street | Wu Jing Ao & Wu Ren 2718 Andare Ct San Jose, CA 95135 | 594.74 | 10.00 | | 604.74 |
| 153611060000 | 1876 Bradbury Street | Park Chan Man & Julia 1876 Bradbury St Salinas, CA 93906 | 594.74 | 10.00 | | 604.74 |
| 153611061000 | 1878 Bradbury Street | Clavo Berne Jose B & Abendano-c lavo Donna 1878 Bradbury St Salinas, CA 93906 | 594.74 | 10.00 | | 604.74 |
| 153611062000 | 1880 Bradbury Street | Mitchell Luke E 1880 Bradbury St Salinas, CA 93906 | 594.74 | 10.00 | | 604.74 |
| 153611063000 | 1882 Bradbury Street | Martinez Enrique & Martinez Ive tte 1882 Bradbury St Salinas, CA 93906 | 594.74 | 10.00 | | 604.74 |
| 153611064000 | 1884 Bradbury Street | Ware Andrew W 30 Linda Vista Dr Monterey, CA 93940 | 594.74 | 10.00 | | 604.74 |
| 153611065000 | 1886 Bradbury Street | Kim Ock H & Chong S 1886 Bradbury St Salinas, CA 93906 | 594.74 | 10.00 | | 604.74 |
| 153611066000 | 1888 Bradbury Street | Colocho-ortiz Jose G 1888 Bradbury St Salinas, CA 93906 | 594.74 | 10.00 | | 604.74 |
| 153611067000 | 1890 Bradbury Street | Torres Martha O 1890 Bradbury St Salinas, CA 93906 | 594.74 | 10.00 | | 604.74 |
| 153611068000 | 1892 Bradbury Street | Esparza Enepamuceno & Maria S 1892 Bradbury St Salinas, CA 93906 | 594.74 | 10.00 | | 604.74 |
| 153611069000 | 1894 Bradbury Street | Zarate Gerardo & Ana C 1894 Bradbury St Salinas, CA 93906 | 594.74 | 10.00 | | 604.74 |
| 153611070000 | 1896 Bradbury Street | Linares Jose Ricardo 1896 Bradbury St Salinas, CA 93906 | 594.74 | 10.00 | | 604.74 |
| 153611071000 | 1898 Bradbury Street | Rea Jung S Tr | 594.74 | 10.00 | | 604.74 |

| Parcel..... | Situs Address..... | Owner Address..... | Assessment.... | City Fee.. | County Fee | Total Levy.... |
|--------------|--------------------|---|----------------|------------|------------|----------------|
| | | 1898 Bradbury St Salinas, CA 93906 | | | | |
| 153612015000 | 954 Fitzgerald St | Rosas Veronica 954 Fitzgerald St Salinas, CA 93906 | 594.74 | 10.00 | | 604.74 |
| 153612016000 | 956 Fitzgerald St | Valdez Veronica & Carolina Z 956 Fitzgerald St Salinas, CA 93906 | 594.74 | 10.00 | | 604.74 |
| 153612017000 | 958 Fitzgerald St | Sponsler Linda E 958 Fitzgerald St Salinas, CA 93906 | 594.74 | 10.00 | | 604.74 |
| 153612018000 | 960 Fitzgerald St | Alisea Jack D & Alisea Rebeca N 960 Fitzgerald St Salinas, CA 93906 | 594.74 | 10.00 | | 604.74 |
| 153612019000 | 962 Fitzgerald St | Powers Carl Ross & Dorothy Shut e 962 Fitzgerald St Salinas, CA 93906 | 594.74 | 10.00 | | 604.74 |
| 153612020000 | 964 Fitzgerald St | Zarate Juan 964 Fitzgerald St Salinas, CA 93906 | 594.74 | 10.00 | | 604.74 |
| 153612021000 | 966 Fitzgerald St | Raigosa Aida 966 Fitzgerald St Salinas, CA 93906 | 594.74 | 10.00 | | 604.74 |
| 153612022000 | 974 Fitzgerald St | Ongleo Mariepaz P 974 Fitzgerald St Salinas, CA 93906 | 594.74 | 10.00 | | 604.74 |
| 153612023000 | 976 Fitzgerald St | Crabb Dennise D 976 Fitzgerald St Salinas, CA 93906 | 594.74 | 10.00 | | 604.74 |
| 153612024000 | 978 Fitzgerald St | Wheeler Cameron 978 Fitzgerald St Salinas, CA 93906 | 594.74 | 10.00 | | 604.74 |
| 153612025000 | 980 Fitzgerald St | Rodriguez Odilon G & Patricia 980 Fitzgerald St Salinas, CA 93906 | 594.74 | 10.00 | | 604.74 |
| 153612026000 | 982 Fitzgerald St | Lao Yong & Chou Ming Chiann 4815 Sea Crest Dr Seaside, CA 93955 | 594.74 | 10.00 | | 604.74 |
| 153612027000 | 984 Fitzgerald St | Dixon Joshua S & Abbey K 984 Fitzgerald St Salinas, CA 93906 | 594.74 | 10.00 | | 604.74 |
| 153612028000 | 986 Fitzgerald St | Calderon-chocha Maria G & Ochoa Jorge 986 Fitzgerald Salinas, CA 93906 | 594.74 | 10.00 | | 604.74 |
| 153613001000 | 953 Fitzgerald St | Alvarez Dimas & Maria G 953 Fitzgerald St Salinas, CA 93906 | 594.74 | 10.00 | | 604.74 |
| 153613002000 | 955 Fitzgerald St | Cox Theresa 955 Fitzgerald Salinas, CA 93906 | 594.74 | 10.00 | | 604.74 |
| 153613003000 | 957 Fitzgerald St | Sandjong Bertrand Tankouo & Ngu efack Katy Kemeze | 594.74 | 10.00 | | 604.74 |

| Parcel..... | Situs Address..... | Owner Address..... | Assessment.... | City Fee.. | County Fee | Total Levy.... |
|--------------|----------------------|---|----------------|------------|------------|----------------|
| | | 957 Fitzgerald St Salinas, CA 93906 | | | | |
| 153613004000 | 959 Fitzgerald St | Su Bude & Zhou Yan 959 Fitzgerald St Salinas, CA 93906 | 594.74 | 10.00 | | 604.74 |
| 153613005000 | 961 Fitzgerald St | Heebner Karl L Jr 961 Fitzgerald St Salinas, CA 93906 | 594.74 | 10.00 | | 604.74 |
| 153613006000 | 963 Fitzgerald St | Amaro Donna S 963 Fitzgerald St Salinas, CA 93906 | 594.74 | 10.00 | | 604.74 |
| 153613007000 | 1817 Bradbury Street | Alfaro Linda 1817 Bradbury St Salinas, CA 93906 | 594.74 | 10.00 | | 604.74 |
| 153613008000 | 1819 Bradbury Street | Neri Roberto L 1819 Bradbury St Salinas, CA 93906 | 594.74 | 10.00 | | 604.74 |
| 153613009000 | 1821 Bradbury Street | Worthington David W & Linda A T r 1821 Bradbury St Salinas, CA 93906 | 594.74 | 10.00 | | 604.74 |
| 153613010000 | 1823 Bradbury Street | Castaneda Enrique 1823 Bradbury St Salinas, CA 93906 | 594.74 | 10.00 | | 604.74 |
| 153613011000 | 1825 Bradbury Street | Amatya Pradyumna & Jiang Ying 9735 Maul Oak Pl Salinas, CA 93907 | 594.74 | 10.00 | | 604.74 |
| 153613012000 | 1827 Bradbury Street | Mayne Mickey J & Joanne K 1827 Bradbury St Salinas, CA 93906 | 594.74 | 10.00 | | 604.74 |
| 153613013000 | 1829 Bradbury Street | Kim Kyung Ae 1829 Bradbury St Salinas, CA 93906 | 594.74 | 10.00 | | 604.74 |
| 153613014000 | 1831 Bradbury Street | Venegas Rebecca & Rodriguez Joh n 1831 Bradbury St Salinas, CA 93906 | 594.74 | 10.00 | | 604.74 |
| 153613015000 | 1833 Bradbury Street | Pena Daniel & Navarro Elizabeth 1833 Bradbury St Salinas, CA 93906 | 594.74 | 10.00 | | 604.74 |
| 153613016000 | 1835 Bradbury Street | Yoo Kyeongah 1835 Bradbury St Salinas, CA 93906 | 594.74 | 10.00 | | 604.74 |
| 153613017000 | 1837 Bradbury Street | Barajas Antonio C 1837 Bradbury St Salinas, CA 93906 | 594.74 | 10.00 | | 604.74 |
| 153613018000 | 1839 Bradbury Street | Ake Keith Denman 1839 Bradbury St Salinas, CA 93906 | 594.74 | 10.00 | | 604.74 |
| 153613019000 | 1841 Bradbury Street | Smith Tiffany Ryan 1841 Bradbury St Salinas, CA 93906 | 594.74 | 10.00 | | 604.74 |
| 153613020000 | 1843 Bradbury Street | Braun Mark P & Shawna L 3093 Everett Cir | 594.74 | 10.00 | | 604.74 |

CITY OF SALINAS
Assessment Roll by Parcel
District 2000-1 Mira Monte Maint. District

| Parcel..... | Situs Address..... | Owner Address..... | Assessment.... | City Fee.. | County Fee | Total Levy.... |
|--------------|----------------------|---|----------------|------------|------------|----------------|
| | | Marina, CA 93933 | | | | |
| 153613021000 | 1845 Bradbury Street | Zentner Victoria 1845 Bradbury St Salinas, CA 93906 | 594.74 | 10.00 | | 604.74 |
| 153613022000 | 1849 Bradbury Street | Kim Soondeuk 1849 Bradbury St Salinas, CA 93908 | 594.74 | 10.00 | | 604.74 |
| 153613023000 | 1851 Bradbury Street | Lopez Maria Natividad 1851 Bradbury St Salinas, CA 93906 | 594.74 | 10.00 | | 604.74 |
| 153613024000 | 1853 Bradbury Street | Mejia Karla N 1853 Bradbury St Salinas, CA 93906 | 594.74 | 10.00 | | 604.74 |
| 153613025000 | 1855 Bradbury Street | Duffina Terry & Maraccini Cary 1855 Bradbury St Salinas, CA 93906 | 594.74 | 10.00 | | 604.74 |
| 153613026000 | 1857 Bradbury Street | Orozco Lorena 1857 Bradbury St Salinas, CA 93906 | 594.74 | 10.00 | | 604.74 |
| 153613027000 | 1859 Bradbury Street | Romero Ruben & Gloria A Trs 13 Sepulveda Cir Salinas, CA 93906 | 594.74 | 10.00 | | 604.74 |
| 153613028000 | 1861 Bradbury Street | Ira Services Trust Co Cfbo Sze- ying Wu Ira075103 Po Box 7080 San Carlos, CA 94070 | 594.74 | 10.00 | | 604.74 |
| 153613029000 | 1865 Bradbury Street | Eusebio Melita Ruth 1865 Bradbury St Salinas, CA 93906 | 594.74 | 10.00 | | 604.74 |
| 153613030000 | 1867 Bradbury Street | Marin Irma 1867 Bradbury St Salinas, CA 93906 | 594.74 | 10.00 | | 604.74 |
| 153613031000 | 1869 Bradbury Street | Aromin Aida D 1925 Arcadia Ct Salinas, CA 93906 | 594.74 | 10.00 | | 604.74 |
| 153613032000 | 1875 Bradbury Street | Hyles James L & Betty 1875 Bradbury St Salinas, CA 93906 | 594.74 | 10.00 | | 604.74 |
| 153613033000 | 1879 Bradbury Street | Mc Cray Sheila M 1879 Bradbury St Salinas, CA 93906 | 594.74 | 10.00 | | 604.74 |
| 153613034000 | 1881 Bradbury Street | Barraza Irma I Et Al 1881 Bradbury St Salinas, CA 93906 | 594.74 | 10.00 | | 604.74 |
| 153613035000 | 1883 Bradbury Street | Ayozie Ikechukwu Canute & Lawre tta 1883 Bradbury St Salinas, CA 93906 | 594.74 | 10.00 | | 604.74 |
| 153613036000 | 1893 Bradbury Street | Sagun Elias & Cindy 1893 Bradbury St Salinas, CA 93906 | 594.74 | 10.00 | | 604.74 |

| | | | |
|------------|----------|-------|------------|
| ===== | ===== | ===== | ===== |
| 120,732.22 | 2,030.00 | 0.00 | 122,762.22 |

06-05-17
{AMD.ROLL}

CITY OF SALINAS
Assessment Roll by Parcel
District 2000-1 Mira Monte Maint. District

PAGE 13

| Parcel..... | Situs Address..... | Owner Address..... | Assessment.... | City Fee.. | County Fee | Total Levy.... |
|-------------|--------------------|--------------------|----------------|------------|------------|----------------|
|-------------|--------------------|--------------------|----------------|------------|------------|----------------|



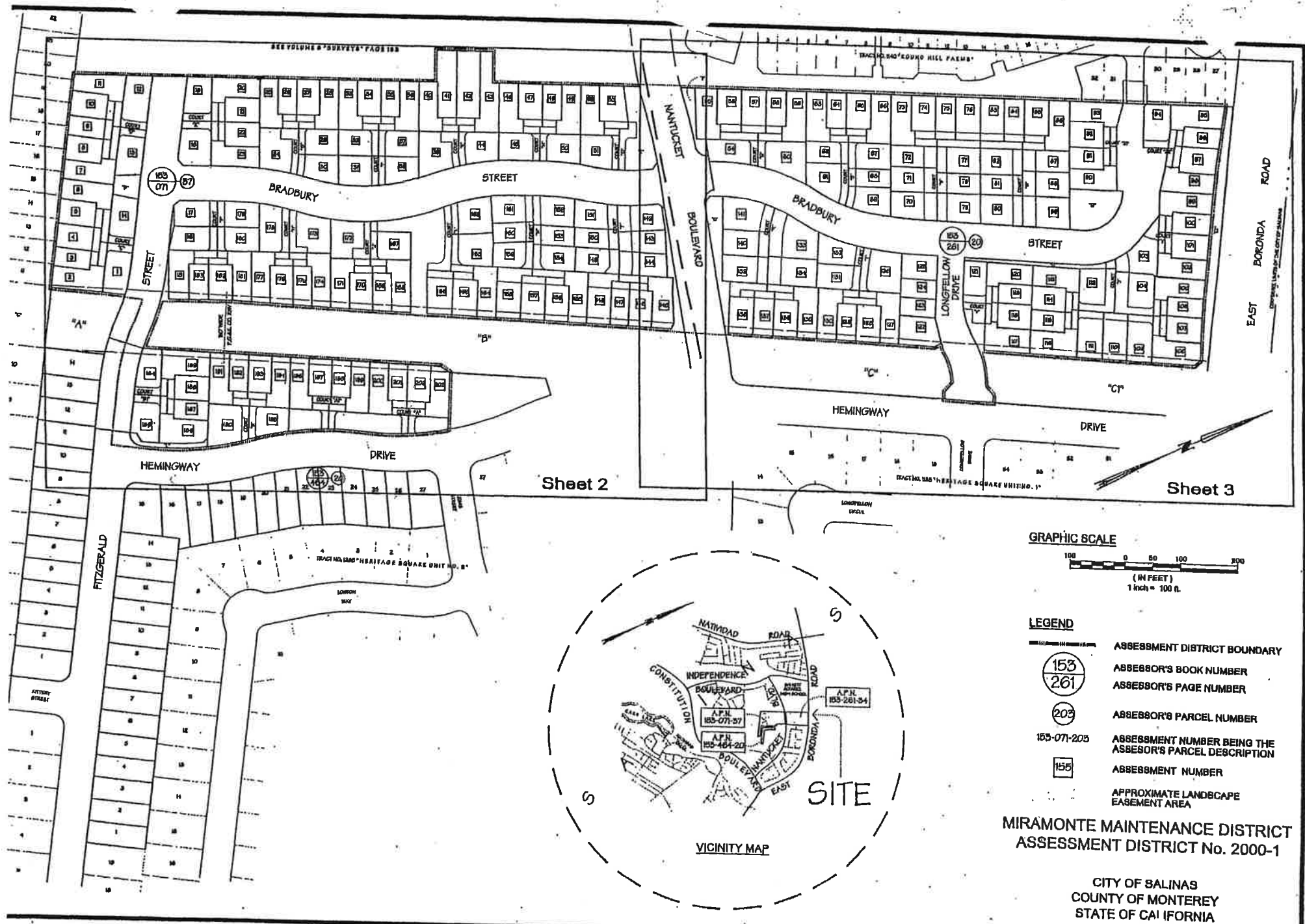

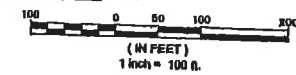

203 records listed.



GRAPHIC SCALE



LEGEND

-  ASSESSMENT DISTRICT BOUNDARY
-  ASSESSOR'S BOOK NUMBER
ASSESSOR'S PAGE NUMBER
-  ASSESSOR'S PARCEL NUMBER
-  ASSESSMENT NUMBER BEING THE
ASSESSOR'S PARCEL DESCRIPTION
-  ASSESSMENT NUMBER
-  APPROXIMATE LANDSCAPE
EASEMENT AREA

**MIRAMONTE MAINTENANCE DISTRICT
ASSESSMENT DISTRICT No. 2000-1**

**CITY OF SALINAS
COUNTY OF MONTEREY
STATE OF CALIFORNIA**

EAST BORONDA ROAD

COTTAGES AT MIRAMONTE

PHASE ONE

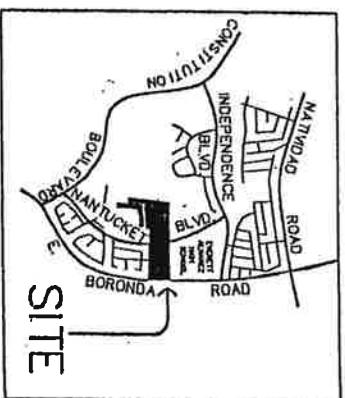
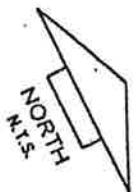

VICINITY MAP

