

PHASE DIAGRAM

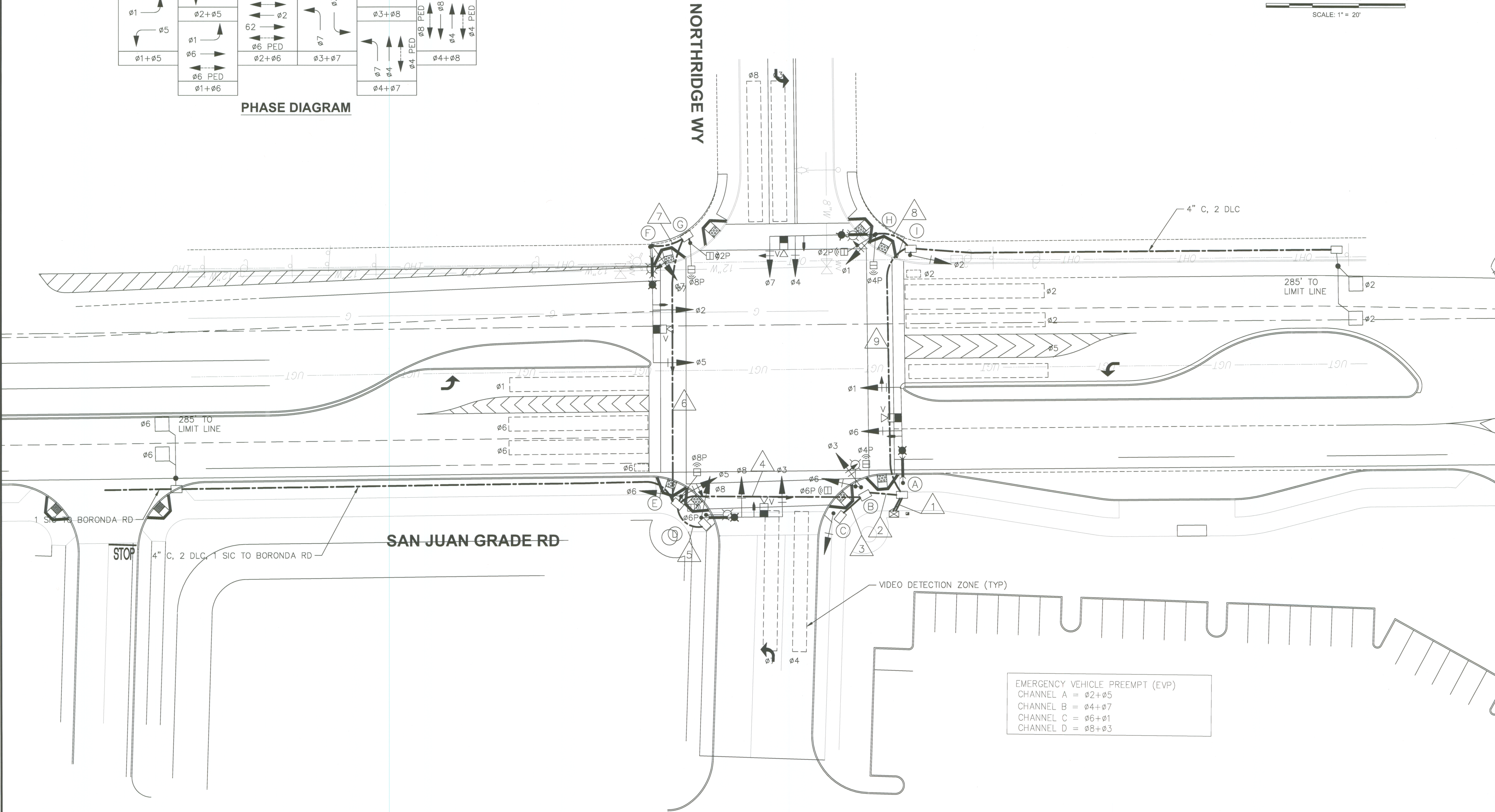

EMERGENCY VEHICLE PREEMPT (EVP)
 CHANNEL A = ø2+ø5
 CHANNEL B = ø4+ø7
 CHANNEL C = ø6+ø1
 CHANNEL D = ø8+ø3

SHEET OS 7.1 OF SHITS	TRAFFIC SIGNAL INSTALLATION NORTHBRIDGE WAY AND SAN JUAN GRADE RD. LOW'S HW, INC-CLOVER FIELD RETAIL CENTER SALINAS MONTEREY CALIFORNIA				DATE: 09-19-16 SCALE: $\frac{1}{4}$ " = 1'-0" DESIGNED: $\frac{1}{4}$ " = 1'-0" DRAWN: $\frac{1}{4}$ " = 1'-0" CHECKED: $\frac{1}{4}$ " = 1'-0" PROJ. MGR: $\frac{1}{4}$ " = 1'-0"	DESCRIPTION
	PROJECT 06-1975	ams 801 YGNACIO VALLEY ROAD SUITE 220 WALNUT CREEK, CA 94596 925-943-2777 FAX 925-943-2778 associates, inc. PLANNING ENGINEERING SURVEYING				

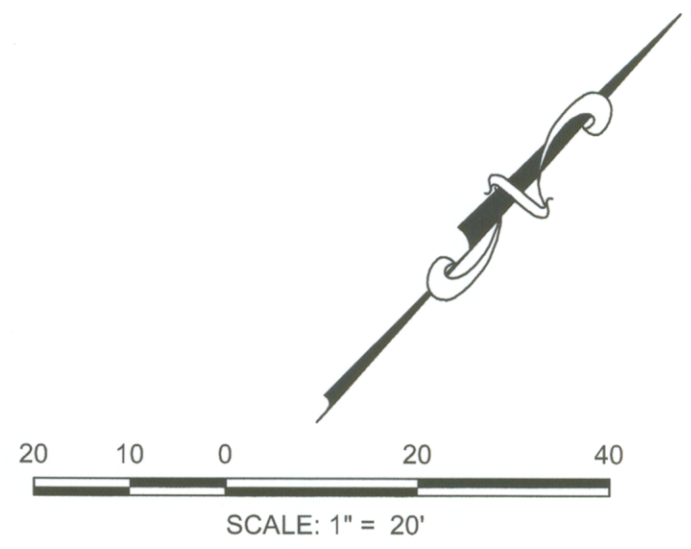
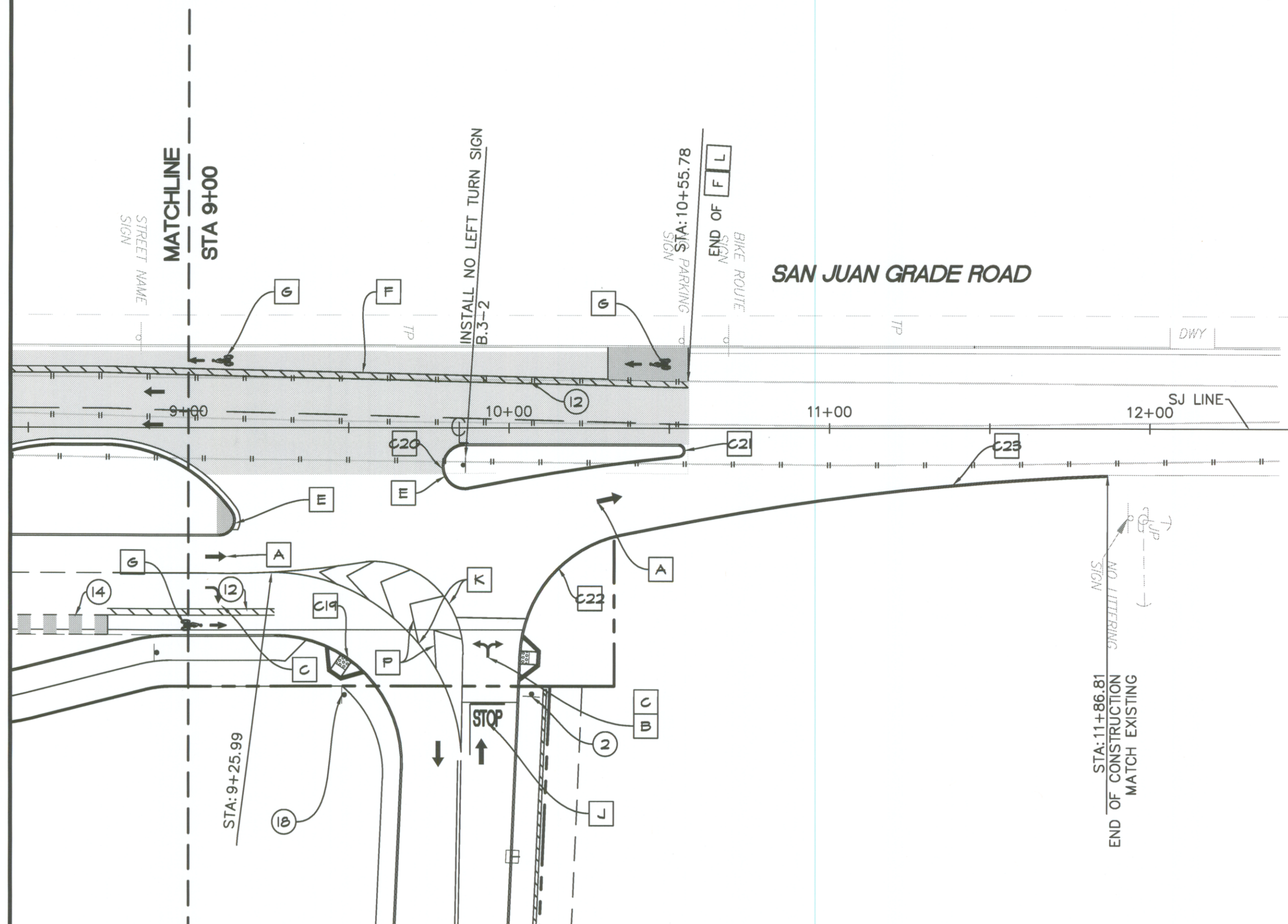
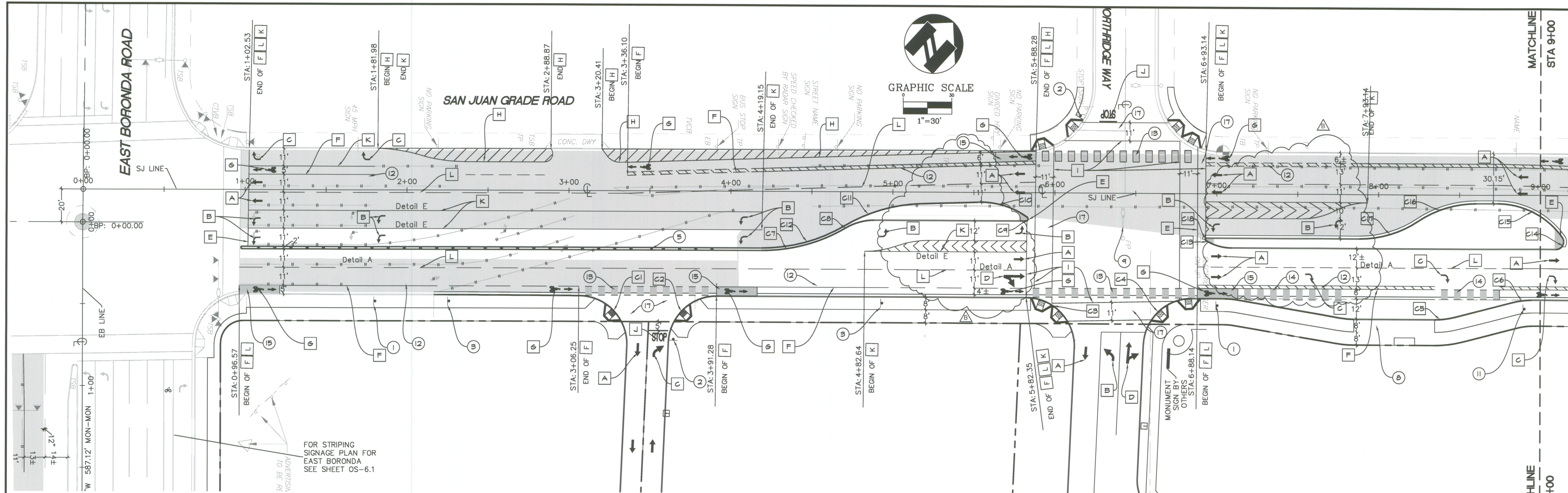

LEGEND

- SANDBLAST AND REMOVE THE EXISTING STRIPES.
- EXISTING SIGN
- NEW SIGN
- SAND BLAST AND REMOVE THE EXISTING DIRECTIONAL ARROW
- GREEN COLORED BIKE LANE
- SLURRY SEAL AREA

CURVES DATA TABLE			
CURVE	DELTA	LENGTH	RADIUS
C1	92°28'28"	48.41'	30.00'
C2	87°31'32"	45.82'	30.00'
C3	92°28'28"	48.41'	30.00'
C4	87°31'32"	45.82'	30.00'
C5	14°9'13"	12.35'	50.00'
C6	14°9'13"	12.35'	50.00'
C7	30°34'10"	54.42'	102'
C8	30°26'12"	18.59'	35'
C9	144°46'28"	3.79'	1.5'
C10	37°2'31"	32.32'	50.00'
C11	28°45'12"	50.18'	100.00'
C12	30°34'10"	53.35'	100.00'
C13	32°30'32"	17.02'	30.00'
C14	126°0'32"	10.99'	5.00'
C15	53°59'28"	47.11'	50.00'
C16	24°12'01"	37.32'	88.36'
C17	26°23'40"	30.50'	66.21'
C18	147°29'28"	13.50'	1'
C19	92°28'28"	64.56'	40.00'
C20	190°57'0"	23.33'	7.00'
C21	173°47'23"	6.06'	2.00'
C22	75°38'48"	52.81'	40.00'
C23	190°57'0"	153.23'	880.93'
C24	173°47'23"	6.06'	2.00'

KEY NOTES:

- [A] STRAIGHT ARROW (PER CITY OF SALINAS STD. & SPEC.) SEE STD. PLAN #40.
- [B] LEFT TURN ARROW (PER CITY OF SALINAS STD. & SPEC.) SEE STD. PLAN #40.
- [C] RIGHT TURN ARROW (PER CITY OF SALINAS STD. & SPEC.) SEE STD. PLAN #40.
- [D] STRAIGHT AND LEFT/ RIGHT TURN ARROW (PER CITY OF SALINAS STD. & SPEC.) SEE STD. PLAN #40.
- [E] INSTALL MEDIAN ISLAND DETAILS (PER CITY OF SALINAS STD. & SPEC.) SEE STD. PLAN #14 (THIS INCLUDES SIGNS).
- [F] BIKE LANE STRIPE (PER CITY OF SALINAS STD. & SPEC) SEE DETAIL 41.
- [G] "BIKE LANE" LEGEND (PER CITY OF SALINAS STD. & SPEC) SEE STD. PLAN #41.
- [H] INSTALL DETAIL G (PER CITY OF SALINAS STD. & SPEC.). SEE STD. PLAN #37A.
- [I] 12" SOLID WHITE STRIPE (PER CITY OF SALINAS STD. & SPEC.). SEE STD. PLAN #44.
- [J] STOP LEGEND ON PAVEMENT (PER CITY OF SALINAS STD. & SPEC.). SEE STD. PLAN #43.
- [K] INSTALL DETAIL E (PER CITY OF SALINAS STD. & SPEC.). SEE STD. PLAN #37A.
- [L] INSTALL DETAIL A (PER CITY OF SALINAS STD. & SPEC.). SEE STD. PLAN #37A.
- [M] INSTALL DETAIL L (PER CITY OF SALINAS STD. & SPEC.). SEE STD. PLAN #37A.
- [N] INSTALL RIGHT LANE MERGE ARROW (PER CITY OF SALINAS STD. & SPEC.) SEE STD. PLAN #40.
- [O] 4" YELLOW STRIPES (45')
- [P] 8" WHITE STRIPES (45')
- ① INSTALL SPEED LIMIT SIGN 45 MPH (R 2-1).
- ② INSTALL "STOP" SIGN (R 1-1).
- ③ INSTALL "NO PARKING ANYTIME" SIGN (R 26).
- ④ RELOCATE THE EXISTING SIGN.
- ⑤ INSTALL "ONE WAY" (R 6-2).
- ⑥ INSTALL "DO NOT ENTER" SIGN (R 5-1).
- ⑦ INSTALL NEW TRAFFIC SIGNAL (SEE TRAFFIC SIGNAL PLAN).
- ⑧ INSTALL BUS STOP SIGN, BUS SHELTER AND BENCH PER MONTEREY -SALINAS TRANSIT (MST) DESIGNING FOR TRANSIT MANUAL DATED NOVEMBER 2006.
- ⑨ RELOCATE THE EXISTING STREET LIGHT.
- ⑩ REMOVE THE EXISTING SIGNAL LIGHT, FOOTING AND PULL BOXES.
- ⑪ INSTALL "RIGHT LANE MUST TURN RIGHT" SIGN (R3-7).
- ⑫ INSTALL BUFFERED BIKE LANE, 2' MIN.
- ⑬ INSTALL BIKE LANE STRIPE AT INTERSECTIONS WITH GREEN COLOR STRIPES.
- ⑭ INSTALL DASHED PATTERN WITH GREEN COLOR BIKE LANE INDICATE MERGING AREAS.
- ⑮ INSTALL 25' GREEN COLOR MARKING AT BEGINNING OF BIKE LANES.
- ⑯ REMOVE THE EXISTING BUS STOP SIGN BENCH.
- ⑰ TRIPLE 4 CROSSWALK SEE DETAIL 11 SHEET OS-3.2
- ⑱ INSTALL "SIDEWALK CLOSED" SIGN (R9-9).

- GENERAL NOTES:
1. ALL STRIPING & SIGNAGE SHALL BE PER CITY OF SALINAS AND 2014 MUTCD.
 2. ALL STRIPES AND LEGENDS SHALL BE THERMOPLASTIC EXCEPT THE STRIPING ON EAST OF THE INTERSECTION OF E. BORONDA RD. AND DARTMOUTH RD.
 3. LOCATIONS OF SIGNAGE ARE SHOWN ON THESE PLANS SHALL BE APPROVED BY THE CITY ENGINEER PRIOR TO INSTALLATION.
 4. LOCATION OF STREET LIGHTS ARE APPROXIMATE. CONTRACTOR TO REVIEW STREET LIGHTING PLANS PRIOR TO CONSTRUCTION.
 5. FOR INSTALLATION OF TRAFFIC SIGNALS SEE SIGNAL PLANS.
 6. FOR INSTALLATION OF STREET LIGHTS SEE STREET LIGHTING PLANS.
 7. INSTALL FIRE MARKERS ON ALL FIRE HYDRANTS PER CITY OF SALINAS STANDARD & SPECIFICATIONS

PROJECT
06-1975

OS-6.2
OF
PROJECT

SHEET

STRIPING AND SIGNAGE PLAN-SAN JUAN GRADE ROAD
OFFSITE IMPROVEMENT PLANS FOR

NEC EAST BORONDA ROAD & SAN JUAN GRAD ROAD
SALINAS
MONTEREY
CALIFORNIA

ams
ASSOCIATES, inc.

801 YGNACIO VALLEY ROAD
SUITE 220
WALNUT CREEK, CA 94596
925-943-2777 FAX 925-943-2778

REGISTERED PROFESSIONAL ENGINEER
CITY OF CALIFORNIA
No. 33140
Exp. 06-30-2015

DATE: 09-19-16
SCALE: 1"=30'
DESIGNED: AS
DRAWN: FG
CHECKED: AS
APPROVED: AS

REV #
DATE
DESCRIPTION

08-29-16
09-19-16
PLAN CHECK COMMENTS
PLAN CHECK COMMENTS

FILE PATH: Y:\06-1975\ATEST DATE DIRECTORY\OFF-SITE\09-18-15\1975STRIPPING.DWG

DATE: 09-19-16
SCALE: 1"=30'
DESIGNED: AS
DRAWN: FG
CHECKED: AS
APPROVED: AS

REV #
DATE
DESCRIPTION

08-29-16
09-19-16
PLAN CHECK COMMENTS
PLAN CHECK COMMENTS